

CERTIFICATE OF LOCATION OF GOVERNMENT CORNER

North Quarter _____ Corner of Section 12, Township 114N, Range 40W, 5th P.M.

STATE OF MINNESOTA, County of Yellow Medicine

At the corner location shown on the sketch:

- On Nov. 1, 1972 found a 1½ inch round wood stake laying on its side
DATE
- left monument as found, lowered monument, removed monument (explain)
- On Nov. 3, 1972 placed a Minnesota Highway Department Cast Iron Monument
DATE
 (down 0.5 feet)

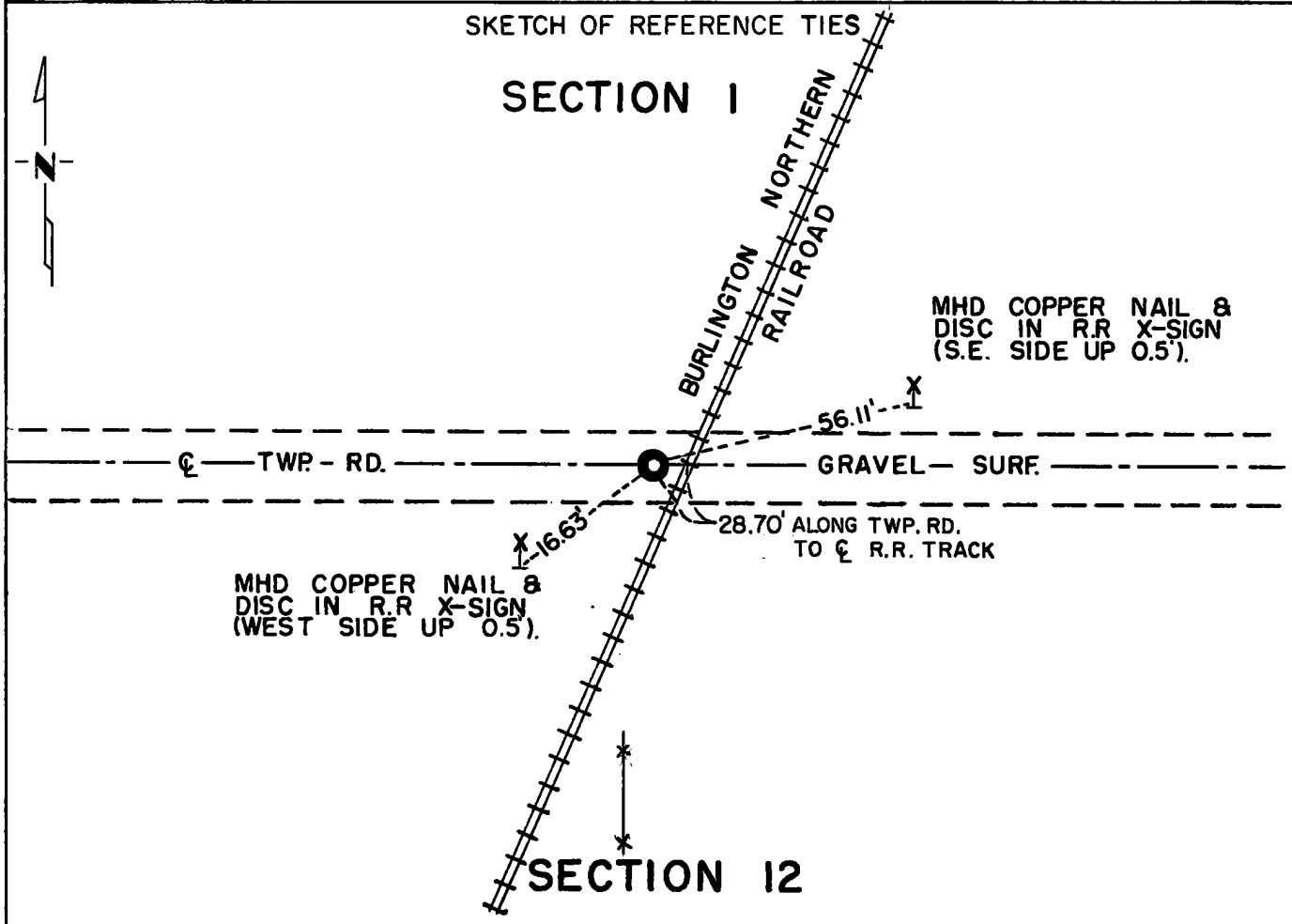

Statement of evidence relative to this corner location is on back of page.

I hereby certify that this document and the data contained herein was prepared by me or under my direct supervision.

Jesse E. Faust 12/4/73
SIGNATURE DATE

Registration No. 3230
 Land Surveyor, Professional Engineer
 County Surveyor, County Engineer

OFFICE OF THE REGISTER OF DEEDS
 County of Yellow Medicine

I hereby certify that this document was filed in the Reg. of Deeds office at 11:35 A.M. on the 11 day of January A.D., 1974

Register of Deeds Norman J. Opdahl
 By Kay Nordahl, Deputy
 DOCUMENT NO. 162744

Statement of Evidence: NORTH QUARTER CORNER SECTION 12, T114N, R40W

The original Public Land Survey was run in 1858 and a wood post was set in a mound with the pits to mark the corner.

In 1874 Ole Quam found the original post.

On November 1, 1972, the Minnesota Highway Department found a 1½" round wood stake lying on its side on centerline of East-West road and 2' East of fence line south.

On November 3, 1972, the Minnesota Highway Department placed a cast iron monument at the location of the wood stake.

An analysis of the record data compared to the 1972 field measurements indicates that the 1½" round wood stake is in the accepted location of the Public Land Survey corner.

For details of survey analysis, photographs taken during excavation, and 1972 electronic survey measurements, see Survey Report for S.P. 4203 and 8701 on file in the Surveys Section, Minnesota Highway Department, Willmar, Minnesota.