

CERTIFICATE OF LOCATION OF GOVERNMENT CORNER

East Quarter _____ Corner of Section 34, Township 114N, Range 40W, 5th P.M.

STATE OF MINNESOTA, County of Yellow Medicine

At the corner location shown on the sketch:

- On Oct. 18, 1971 found a 6" x 6" x 8" Field stone (down 2.0 feet)
DATE
- left monument as found, lowered monument, removed monument (explain)
- On Aug. 28, 1972 placed a Minnesota Highway Department cast iron monument
DATE
over stone (down 0.3 feet)

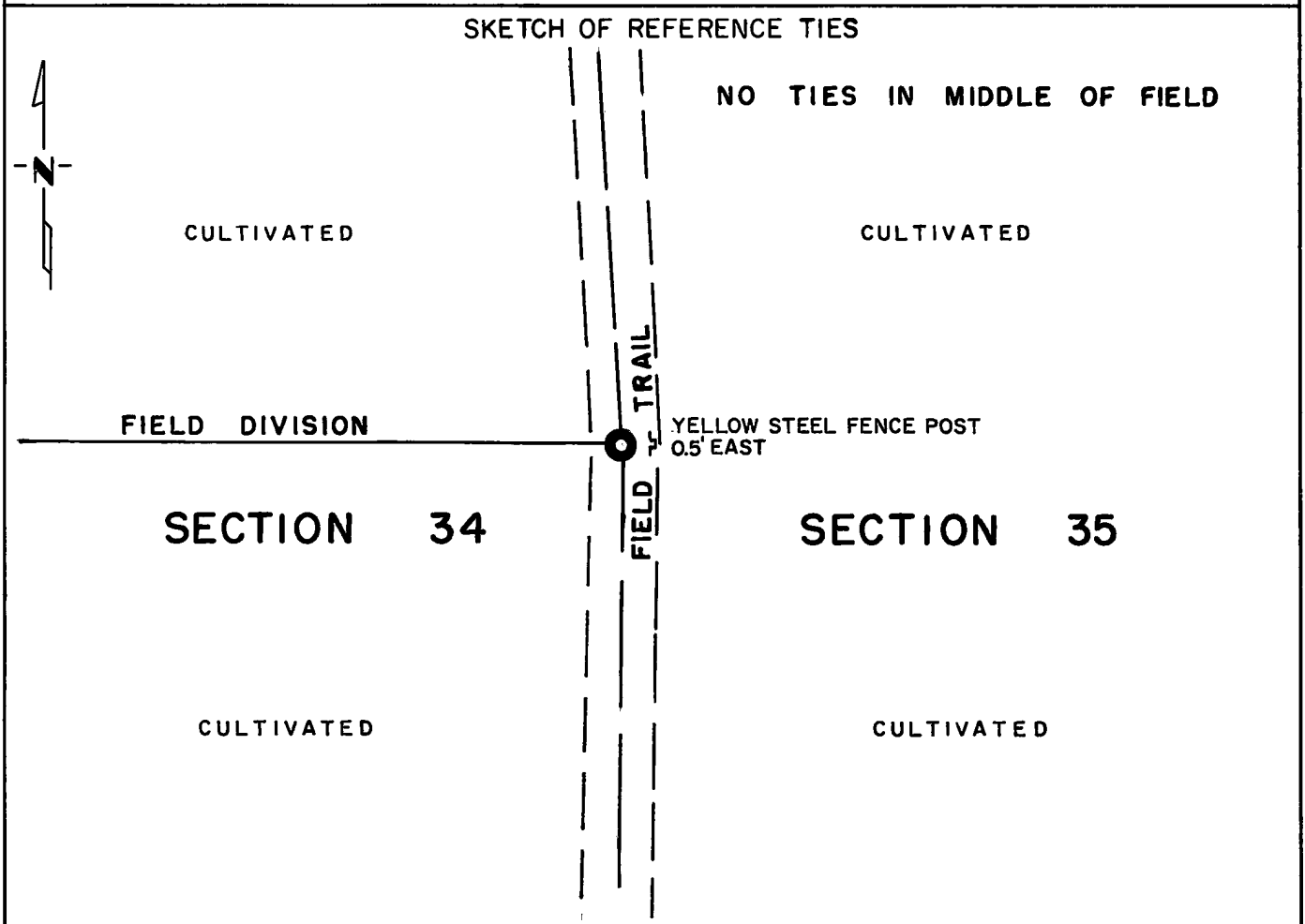

Statement of evidence relative to this corner location is on back of page.

I hereby certify that this document and the data contained herein was prepared by me or under my direct supervision.

Jesse E. Fant 12/4/73
SIGNATURE DATE

Registration No. 3230
 Land Surveyor, Professional Engineer
 County Surveyor, County Engineer

OFFICE OF THE REGISTER OF DEEDS
 County of Yellow Medicine

I hereby certify that this document was filed in the Reg. of Deeds office at 11:55 A.M. on the 11 day of January A.D., 19 74

Register of Deeds Norman J. Opdahl
 By Kay Merdahl, Deputy
 DOCUMENT NO. 162748

Statement of Evidence: EAST QUARTER CORNER SECTION 34, T114N, R40W

The original Public Land Survey was run in 1864 and a wood post was set in a mound with pits to mark the corner.

In 1916 John Norgaard, County Surveyor, found a stone that he had set when the original mound was still visible.

On October 18, 1971, the Minnesota Highway Department excavated and found a 6" x 6" x 8" field stone down 2' at the centerline of field road north-south and on field division west.

An analysis of the record data dating to original corner, and interviews with area Farmers, Lester Arnesen and Lowell Helle, provides a continuous chain of perpetuation of the original Public Land Survey corner.

For details of survey analysis, photographs taken during excavation, and 1972 electronic survey measurements, see Survey Report for S.P. 4203 and 8701 on file in the Surveys Section, Minnesota Highway Department, Willmar, Minnesota.