

CERTIFICATE OF LOCATION OF GOVERNMENT CORNER

North Quarter Corner of Section 4, Township 115N, Range 39W, 5th P.M.
STATE OF MINNESOTA, County of Yellow Medicine

At the corner location shown on the sketch:

- On Oct. 12, 1974 found a Minnesota Highway Department cast iron monument at
DATE
ground surface
- left monument as found, lowered monument, removed monument (explain)
- On _____ placed a _____
DATE

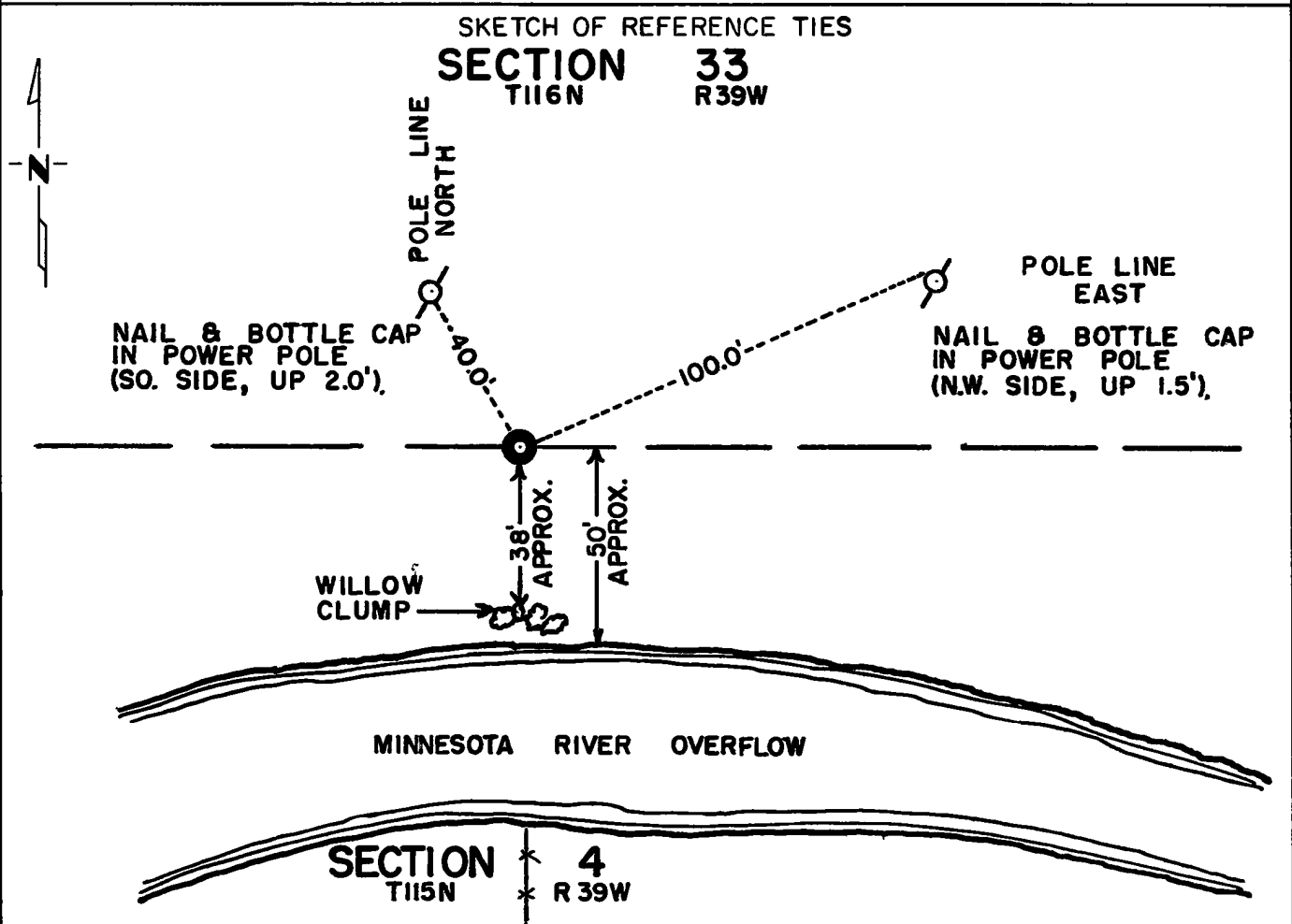

Statement of evidence relative to this corner location is on back of page.

I hereby certify that this document and the data contained herein was prepared by me or under my direct supervision.

Jesse E. Fant 4/3/74
SIGNATURE DATE

Registration No. 3230

- Land Surveyor, Professional Engineer
- County Surveyor, County Engineer

OFFICE OF THE REGISTER OF DEEDS
County of Yellow Medicine

I hereby certify that this document was filed in the Reg. of Deeds office at 2:30 P.M. on the 19 day of April A.D., 19 74

Register of Deeds Norman J. Opdahl

By Kay Nerdahl, Deputy

DOCUMENT NO. 163236

Statement of Evidence: NORTH QUARTER CORNER SECTION 4, T115N, R39W, 5TH P.M.

The original Public Land Survey corner was set in 1858 by W. J. Neely. A wood post was set in a dirt mound with pits and coal was deposited under the post to mark the corner.

In 1909, John Norgaard, County Surveyor, found a stone at a fence corner which was located according to the platting of an addition to the City of Granite Falls.

In 1968, Arbie E. Nelson set a cast iron monument according to the plat of the City of Granite Falls.

An analysis of the record data as compared to the 1973 field measurements to block corners in Pillsbury's Second Addition to Granite Falls shows that the cast iron monument is in agreement with past surveys and is accepted as the location of the Public Land Survey corner.

For details of survey analysis and 1973 electronic survey measurements, see Survey Report for S.P. 8701-18 from 0.3 miles North of the Yellow Medicine River to Granite Falls on file in the Surveys Section, Minnesota Highway Department, Willmar, Minnesota.