

CERTIFICATE OF LOCATION OF GOVERNMENT CORNER

North Quarter _____ Corner of Section 10, Township 115N, Range 39W, 5th P.M.

STATE OF MINNESOTA, County of Yellow Medicine

At the corner location shown on the sketch:

On Mar. 16, 1973 found a Minnesota Highway Department cast iron monument projecting about 4 inches above the ground

left monument as found, lowered monument, removed monument (explain)

On _____ placed a _____

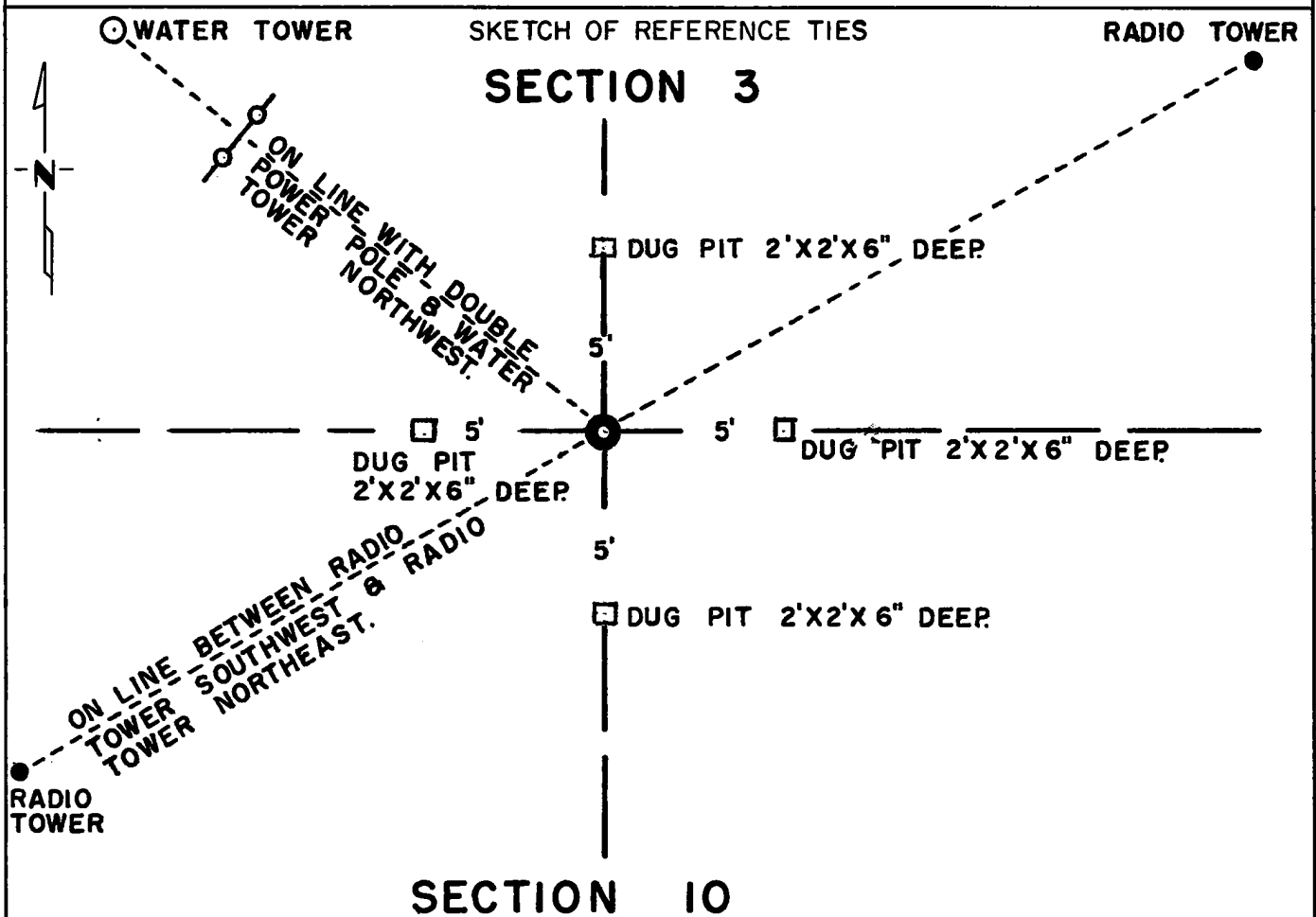

Statement of evidence relative to this corner location is on back of page.

I hereby certify that this document and the data contained herein was prepared by me or under my direct supervision.

Jesse E. Fant 4/9/74
SIGNATURE DATE

Registration No. 3230

Land Surveyor, Professional Engineer

County Surveyor, County Engineer

OFFICE OF THE REGISTER OF DEEDS
County of Yellow Medicine

I hereby certify that this document was filed in the Reg. of Deeds office at 2:55 P.M. on the 19 day of April A.D., 1974

Register of Deeds Norman J. Optahl

By Kay Nerdahl, Deputy

DOCUMENT NO. 163241

Statement of Evidence: NORTH QUARTER CORNER SECTION 10, T115N, R39W, 5TH P.M.

The original Public Land Survey was completed in 1864 by Charles E. Davis and J. W. Webb Jr. A wood post was set in a monument of rocks with pits to mark the corner.

Jonah Peterman, County Surveyor, shows on a survey in Dec. 1883 that the quarter post had probably been destroyed. He did not need this corner for that particular survey and he did not need this corner for that particular survey and he apparently did not set any kind of monument for the corner.

The Minnesota Highway Department cast iron monument was placed in 1968 by Arbie E. Nelson, a private Land Surveyor, at a point equi-distant between section corners.

Said cast iron monument is within 0.3 feet of being equi-distant between section corners and within 3.5 feet of being on line between section corners. There are no occupation lines that can be seen from the cast iron monument.

This close agreement of the cast iron monument's position compared to the lost location provides an acceptable location for the quarter-corner.

For 1973 electronic survey measurements, see Survey Report for S.P. 8701-18 from 0.3 miles North of the Yellow Medicine River to Granite Falls on file in the Surveys Section, Minnesota Highway Department, Willmar, Minnesota.