

# CERTIFICATE OF LOCATION OF GOVERNMENT CORNER

Northeast Corner of Section 7, Township 115N, Range 40W, 5th P.M.

STATE OF MINNESOTA, County of Yellow Medicine

At the corner location shown on the sketch:

- On May 22, 1974 found a  $\frac{1}{2}$  inch iron rod down 5.5 feet from road surface on centerline North-South township road and 1.0 foot North centerline T.H. 67.  
DATE
- left monument as found,  lowered monument,  removed monument (explain)
- On July 19, 1974 placed a Minnesota Highway Department cast iron monument with a  $\frac{3}{4}$  inch iron pin under it (cast iron down  $\frac{1}{2}$  inch).  
DATE

SKETCH OF REFERENCE TIES

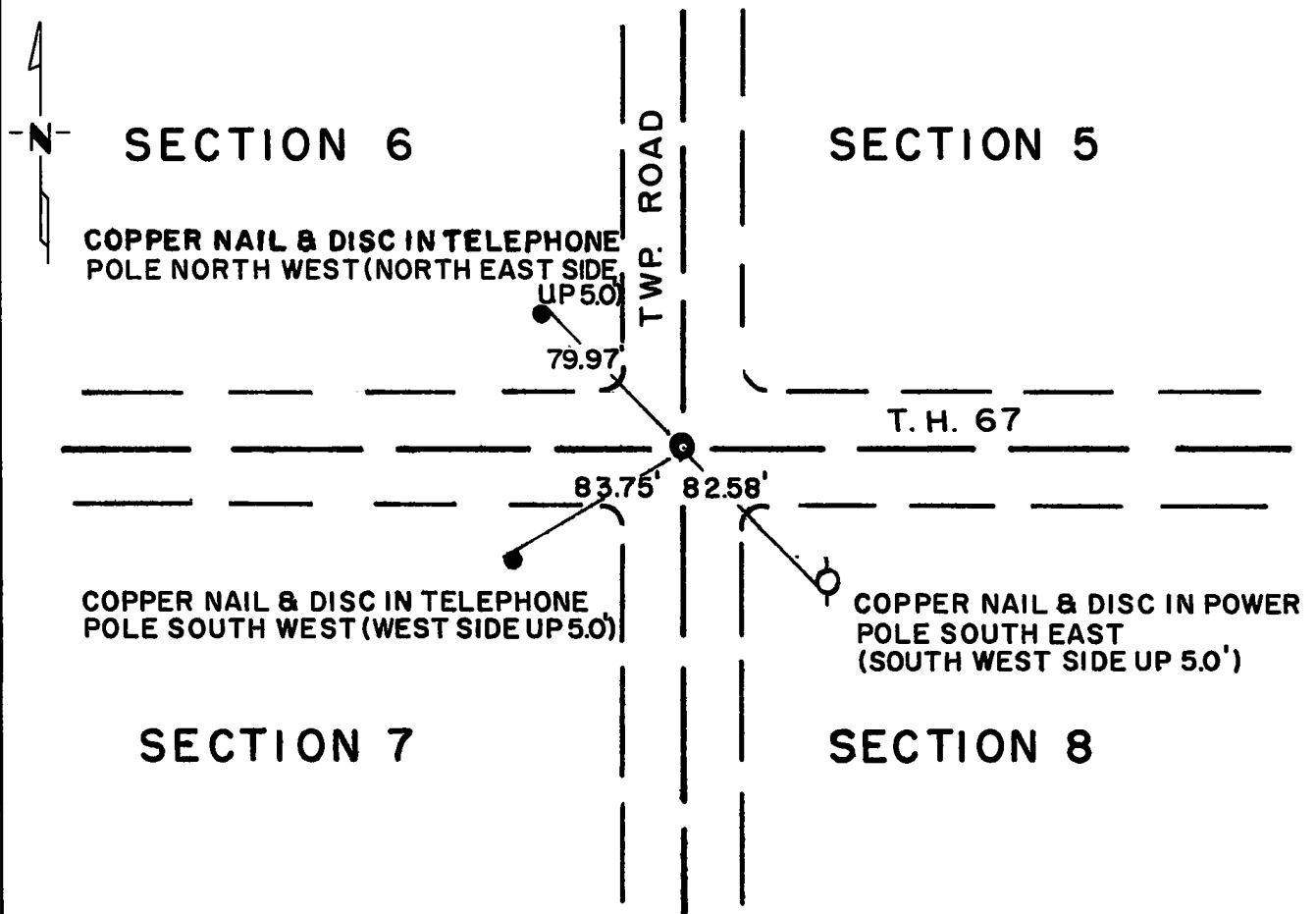

Statement of evidence relative to this corner location is on back of page.

I hereby certify that this document and the data contained herein was prepared by me or under my direct supervision.

Goodwin R. Heindorf 9-23-74  
SIGNATURE DATE

Registration No. 5761

- Land Surveyor,  Professional Engineer
- County Surveyor,  County Engineer

OFFICE OF THE REGISTER OF DEEDS  
County of Yellow Medicine

I hereby certify that this document was filed in the Reg. of Deeds office at 2:00 P.M. on the 24 day of SEPTEMBER A.D., 19 74

Register of Deeds Norman J. Opdahl

By Kay Nordahl, Deputy

DOCUMENT NO. 163996

Statement of Evidence: NORTHEAST CORNER SECTION 7, T115N, R40W

In 1895 and 1901 John E. Norgaard found a stone in place. In 1901 he replaced the stone with a 6 inch x 6 inch x 24 inch jasper monument.

Prior to 1956 the Minnesota Highway Department right of way map shows a  $\frac{1}{2}$  inch iron rod in place.

On May 22, 1974 the Minnesota Highway Department found the  $\frac{1}{2}$  inch iron rod on centerline of North-South road and 1.0 foot North of centerline of East-West highway (T.H. 67).

I could not determine who replaced the jasper monument with the  $\frac{1}{2}$  inch iron rod.

On July 19, 1974 the Minnesota Highway Department placed a cast iron monument with  $\frac{3}{4}$  inch iron pin below it to mark the corner.