

# CERTIFICATE OF LOCATION OF GOVERNMENT CORNER

Reference Mark  
on the East Line \_\_\_\_\_ of Section 4, Township 115N, Range 39W, 5th P.M.

STATE OF MINNESOTA, County of Yellow Medicine

At the corner location shown on the sketch:

- On Mar. 23, 1976 found nothing in place to mark the position of the  
DATE  
section line.
- left monument as found,  lowered monument,  removed monument (explain)
- On Mar. 25, 1976 placed a 3/4" x 24" iron pin with brass disc stamped  
DATE  
R.M. E. Line Sec. 4

## SKETCH OF REFERENCE TIES

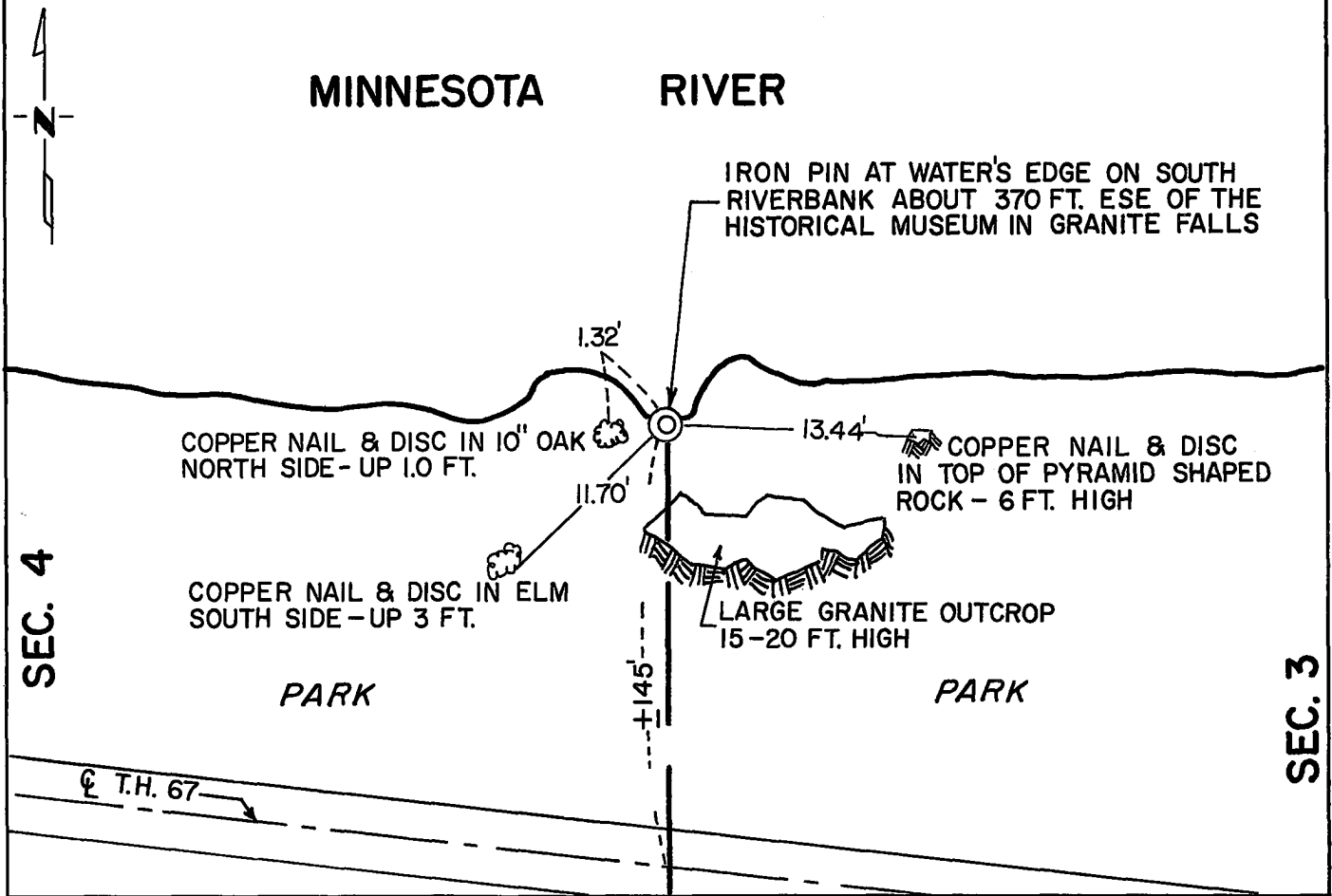

Statement of evidence relative to this corner location is on back of page.

I hereby certify that this document and the data contained herein was prepared by me or under my direct supervision.

Robert C. Jones 4/6/1976  
SIGNATURE DATE

Registration No. 11864

- Land Surveyor,  Professional Engineer
- County Surveyor,  County Engineer

OFFICE OF THE REGISTER OF DEEDS  
County of Yellow Medicine

RECORDED  
GRANTORY  
GRANTEE  
INDEXED

I hereby certify that this document was filed in the Reg. of Deeds office at 9:25 A.M. on the 19 day of APRIL A.D., 19 76

Register of Deeds Norman J. Opdahl

By Ray Nordahl, Deputy

DOCUMENT NO. 166808

Statement of Evidence: Reference Mark on the east line of Sec. 4, T115N, R39W.

1864 - The original Public Land Survey was completed by Charles E. Davis. A wood post was set to mark the meander corner and was referenced to two bearing trees, both cedar, southeast and southwest.

There is no record evidence that anything has been set to mark the meander corner since the original Public Land Survey.

1973 - A Minnesota Highway Department survey crew searched for the meander corner but found nothing. The southeast corner of Section 4 was found and the East Quarter corner of Section 4 was established according to a survey done by John Norgaard in 1911.

1976 - A Minnesota Highway Department survey crew set a 3/4" x 24" iron pin on the east line of Section 4. This line was established as the northerly projection of the line between the southeast corner of the section and the east quarter corner. The iron pin is not meant to mark the position of the original meander corner; it is only meant to mark the line between Sections 3 and 4. When the original government notes are used to calculate a position for the meander corner, it would fall in the middle of the Minnesota River.

For details of survey analysis and 1974 electronic measurements see survey report for S.P. 8701-18 from 0.3 miles North of the Yellow Medicine River to Granite Falls on file in the Surveys Section, Minnesota Highway Department, Willmar, Minn. 56201.