

CERTIFICATE OF LOCATION OF GOVERNMENT CORNER

Northeast Corner of Section 2, Township 115N, Range 40W, 5th P.M.

STATE OF MINNESOTA, County of Yellow Medicine

At the corner location shown on the sketch:

- On Apr. 28, 1976 found a 6"x6"x24" concrete monument 18" below the road surface.
DATE
- left monument as found, lowered monument, removed monument (explain)
- On Apr. 28, 1976 placed a Minnesota Highway Department cast iron monument stamped N.E. Cor. Sec. 2, T115N, R40W.
DATE

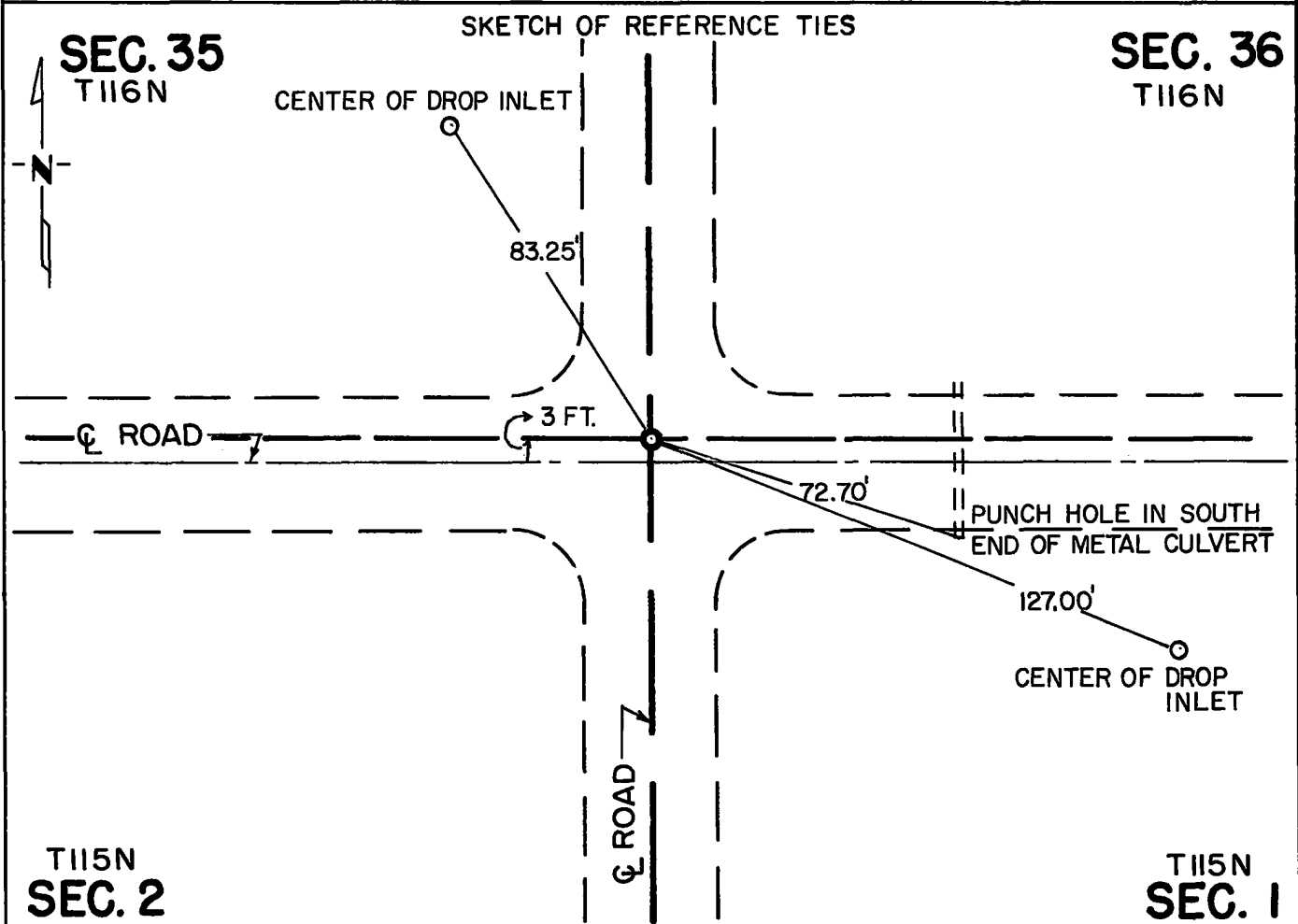

Statement of evidence relative to this corner location is on back of page.

I hereby certify that this document and the data contained herein was prepared by me or under my direct supervision.

Robert C Jones 5/4/76
SIGNATURE DATE

Registration No. 11864

- Land Surveyor, Professional Engineer
- County Surveyor, County Engineer

OFFICE OF THE REGISTER OF DEEDS
 County of Yellow Medicine

I hereby certify that this document was filed in the Reg. of Deeds office at 9:30 A.M. on the 27 day of MAY A.D., 19 76

Register of Deeds Norman J. Opdahl

By Kay Nordmark, Deputy

DOCUMENT NO. 167059



Statement of Evidence: Northeast Cor. Sec. 2, T115N, R40W

- 1858 - The original Public Land Survey of township line was completed by W. J. Neeley. A wood post was set and coal was deposited in a mound of dirt with trenches and pits to mark the corner.
- 1901 - John Norgaard, the County Surveyor, found a stone in the government mound and set a 6"x6"x24" granite monument in the mound to mark the corner. He used this monument on subsequent surveys in 1913 and 1915.
- 1937 - The County Engineer replaced the granite monument with a 6"x6"x24" concrete monument.
- 1976 - A Minnesota Highway Department survey crew excavated a hole 4'x4'x 3½' deep. A 6"x6"x24" concrete monument was found 18" below the present road surface. There was nothing under the concrete monument. A Minnesota Highway Department cast iron monument stamped N.E. Cor. Sec. 2, T115N, R40W was placed over the concrete monument and about 3" below the road surface.

An analysis of this data provides a continuous chain of record perpetuating the location of the original Public Land Survey Corner.

For details of survey analysis and 1976 electronic measurements, see the survey report for S.P. 8702 and S.P. 8706, Jct. T.H. 23 and T.H. 67, 3 miles S.W. of Granite Falls, on file with the Surveys Section, Minnesota Highway Department, Willmar, Minn. 56201.