

CERTIFICATE OF LOCATION OF GOVERNMENT CORNER

Northeast Corner of Section 8, Township 115N, Range 44W, 5th P.M.

STATE OF MINNESOTA, County of Yellow Medicine

At the corner location shown on the sketch:

- On _____ found a _____
DATE
- left monument as found, lowered monument, removed monument (explain)
- On 12/16/76 placed a Minnesota Highway Department cast iron
DATE
monument with brass cap stamped.

SKETCH OF REFERENCE TIES

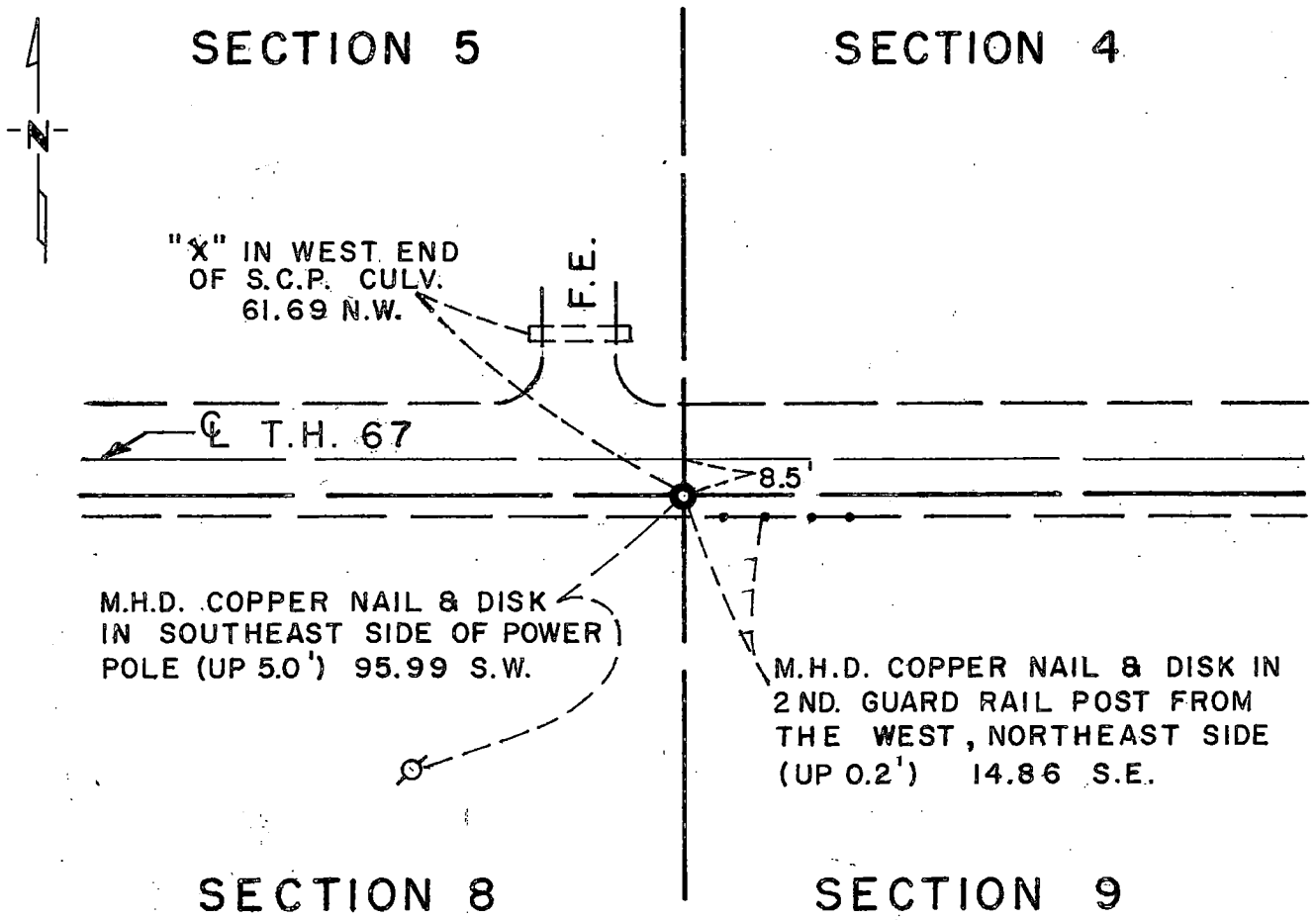

Statement of evidence relative to this corner location is on back of page.

I hereby certify that this document and the data contained herein was prepared by me or under my direct supervision.

Richard M. Hofmeyr SIGNATURE 1-17-77 DATE

Registration No. 11526

- Land Surveyor, Professional Engineer
- County Surveyor, County Engineer

OFFICE OF THE REGISTER OF DEEDS

County of _____ COUNTY RECORDER
YELLOW MEDICINE COUNTY

I hereby certify that this document was filed in the Reg. of Deeds office at 10:05 A.M. on the 21 day of March A.D., 19 77

Register of Deeds Norman J. Opdahl

By Kay Nordahl, Deputy

DOCUMENT NO. 158927

RECORDED
GRANTED
GRANTED
INDEXED

Statement of Evidence: Northeast Cor. Sec. 8, Township 115N, Range 44W

The original Public Land Survey was run in 1871 and a post set in a mound to mark the original corner.

In 1901, John Norgaard, County Surveyor, found a stone in the center of east-west road. Stone had been set by adjacent landowners in the government mound when the area was plain. A 6"x6"x24" Jasper stone monument was placed.

In 1929, Minnesota Highway Department field notes indicate the monument was found in road in line with north-south fence line.

On December 16, 1976, the Minnesota Highway Department placed a cast iron monument using information and ties from right-of-way map and final grading plans. Top of monument down 1" below the surface.

An analysis of the record data indicates the cast iron monument set by the Minnesota Department of Transportation is accepted as the location of the Public Land Survey corner.