

CERTIFICATE OF LOCATION OF GOVERNMENT CORNER

Northeast Corner of Section 12, Township 115N, Range 43W, 5th P.M.

STATE OF MINNESOTA, County of Yellow Medicine

At the corner location shown on the sketch:

- On _____ found a _____
DATE
- left monument as found, lowered monument, removed monument (explain)
- On 12/16/76 placed a Minnesota Highway Department cast iron
DATE
monument with brass plate stamped.

SKETCH OF REFERENCE TIES

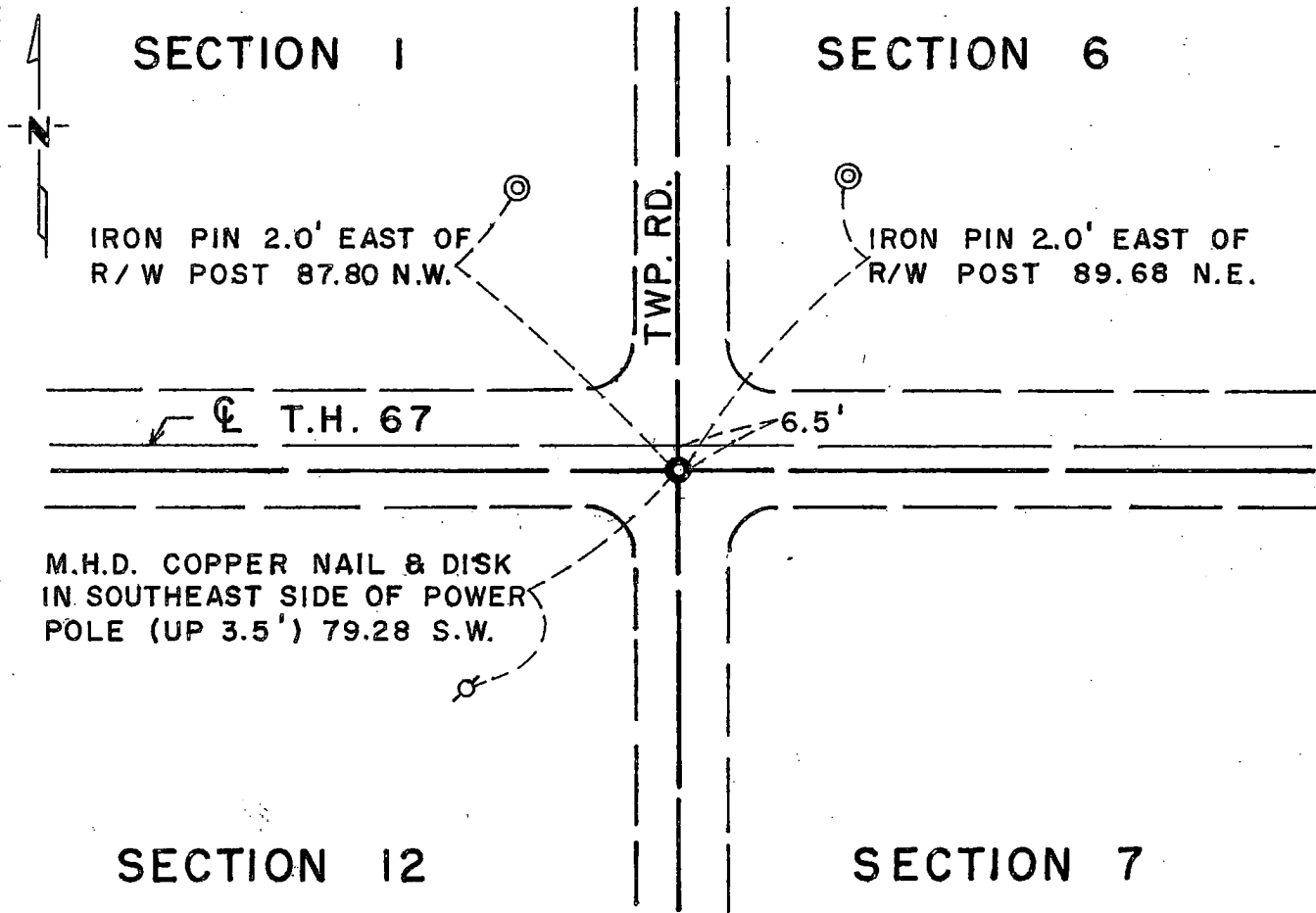

Statement of evidence relative to this corner location is on back of page.

I hereby certify that this document and the data contained herein was prepared by me or under my direct supervision.

Richard M. Kozlowski 1-17-77
SIGNATURE DATE

Registration No. 11526

- Land Surveyor, Professional Engineer
- County Surveyor, County Engineer

OFFICE OF THE REGISTER OF DEEDS
County of _____ COUNTY RECORDER
YELLOW MEDICINE COUNTY

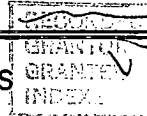

I hereby certify that this document was filed in the Reg. of Deeds office at 10:10 A.M. on the 21 day of March A.D., 1977

Register of Deeds Norman J. Opdahl

By Kay Nordahl, Deputy

DOCUMENT NO. 168928

Statement of Evidence: Northeast Cor., Sec. 12, Township 115N, Range 43W

The original Public Land Survey for township lines was run in 1858 and a post set in a deposit of coal, made mound, trenches and pits to mark the original corner.

In July 1892, J. Peterman, County Surveyor, established the corner as a mound at equal proportionate distance from nearest known corners and on line between the same.

In 1901, J. Norgaard, County Surveyor, placed a 6"x6"x24" Jasper stone monument in the mound made by Peterman.

In 1929, Minnesota Highway Department field notes state that the stone monument was found.

In 1930, D. F. Mattson, Minnesota Highway Department Project Engineer, found the Jasper stone monument and placed two reference ties to same.

In 1934, County Engineer's records indicate that the Jasper stone monument was found and reference ties were in place.

On December 16, 1976, the Minnesota Highway Department placed a cast iron monument using information and ties from right-of-way map and final grading plans. Top of monument is down 1" below surface.

An analysis of the record data indicates the cast iron monument set by the Minnesota Department of Transportation is accepted as the location of the Public Land Survey corner.

The 1934 stone was probably destroyed in road construction of 1965. The corner was re-established from 1929 survey data and perpetuates the location for the corner marked by the stone set in 1901.