

CERTIFICATE OF LOCATION OF GOVERNMENT CORNER

Northeast Corner of Section 11, Township 115N, Range 43W, 5th P.M.

STATE OF MINNESOTA, County of Yellow Medicine

At the corner location shown on the sketch:

- On _____ found a _____
DATE
- left monument as found, lowered monument, removed monument (explain)
- On 12/16/76 placed a Minnesota Highway Department cast iron
DATE monument with brass plate stamped.

SKETCH OF REFERENCE TIES

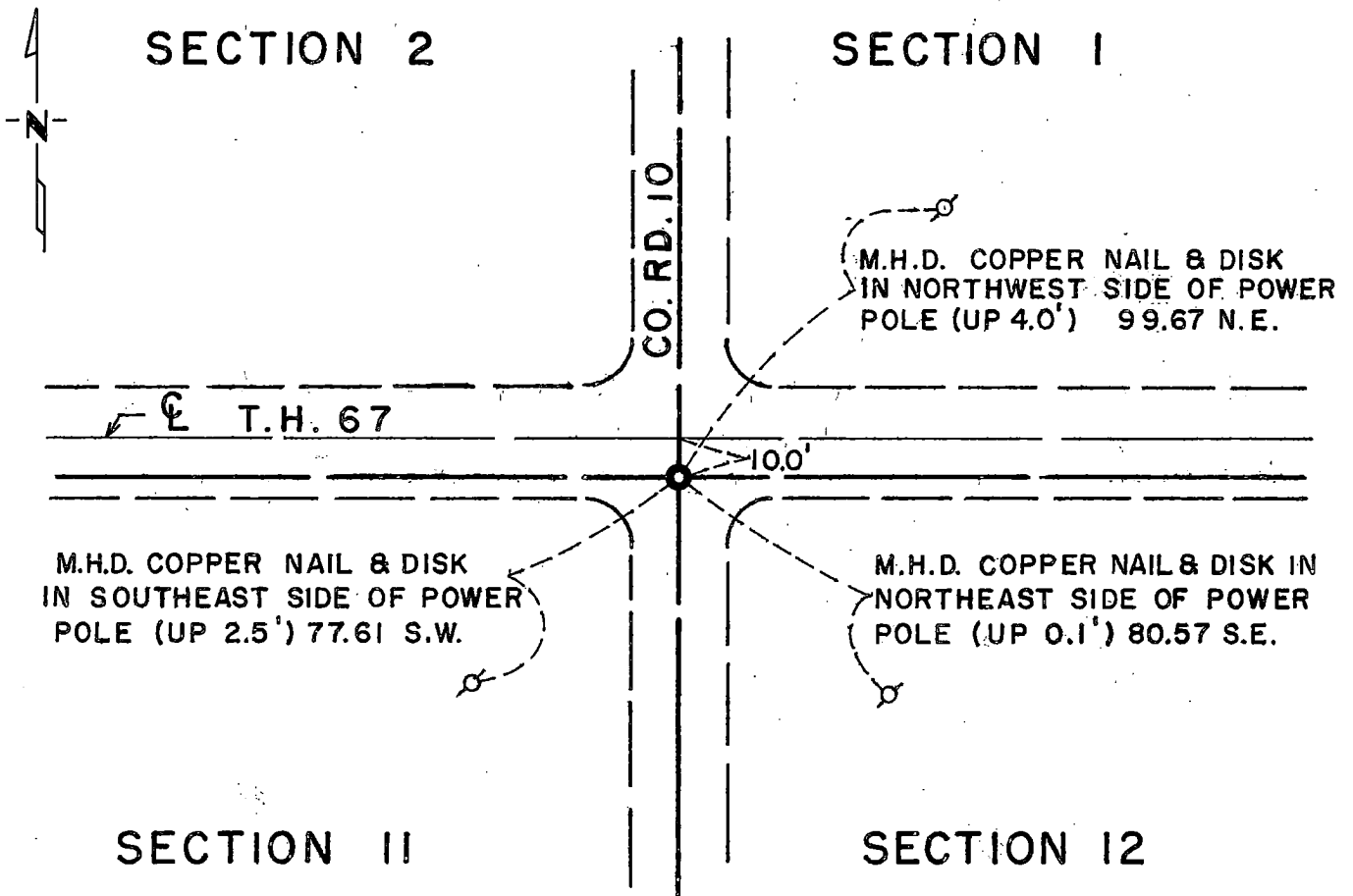

Statement of evidence relative to this corner location is on back of page.

I hereby certify that this document and the data contained herein was prepared by me or under my direct supervision.

Richard M. Koszykowski 1-17-77
SIGNATURE DATE

Registration No. 11526

- Land Surveyor, Professional Engineer
- County Surveyor, County Engineer

OFFICE OF THE REGISTER OF DEEDS
COUNTY RECORDER
County of YELLOW MEDICINE COUNTY

RECORDED
SIGNATURE GRANTEES INDEXED

I hereby certify that this document was filed in the Reg. of Deeds office at 10:15 A.M. on the 21 day of March A.D., 19 77

Register of Deeds Norman J. Opdahl

By Kay Nerdahl, Deputy

DOCUMENT NO. 168929

Statement of Evidence: Northeast Cor., Sec. 11, Township 115N, Range 43W

The original Public Land Survey was run in 1867 and a post set in a mound with charred stakes and pits to mark the original corner.

In 1901, J. Norgaard, County Surveyor, placed a 6"x6"x24" Jasper stone monument at the stake in the government mound.

In 1929, Minnesota Highway Department field notes indicate finding a 6"x6"x24" Jasper stone monument.

In 1930, D. F. Mattson, Minnesota Highway Department Project Engineer, found the 6"x6"x24" Jasper stone monument and placed two reference ties.

In 1934, the County Engineer found a 6"x6"x24" Jasper stone monument and two reference ties and placed two more reference ties.

On December 16, 1976, the Minnesota Highway Department placed a cast iron monument using information and ties from right-of-way map and final grading plans. Top of monument is down 1" below surface.

An analysis of the record data indicates the cast iron monument set by the Minnesota Department of Transportation is accepted as the location of the Public Land Survey corner.

The jasper stone was removed during road construction in 1965. The corner was re-established from 1929 survey data and perpetuates the location of the original Public Land Survey corner.