

# CERTIFICATE OF LOCATION OF GOVERNMENT CORNER

North 1/4 Corner of Section 10, Township 115N, Range 43W, 5th P.M.

STATE OF MINNESOTA, County of Yellow Medicine

At the corner location shown on the sketch:

- On \_\_\_\_\_ found a \_\_\_\_\_  
DATE
- left monument as found,  lowered monument,  removed monument (explain)
- On 12/16/76 placed a Minnesota Highway Department cast iron  
DATE monument with brass plate stamped.

### SKETCH OF REFERENCE TIES

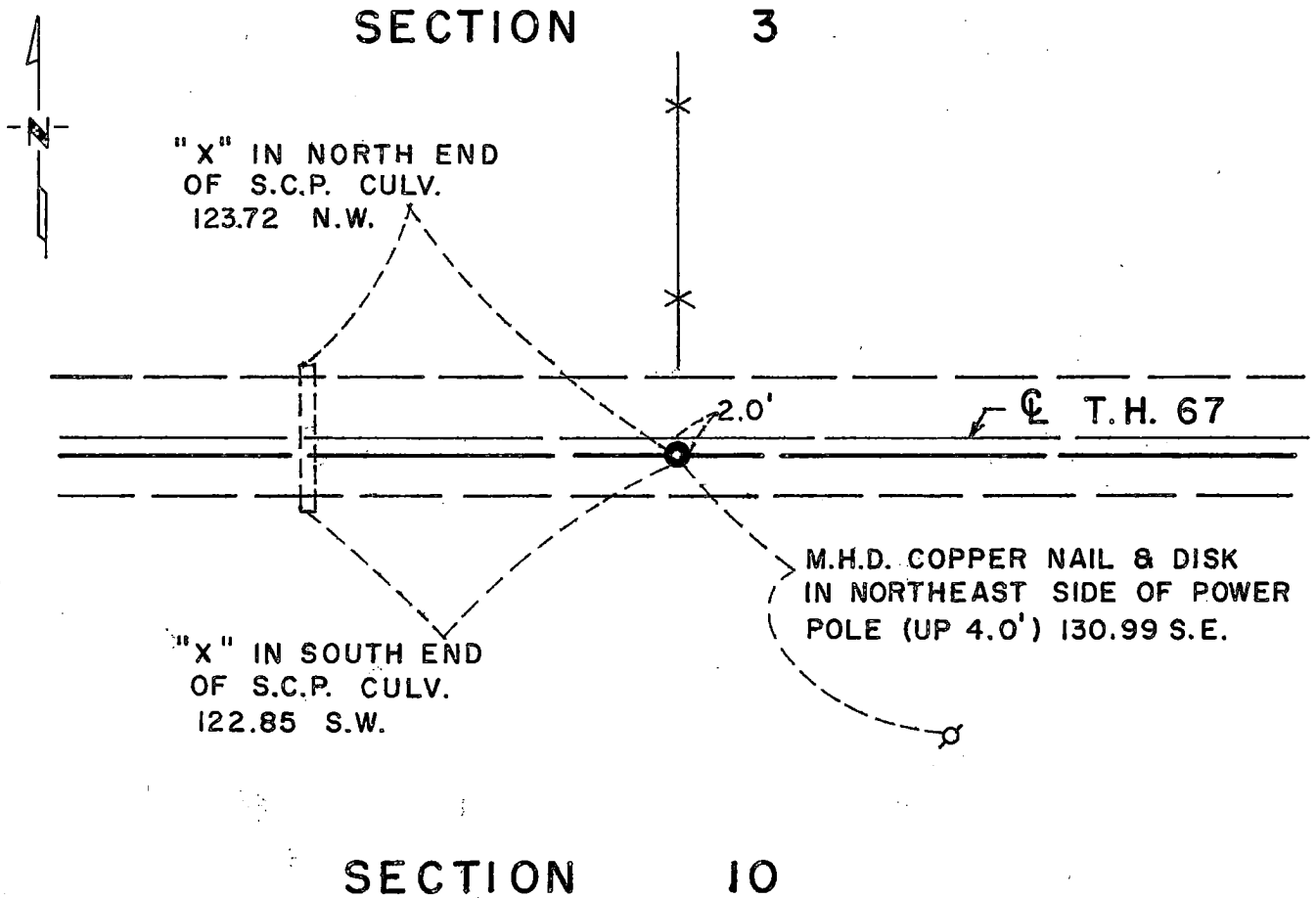

Statement of evidence relative to this corner location is on back of page.

I hereby certify that this document and the data contained herein was prepared by me or under my direct supervision.

Richard M. Koopman  
SIGNATURE DATE 1-17-77

Registration No. 11526

- Land Surveyor,  Professional Engineer
- County Surveyor,  County Engineer

OFFICE OF THE REGISTER OF DEEDS  
COUNTY RECORDER  
County of YELLOW MEDICINE COUNTY

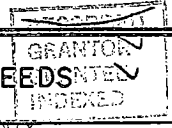

I hereby certify that this document was filed in the Reg. of Deeds office at 10:25 A.M. on the 21 day of March A.D., 19 77

Register of Deeds Norman J. Oplahl

By Kay Nordahl, Deputy

DOCUMENT NO. 168931

**Statement of Evidence:** North 1/4 Cor., Sec. 10, Township 115N, Range 43W

The original Public Land Survey was run in 1867 and a post set in a mound with charred stakes and pits to mark the original corner.

In 1929, Minnesota Highway Department field notes indicate finding a large field stone.

In April 1930, D. F. Mattson, Minnesota Highway Department Project Engineer, found a 3/4" x 15" iron pin and placed two reference ties.

On December 16, 1976, the Minnesota Highway Department placed a cast iron monument using information and ties on right-of-way map and final grading plans. Top of monument is down 1" below the surface.

An analysis of the record data indicates the cast iron monument set by the Minnesota Department of Transportation is accepted as the location of the Public Land Survey corner.

The large stone was probably destroyed during road construction in 1965. The corner was re-established from 1929 survey data and perpetuates the location for the corner as located in 1929.