

CERTIFICATE OF LOCATION OF GOVERNMENT CORNER

North 1/4 Corner of Section 7, Township 115N, Range 43W, 5th P.M.

STATE OF MINNESOTA, County of Yellow Medicine

At the corner location shown on the sketch:

- On _____ found a _____
DATE
- left monument as found, lowered monument, removed monument (explain)
- On 12/16/76 placed a Minnesota Highway Department cast iron
DATE monument with brass plate stamped.

SKETCH OF REFERENCE TIES

SECTION 6

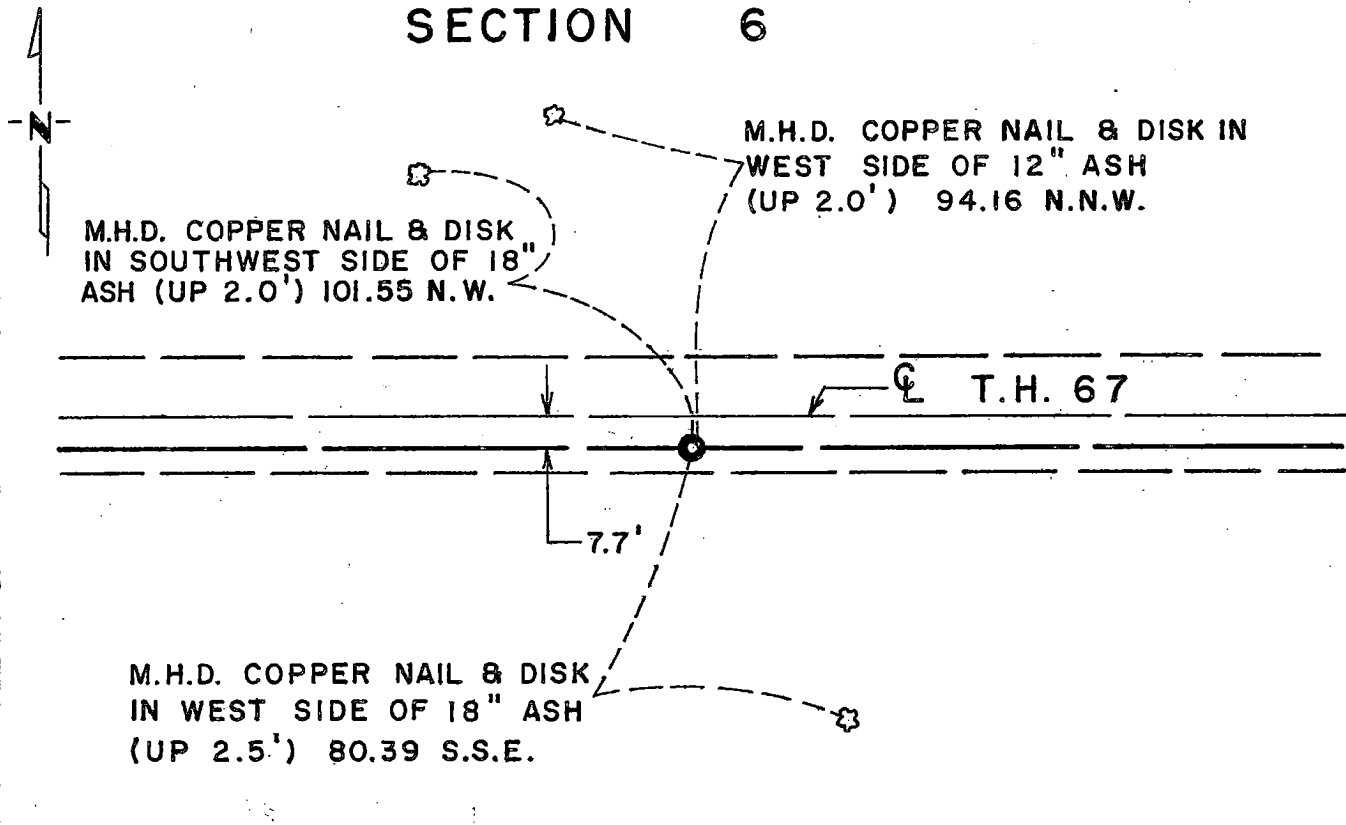

SECTION 7

Statement of evidence relative to this corner location is on back of page.

I hereby certify that this document and the data contained herein was prepared by me or under my direct supervision.

Richard M. Krueger 1-17-77
SIGNATURE DATE

Registration No. 11526

- Land Surveyor, Professional Engineer
- County Surveyor, County Engineer

OFFICE OF THE REGISTER OF DEEDS
County of _____ COUNTY RECORDER
YELLOW MEDICINE COUNTY

I hereby certify that this document was filed in the Reg. of Deeds office at 10:40 A.M. on the 21 day of March A.D., 19 77

Register of Deeds Norman J. Opdahl

By Kay Nerdahl, Deputy

DOCUMENT NO. 168934

RECORDED
INDEXED
GRANTED

Statement of Evidence: North 1/4 Cor., Sec. 7, Township 115N, Range 43W

The original Public Land Survey was run in 1867 and a post set in a mound with pits to mark the original corner.

In 1890, J. Peterman found a stone in mound. (Surv. Rec. Pg. 71)

In 1929, Minnesota Highway Department field notes show a 6"x6" stone post 1½" below surface.

In 1930, D. F. Mattson, Minnesota Highway Department Project Engineer, found 3/4"x12" I.P. (Cert. Loc. #91261).

On December 16, 1976, the Minnesota Highway Department placed a cast iron monument using information and ties from the right-of-way map and final grading plans. Top of monument is down 1" below surface.

An analysis of the record data indicates the cast iron monument set by the Minnesota Department of Transportation is accepted as the location of the Public Land Survey corner.

The stone monument found in 1929 was removed by road construction in 1965. The corner was re-established from data shown on a 1930 R/W map and perpetuates the location of the corner as marked by the 1929 stone.