

CERTIFICATE OF LOCATION OF GOVERNMENT CORNER

Northeast Corner of Section 12, Township 115N, Range 42W, 5th P.M.

STATE OF MINNESOTA, County of Yellow Medicine

At the corner location shown on the sketch:

- On _____ found a _____
DATE
- left monument as found, lowered monument, removed monument (explain)
- On 7/14/76 placed a Minnesota Highway Department cast iron
DATE monument 43.7 feet left of Sta. 158+86.3.

SKETCH OF REFERENCE TIES

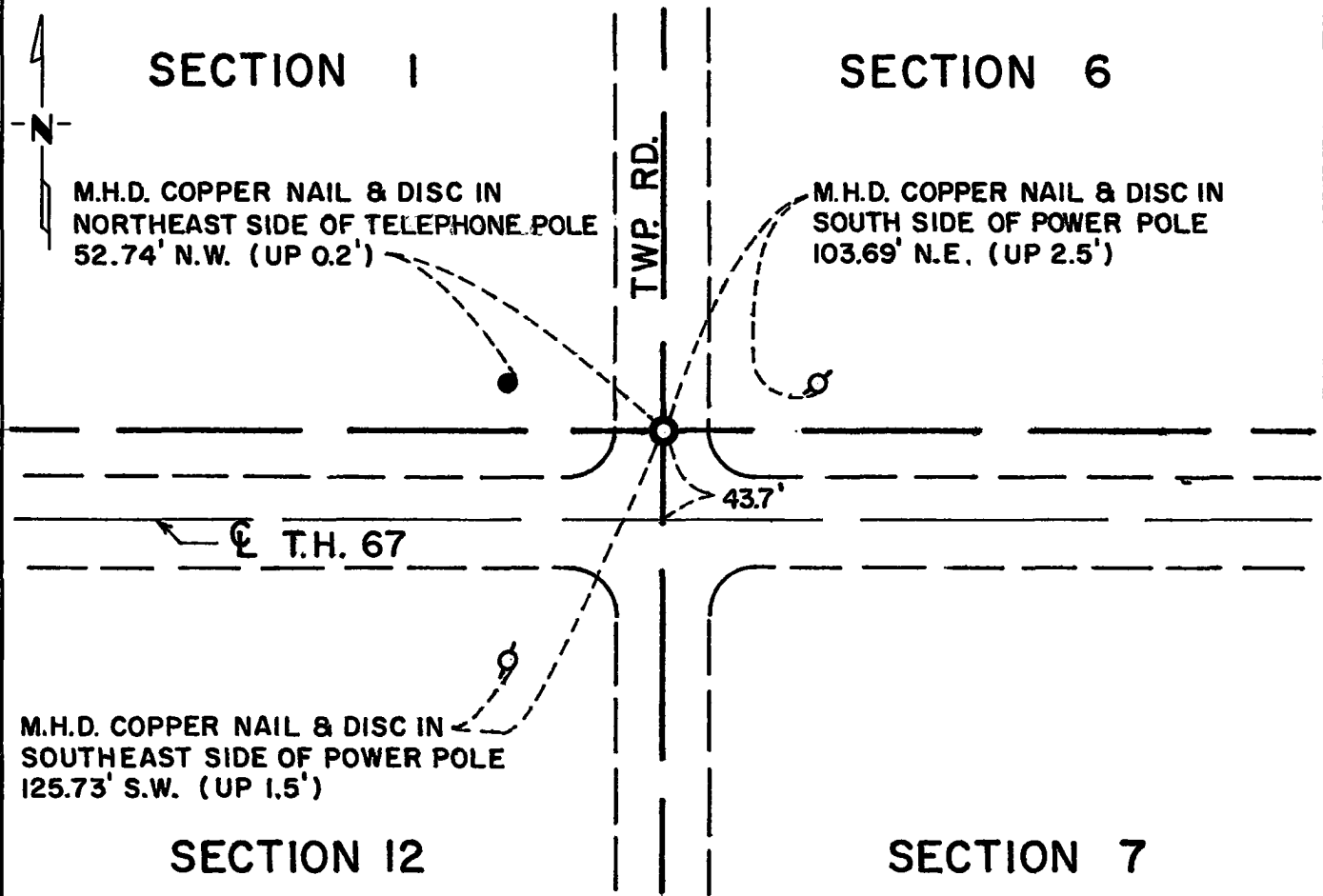

Statement of evidence relative to this corner location is on back of page.

I hereby certify that this document and the data contained herein was prepared by me or under my direct supervision.

Richard M. Knudsen 1-17-77
SIGNATURE DATE

Registration No. 11526

- Land Surveyor, Professional Engineer
- County Surveyor, County Engineer

OFFICE OF THE REGISTER OF DEEDS
County of YELLOW MEDICINE COUNTY RECORDER



I hereby certify that this document was filed in the Reg. of Deeds office at 10:45 A.M. on the 21 day of March A.D., 1977

Register of Deeds Norman J. Oplahl

By Kary Nordahl, Deputy

DOCUMENT NO. 168935

Statement of Evidence: Northeast Cor., Sec. 12, Township 115N, Range 42W

The original Public Land Survey for township lines was run in 1858 and a post set with deposit of coal, made mound, trenches and pits to mark the corner.

In 1901, John Norgaard, County Surveyor, found a stone, stake and iron bolt set by adjacent landowners and placed a 6"x6"x24" cut Jasper Stone.

In August 1909, John Norgaard, County Surveyor, found the Jasper Stone monument.

In October 1913, John Norgaard, County Surveyor, found the Jasper Stone monument.

In 1939, the Minnesota Highway Department found the Jasper Stone monument in location as shown on right-of-way map.

On June 30, 1976, the Minnesota Highway Department dug in location as shown on right-of-way and grading plans. No monument was found.

On July 14, 1976, the Minnesota Highway Department placed a cast iron monument using information and ties as shown on the right-of-way map and final grading plans. Top of monument is down 2" below surface.

An analysis of the record data indicates the cast iron monument set by the Minnesota Department of Transportation is accepted as the location of the Public Land Survey corner.

The stone monument found in 1939 was removed in road construction of 1940. The corner was re-established from 1939 survey data and perpetuates the location for the corner as marked by the jasper stone set in 1901.