

CERTIFICATE OF LOCATION OF GOVERNMENT CORNER

East Quarter Corner of Section 1, Township 115N, Range 40W, 5th P.M.
 STATE OF MINNESOTA, County of Yellow Medicine

At the corner location shown on the sketch:

- On Apr. 29, 1976 found a nothing marking the corner.
DATE
- left monument as found, lowered monument, removed monument (explain)
- On Dec. 22, 1976 placed a Minnesota Highway Department cast iron monument
DATE
down 2 inches below road surface.

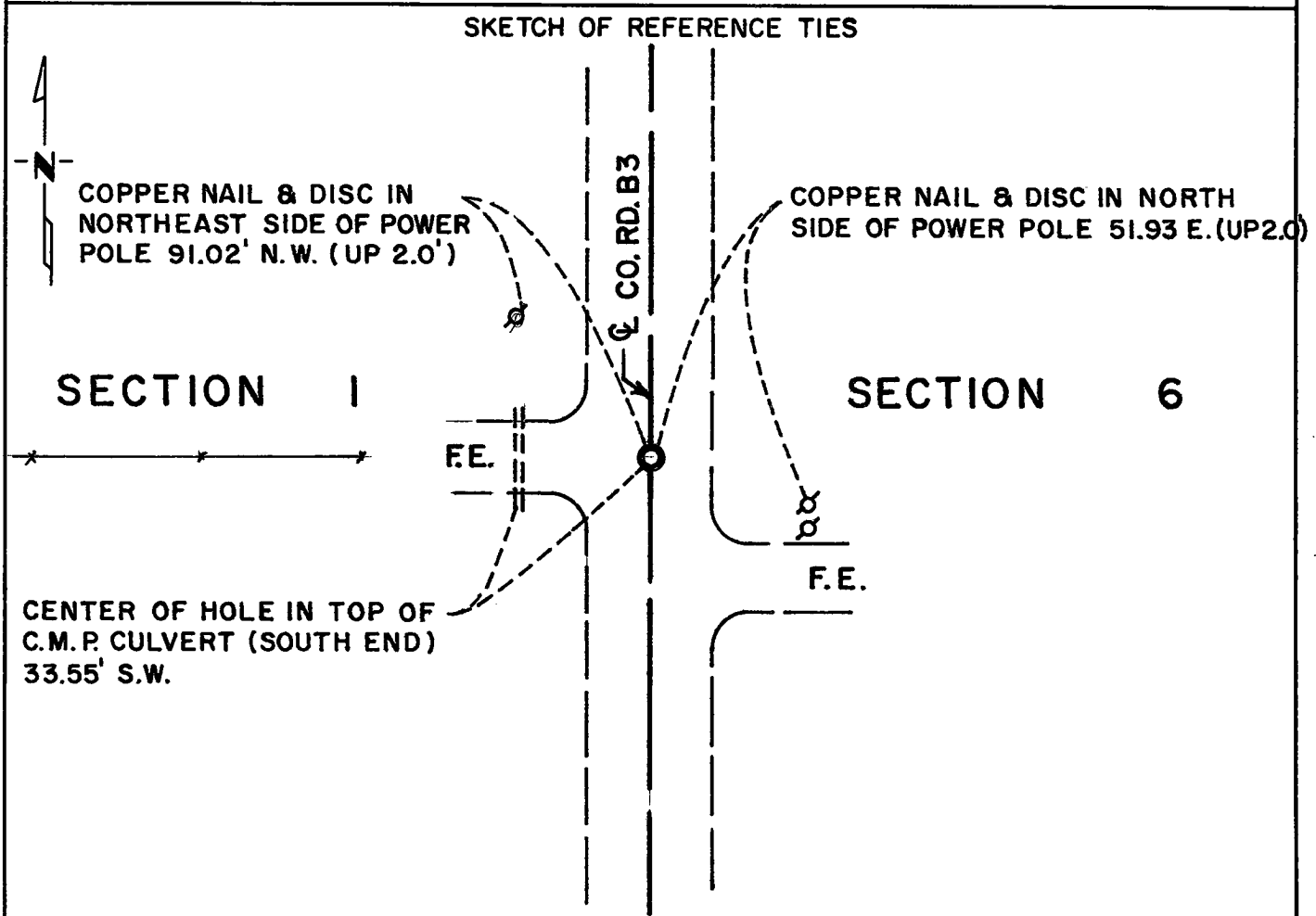

Statement of evidence relative to this corner location is on back of page.

I hereby certify that this document and the data contained herein was prepared by me or under my direct supervision.

Richard M. Krofegalski 9-15-77
SIGNATURE DATE

Registration No. 11526

- Land Surveyor, Professional Engineer
- County Surveyor, County Engineer

COUNTY RECORDER
 YELLOW MEDICINE COUNTY
 OFFICE OF THE Yellow Medicine
 County of Yellow Medicine

I hereby certify that this document was filed in the Reg. of Deeds office at 12:10 P. .M. on the 4th day of October A.D., 19 77

COUNTY RECORDER
 YELLOW MEDICINE COUNTY Norman J. Opsdahl

By Kay Nordahl, Deputy
 DOCUMENT NO. 170323

Statement of Evidence: E $\frac{1}{4}$ Cor. Sec. 1, T115N, R40W, 5th P.M.

- 1858 - The original Public Land Survey of the township line was completed by W. J. Neeley. A wood post was set over deposited coal in a dirt mound with trenches and pits to mark the corner.
- 1913 - John Norgaard, County Surveyor, located the corner midway and on line between section corners. He also did this in 1915 but did not state whether he set anything to mark the corner in either case.
- 1976 - The Minnesota Highway Department excavated a 7 foot by 8 foot by 3 $\frac{1}{2}$ foot deep hole to natural ground at the intersection of the centerline of a north/south road with a fence line west. Nothing was found marking the corner.
- 1976 - Mn/DOT set a cast iron monument 4 inches below the road surface at the lost location.

The lost location is accepted as the position of the government corner because the County Surveyor set the corner at this position 63 years ago and it also fits the occupation lines, that is, at the intersection of the centerline of a north/south road and a fence line west.

For details of survey analysis and 1976 electronic measurements, see the Survey Report for S.P. 8702 and S.P. 8706, Jct. T.H. 23 and T.H. 67 - 3 miles S.W. of Granite Falls, on file with the Surveys Section, Mn/DOT, Willmar, MN, 56201.