

CERTIFICATE OF LOCATION OF GOVERNMENT CORNER

North Quarter Corner of Section 11, Township 115N, Range 40W, 5th P.M.

STATE OF MINNESOTA, County of Yellow Medicine

At the corner location shown on the sketch:

- On _____ found a _____
DATE
- left monument as found, lowered monument, removed monument (explain)
- On Dec. 21, 1976 placed a Minnesota Highway Department cast iron monument
DATE
at road surface.

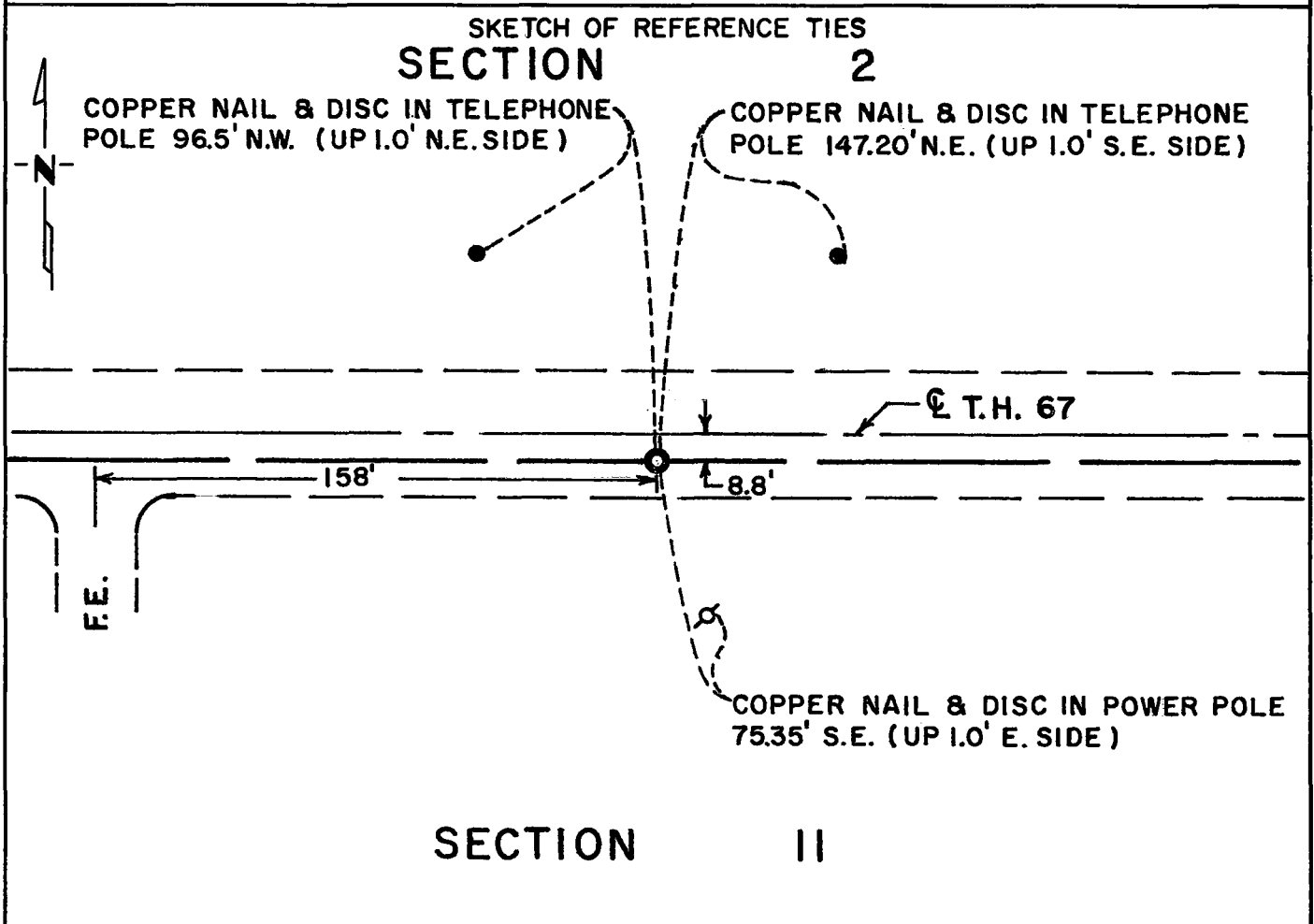

Statement of evidence relative to this corner location is on back of page.

I hereby certify that this document and the data contained herein was prepared by me or under my direct supervision.

Richard M. Knoflynski 9-15-77
SIGNATURE DATE

Registration No. 11526

- Land Surveyor, Professional Engineer
- County Surveyor, County Engineer

COUNTY RECORDER
OFFICE OF THE YELLOW MEDICINE COUNTY
County of Yellow Medicine

I hereby certify that this document was filed in the Reg. of Deeds office at 12:35 P.M. on the 4th day of October A.D., 19 77

COUNTY RECORDER
YELLOW MEDICINE COUNTY Norman J. Opdahl

By Kay Nordahl, Deputy

DOCUMENT NO. 170328

Statement of Evidence: N¼ Cor. Sec. 11, T115N, R40W

The original Public Land Survey was completed in 1864 by C. E. Davis and J. W. Webb, Jr. A wood post was set in a dirt mound with trenches and pits to mark the corner.

There is no record evidence that anything has been set to mark the corner since the original Public Land Survey.

The Minnesota Highway Department surveyed the centerline of T.H. 67 in 1931. The notes from this survey show that the northwest corner and the northeast corner of the section were found but not the quarter corner. The right-of-way map from this survey shows the quarter corner to be at engineer's station 79+57.3, that is 2635.6 feet from the northwest section corner and 2637.0 feet from the northeast section corner.

The Minnesota Highway Department set a cast iron monument with a brass disc on December 21, 1976 at the lost location. The lost location is 2.9 feet east of the location shown on the R/W map and it is 8.8 feet south of the centerline of T.H. 67.

For details of survey analysis and 1976 electronic measurements, see the Survey Report for S.P. 8702 and S.P. 8706, Jct. T.H. 23 and T.H. 67 - 3 miles S.W. of Granite Falls, on file with the Surveys Section, Mn/DOT, Willmar, MN, 56201.