

# CERTIFICATE OF LOCATION OF GOVERNMENT CORNER

Southeast Corner of Section 33, Township 114, Range 46, 5th P.M.

STATE OF MINNESOTA, County of YELLOW MEDICINE

At the corner location shown on the sketch:

On 6-30-77 found a 7"x7"x 24" Granite Block Leaning Over, Up 8"  
DATE

left monument as found,  lowered monument,  removed monument (explain)

On 6-30-77 placed a 3/4"x 24" Iron Rod on West Side Block at Ground Level  
DATE

SKETCH OF REFERENCE TIES

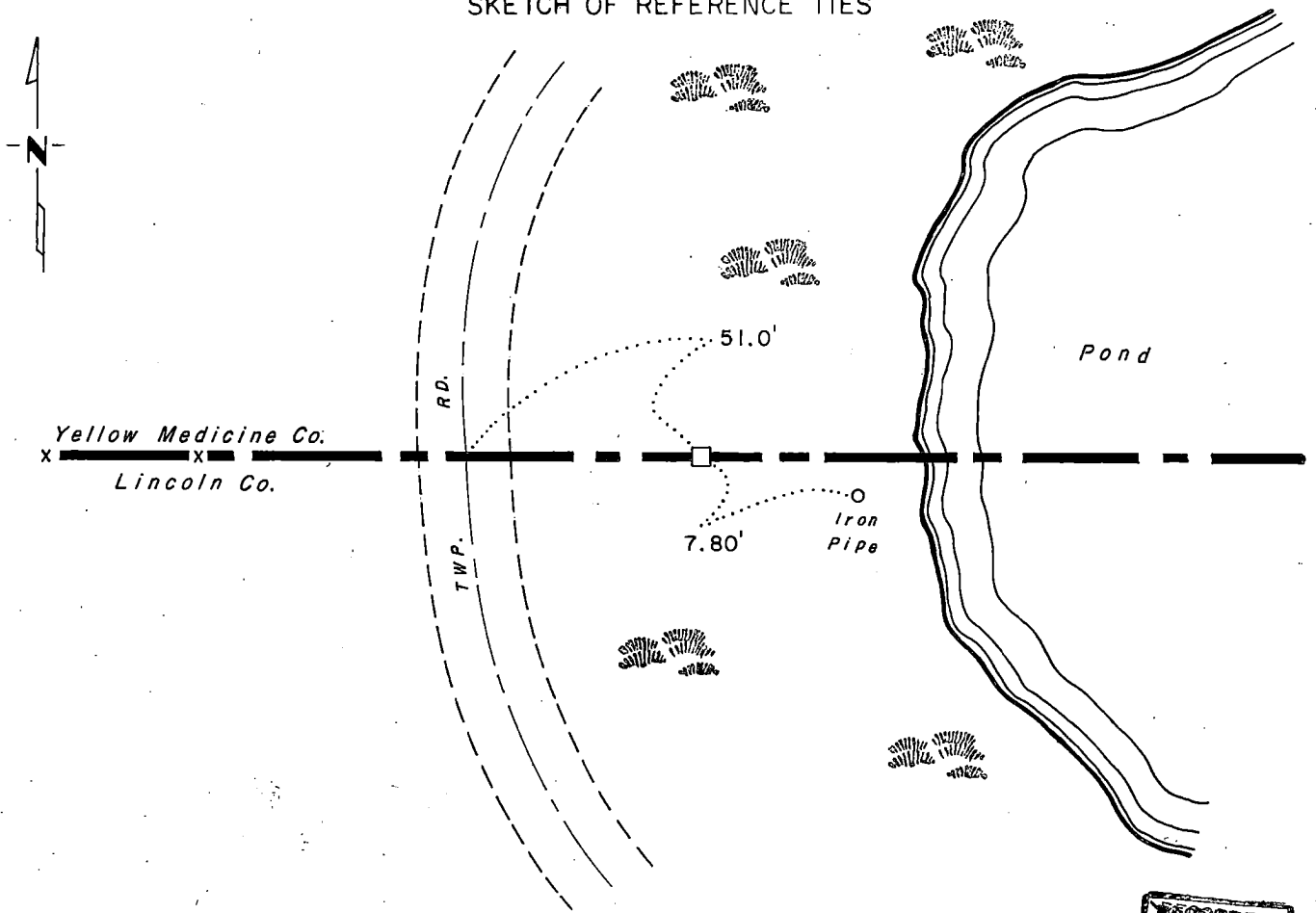

Statement of evidence relative to this corner location is on back of page.

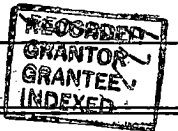

I hereby certify that this document and the data contained herein was prepared by me or under my direct supervision.

Sam H. Stevenson 10-20-78  
SIGNATURE DATE

Registration No. 12684

- Land Surveyor,  Professional Engineer
- County Surveyor,  County Engineer.

OFFICE OF THE COUNTY RECORDER  
YELLOW MEDICINE COUNTY  
County of Yellow Medicine

I hereby certify that this document was filed in the County Recorder's office at 12:45 P.M. on the 1 day of November, A.D., 1978

COUNTY RECORDER Norman J. Campbell  
YELLOW MEDICINE COUNTY

By Harold M. Mable, Deputy

DOCUMENT NO. 172778

**Statement of Evidence:**

Southeast Corner of Section 33, Township 114, Range 46. Yellow Medicine County.

This corner was found to be in a lake by the U.S. General Land Office survey in 1871. The government notes show meander corners set 22.50 chains east and 5.40 chains west.

In 1957 and 1977, the DNR Bureau of Engineering contacted the Yellow Medicine County Offices of the Recorder and Highway Engineer for corner information. The following information was obtained from the Recorder:

In 1899 to 1901, John Norgaard, County Surveyor, remonumented all section corners in the county and recorded his work in Surveyor's Record Book B. On page 200 he states he located his corner at equal distance between quarter corners and on line between the South Quarter corner Section 34 and the meander corner on the south line Section 33. He set a 6" x 6" x 24" jasper granite monument 4" above ground.

On June 30, 1977, we found a 7" x 7" x 24" granite block leaning over. We straightened the block and set a 3/4" x 24" iron rod on the west side flush with the ground. This area is normally under water. We also found a 1/2" x 26" iron pipe 7.8' easterly of the monument as set by this office in 1962.