

CERTIFICATE OF LOCATION OF GOVERNMENT CORNER

South Quarter _____ Corner of Section 33, Township 117N, Range 40W, 5th P.M.

STATE OF MINNESOTA, County of Yellow Medicine

At the corner location shown on the sketch:

On Apr. 16, 1981 found a nothing in place to mark the corner
DATE

left monument as found, lowered monument, removed monument (explain)

On Apr. 17, 1981 placed a cast iron monument with brass plate on top marked
DATE
with an "X" about 20" below ground - set a $\frac{3}{4}$ " x 24" iron pin under the monument

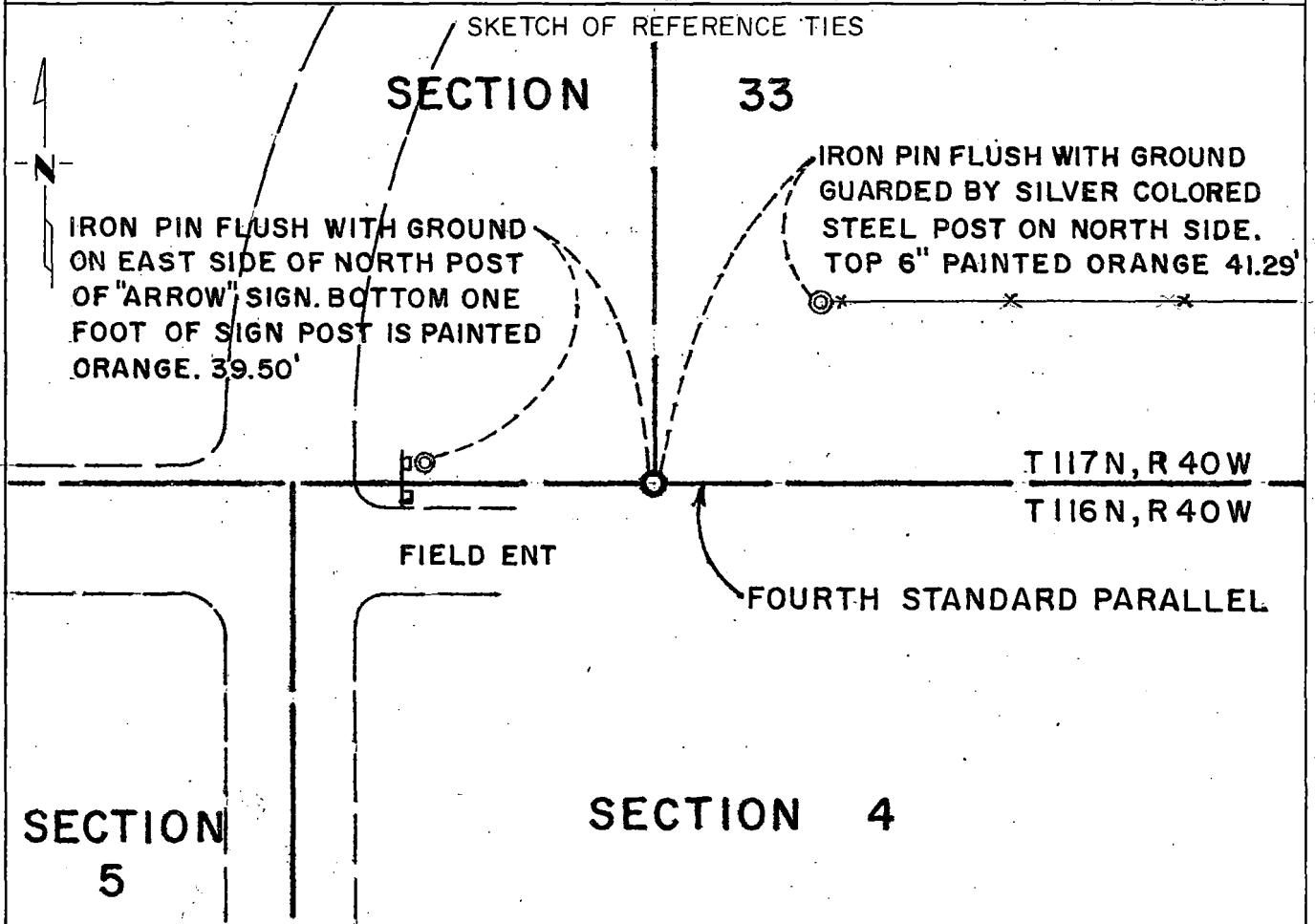

Statement of evidence relative to this corner location is on back of page.

I hereby certify that this document and the data contained herein was prepared by me or under my direct supervision.

Robert C Jones 4/30/81
SIGNATURE DATE

Registration No. 11864

Land Surveyor, Professional Engineer

County Surveyor, County Engineer

OFFICE OF THE COUNTY RECORDER
County of Yellow Medicine

I hereby certify that this document was filed in the Co. Recorders office at 8:55 A.M. on the 8 day of May A.D., 19 81

County Recorder Thomas B. Osdahl

By _____, Deputy

DOCUMENT NO. 178069

Statement of Evidence: South Quarter Corner Section 33-117-40

- 1858 - The original Public Land Survey for the Fourth Standard Parallel was made by William J. Neely. A wood post was set in a mound of dirt and trenches and pits were dug to mark the corner.
- 1887 - L.R. Moyer, County Surveyor, either set or found a stone measuring 20"x 6"x 4" to mark the corner.
- 1927 - John Norgaard, County Surveyor, found a stone which measured 3"x 6" on top marking the corner.
- 1981 - R.C. Jones, R.L.S., and a Mn/DOT survey crew searched an area about 10 ft. x 10 ft. with a tile probe at the intersection of centerlines of an east/west road west and a north/south road north.

The S.E. corner of Sec. 32-117-40 and the N.E. corner of Sec. 4-116-40 were found. The distance between them is 7908.47 feet as compared to Moyer's and Norgaard's surveys distance of 7901.62 feet. The old survey distances were proportioned using a fence corner about $\frac{1}{2}$ mile east as a control for direction. This placed the corner 8 feet north and 3 feet east of the intersection of the two roads and about 33 feet south of an east/west fence line extending to the east. Another 10 ft. x 10 ft. area was searched with a tile probe, but nothing was found.

Local landowners said that the east/west road used to go through this area to the N.E. corner of Sec. 4-116-40. This road was abandoned and obliterated over 20 years ago. The east/west fence that is 33 feet north of the corner appears to have been the northerly right of way line of the abandoned road.

Both locations that were probed are in plowed land and therefore it is felt that the monument was either destroyed by the plow or when the old road was obliterated.

The corner was set by the method described above which places it 8 feet north and 3 feet east of the intersection of roads and 33 feet south of the east/west fence.

A cast iron monument with a brass plate on top marked with an "X" was set so the top is 20" below ground. A $\frac{3}{4}$ "x 24" iron pin was set below the monument so that the top of the iron pin is about 40" below ground.

This position is accepted as the location of the government corner because it fits the old Moyer-Norgaard surveys in an east/west direction and occupation lines in a north/south direction.

For further survey information regarding this corner, contact the Surveys Section, Mn/DOT, Willmar, Mn. 56201