

# CERTIFICATE OF LOCATION OF GOVERNMENT CORNER

Corner to Section 2 Township 113 N Range 39 W No. \_\_\_\_\_

STATE OF MINNESOTA,

County of Yellow Medicine S.S.

I hereby certify that on the 19th day of August 1976,  
that I, Lyle E. Moseng, a Registered Land Surveyor, ~~County Surveyor,~~  
~~County Highway Engineer,~~ <sup>S&T</sup> found the Northeast corner of Section 2  
~~which was evidenced by see back~~

\_\_\_\_\_ and I further certify that to perpetuate the  
location of such corner I did, at the exact location thereof, place a permanent  
marker consisting of #4 Rebar w/seal.

I further certify that I established 4 references or witness monuments consist-  
ing of two yeild signs & two power poles which reference or witness monuments are  
located in the manner following.

Dh nail & bc in PP	NE 170.58 ft
Dh nail & bc in PP	SE 47.65 ft
Center of steel post for yeild sign	SE 28.70 ft
Center of steel post for yeild sign	NW 34.66 ft

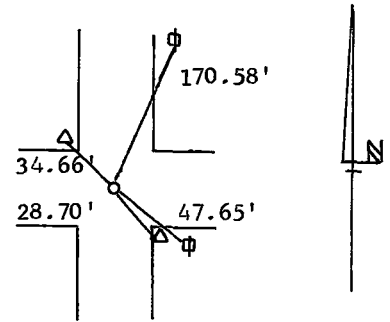

Dated at Marshall, Minnesota, this 27th day of May, 1980.

Lyle E. Moseng  
~~County Surveyor, County Highway Engineer,~~  
Registered Land Surveyor No. 11943

**182999**  
OFFICE OF THE REGISTER OF DEEDS

County of Yellow Medicine

I hereby certify that the within instrument was filed in this office for  
record on the 16 day of November A.D., 1983, at 1:45 o'clock P.M.

Norman J. Opdahl, County Recorder  
**Register of Deeds**  
by Kay Nordahl

Deputy

We dug a hole 3'x3'x3' deep and found nothing; we set the corner on line between the NE cor sec 1 & the NE cor of sec 3 & in the center line of roads running north & south.