

# CERTIFICATE OF LOCATION OF GOVERNMENT CORNER

Corner to Section 20 Township 114 N Range 39 West

No. \_\_\_\_\_

STATE OF MINNESOTA,

County of Yellow Medicine S.S.

I hereby certify that on the 30th day of June 1980,  
that I, Lyle E. Moseng, a Registered Land Surveyor, ~~County Surveyor~~,  
~~County Highway Engineer~~ found the Northeast corner of Section 20  
\_\_\_\_\_ which was evidenced by a square granite stone 3" below existing gravel road with  
an old latb below the stone and I further certify that to perpetuate the  
location of such corner I did, at the exact location thereof, place a permanent  
marker consisting of left as found; we put R/R spikes on the north and south side of the stone.  
I further certify that I established 3 references or witness monuments consist-  
ing of a power pole & two fence posts which reference or witness monuments are  
located in the manner following.

Dh nail & bc in FP	NNE 39.03 ft
Dh nail & bc in FP	NNE 68.42 ft
Dh nail & bc in PP	NE 42.31 ft

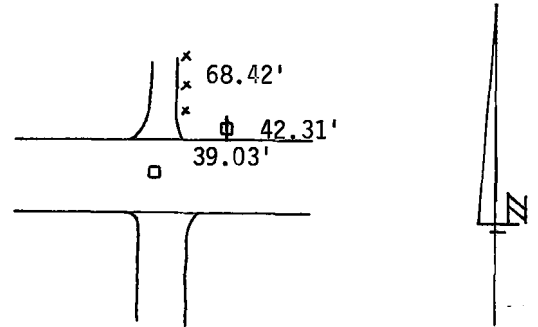

Dated at Marshall, Minnesota, this 14th day of July, 1980.

**183009**

OFFICE OF THE REGISTER OF DEEDS

County of Yellow Medicine

Lyle E. Moseng  
~~County Surveyor, County Highway Engineer~~  
Registered Land Surveyor No. 1943

I hereby certify that the within instrument was filed in this office for  
record on the 16 day of November A.D., 1983, at 2:35 o'clock P.M.

Norman J. Opdahl, County Recorder

Register of Deeds

by Kay Nordahl Deputy