

# CERTIFICATE OF LOCATION OF GOVERNMENT CORNER

Corner to Section 30 Township 114 N. Range 42 W.

No. \_\_\_\_\_

STATE OF MINNESOTA,

County of Yellow Medicine S.S.

I hereby certify that on the 25 th day of August 1983,  
that I, Lyle E. Moseng, a Registered Land Surveyor, ~~County Surveyor,~~  
~~County Highway Engineer~~, found the Northeast corner of Section 30-114-42  
\_\_\_\_\_ which was evidenced by 6" square cut Jasper stone

\_\_\_\_\_ and I further certify that to perpetuate the  
location of such corner I did, at the exact location thereof, place a permanent  
marker consisting of a 5/8 inch rerod with seal on top of stone.

I further certify that I established 3 references or witness monuments consist-  
ing of culvert, power pole, tele. pedestal which reference or witness monuments are  
located in the manner following.

dh nail and seal in Power Pole SW. 60.18 feet

PK nail in top of 18" culvert NE. 33.78 feet

center of top of telephone pedestal NE. 45.78 feet

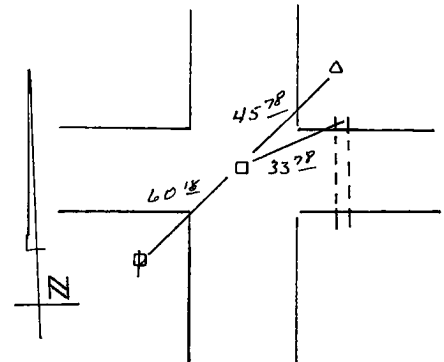

Dated at Marshall, Minnesota, this 26 th day of August, 1983.

**183031**

OFFICE OF THE REGISTER OF DEEDS

County of Yellow Medicine

Lyle E. Moseng  
~~County Surveyor, County Highway Engineer,~~  
Registered Land Surveyor No. 11943

I hereby certify that the within instrument was filed in this office for  
record on the 17 day of November, A.D., 1983, at 3:05 o'clock P.M.

Norman J. Opdahl, County Recorder

**Register of Deeds**

by Kay Nordahl Deputy