

CERTIFICATE OF LOCATION OF GOVERNMENT CORNER

WEST QUARTER Corner of Section 18, Township 113N., Range 39W., 5th P.M.

STATE OF MINNESOTA, County of YELLOW MEDICINE

At the corner location shown on the sketch:

- On _____ found a _____
DATE
- left monument as found, lowered monument, removed monument (explain)
- On 2-6-86 placed a 1 1/4" x 1 1/4" x 20" PERFORATED STEEL TUBE WITH
DATE ALUMINUM CAP STAMPED "DNR SURVEY MARKER", DOWN 0.4'

SKETCH OF REFERENCE TIES

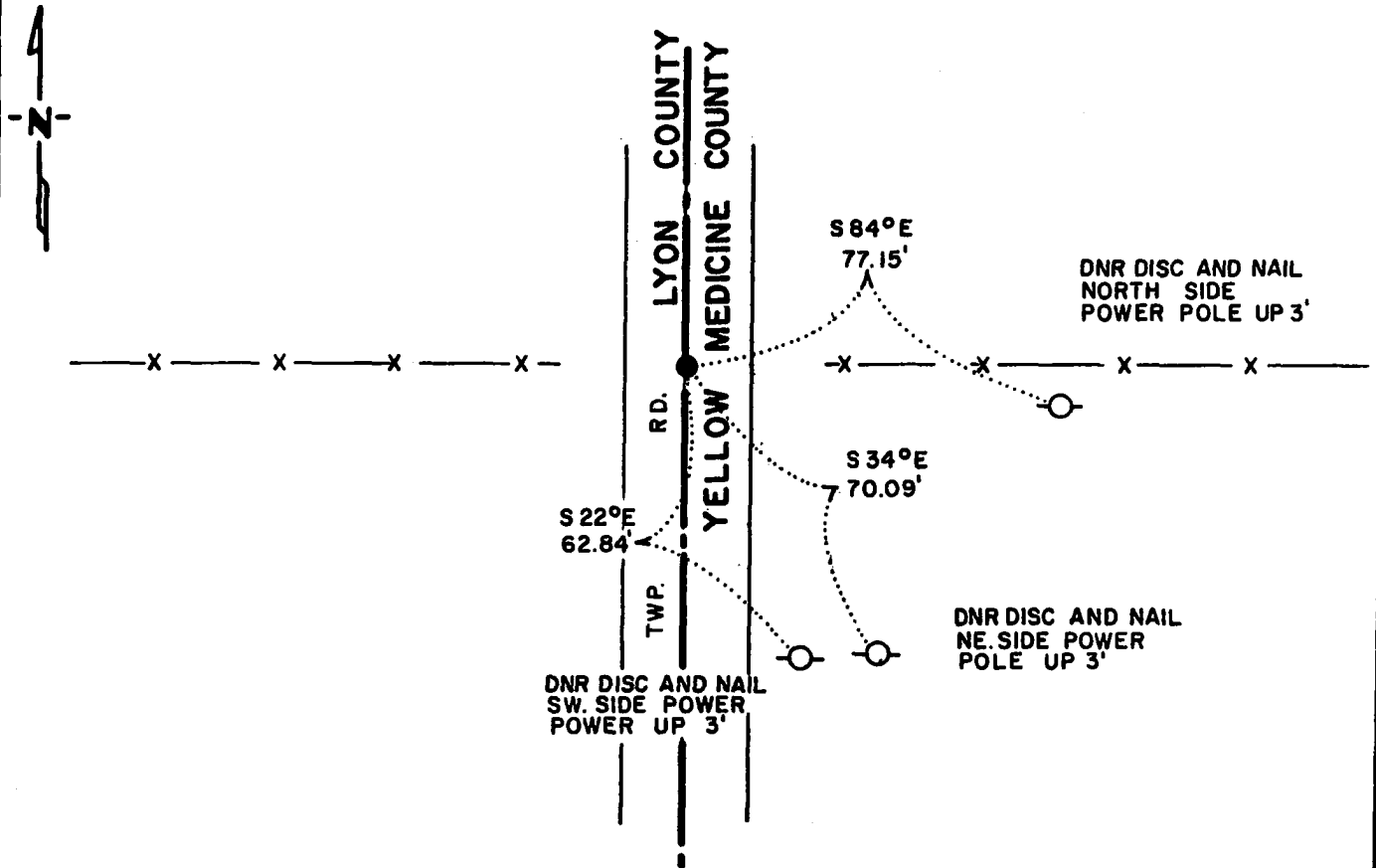

BEARINGS OBSERVED WITH COMPASS

Statement of evidence relative to this corner location is on back of page.

J.A.G 3-6-86
G-1187

I hereby certify that this document and the data contained herein was prepared by me or under my direct supervision.

Lowell R. Pomeroy 3-11-86
SIGNATURE DATE

Registration No. 17005

Land Surveyor, Professional Engineer

County Surveyor, County Engineer

OFFICE OF THE COUNTY RECORDER
County of Yellow Medicine

I hereby certify that this document was filed in the Co. Recorders office at 9:30 A.M. on the 21 day of March A.D., 19 86

County Recorder Norman J. Opdahl

By Kay Nerdahl, Deputy

DOCUMENT NO. 188027

RECORDED
GRANTED
INDEXED

West Quarter Corner Section 18, Township 113 North, Range 39 West

This corner was originally established by the U. S. General Land Office survey in 1858. The government notes show corner marked with a wood post set in mound of earth with pits and trench dug around the mound.

In July 1985, the DNR Bureau of Engineering contacted the following for corner information:

Lyon County Offices of the Recorder and Highway Engineer
Yellow Medicine County Offices of the Recorder and Highway Engineer

The following information was obtained from the Yellow Medicine County Recorder's Office:

Surveyor's Record Book, on Page 262, contains a survey by John Norgaard, County Surveyor, in March 1912. Norgaard states he used fence lines running east and west. Adjoining landowners testified that fence lines were set according to the government line when plain. Survey shows a distance of 2651 feet from this corner to the southeast corner of Section 13, but does not state what was set at the corner.

On October 10, 1985, the DNR Bureau of Engineering hired a backhoe operated by Rick Jesseritz of Cottonwood to dig for evidence of this corner. Dug a 9 foot east-west by 12 foot north-south hole, the center being at the intersection of a north-south road and fence lines east and west. Encountered an old road bed down 14", natural ground down 20", dug down to a depth of 30", but found nothing. Set a temporary point at the above mentioned intersection. The temporary point measures:

2652.05 feet from the northeast corner Section 13
2655.44 feet from the northeast corner Section 24
1.70 feet north and 0.44 feet east of the lost position

Accept the temporary point as the location of the corner.

Traverse information is available from the DNR Bureau of Engineering.

199hab/missu4