

CERTIFICATE OF LOCATION OF GOVERNMENT CORNER

NORTHEAST Corner of Section 24, Township 114 N., Range 44 W., 5th. P.M.

STATE OF MINNESOTA, County of YELLOW MEDICINE

At the corner location shown on the sketch:

- On 6-30-83 found a 6"x6" CUT GRANITE STONE WITH WOOD
DATE
BESIDE IT, DOWN 20"
 - left monument as found, lowered monument, removed monument (explain)
- On 6-30-83 placed a 1 1/4" x 1 1/4" x 16" PERFORATED STEEL TUBE WITH
DATE
ALUMINUM CAP STAMPED "D.N.R. SURVEY MARKER" OVER STONE, DOWN 0.3'

SKETCH OF REFERENCE TIES

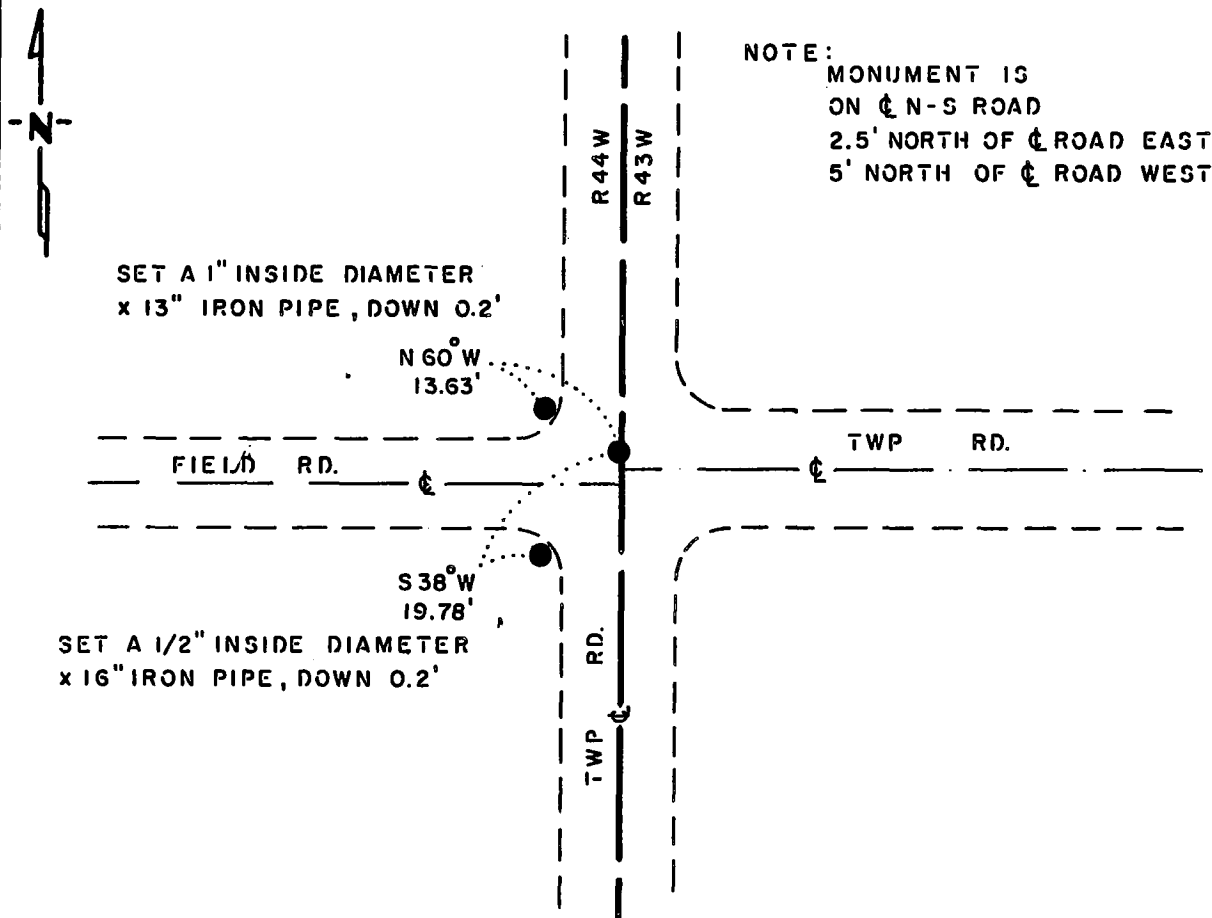

BEARINGS OBSERVED WITH COMPASS

Statement of evidence relative to this corner location is on back of page.

J. B. M. 1-28-86
9-651

I hereby certify that this document and the data contained herein was prepared by me or under my direct supervision.

Bruce W. Sheppard 4-28-86
SIGNATURE DATE

Registration No. 17003

- Land Surveyor, Professional Engineer
- County Surveyor, County Engineer

OFFICE OF THE COUNTY RECORDER
 County of Yellow Medicine

I hereby certify that this document was filed in the Co. Recorders office at 9:45 A.M. on the 1 day of May A.D., 1986

County Recorder Norman J. Oodahl

By Kay Nordahl Deputy

DOCUMENT NO. 188279

RECORDED
 GRANTOR
 GRANTEE
 INDEXED

Northeast Corner Section 24, Township 114 North, Range 44 West

**This corner was originally established by the U. S. General Land Office survey in 1858. The government notes show:
set post, deposited coal, made mound with trench and pits as per instructions**

In June 1983, the DNR Bureau of Engineering contacted the Yellow Medicine County Offices of the Recorder and Highway Engineer for corner information.

The following information was obtained from the Recorder's Office:

**Surveyor's Book B, introductory page, Page 37 and Page 39 contain a survey by John Norgaard, County Surveyor, in 1901. Survey shows that a 6" by 6" by 24" jasper granite was set at corner:
2637 feet from the east quarter corner of Section 24
5273 feet from the northeast corner of Section 13**

Surveyor's Book B, introductory page, Page 177 and Page 183 contain a survey by John Norgaard, County Surveyor, in 1901. Survey states "found stone and part of the government stake, set top of a 6" by 6" by 24" jasper granite 2 inches above ground."

**Surveyor's Plat Book on Page 184 contains a survey by John Norgaard, County Surveyor, in 1904. Survey shows corner but does not indicate what was found or set. The corner is shown:
2642.5 feet from the north quarter corner of Section 24
5288 feet from the northeast corner of Section 13**

**Surveyor's Plat Book, Pages 190 and 191 contain a survey by John Norgaard, County Surveyor, in 1905. Survey shows corner but does not indicate what was found or set. The corner is shown:
2612 feet from the north quarter corner of Section 19**

**Surveyor's Plat Book, on Page 376 contains a survey by John Norgaard, County Surveyor, in 1916. Survey shows corner but does not indicate what was found or set. The corner is shown:
2622 feet from the north quarter corner of Section 24
2637 feet from the east quarter corner of Section 24**

The following information was obtained from the DNR Bureau of Engineering's Records:

**In 1969, corner was assumed at the intersection of the center lines of roads north, south and east. A railroad spike was set to mark this location and the following ties were taken:
nail and bottle cap, corner fence post, northeast, 46.82 feet
chiseled hole in 3 foot boulder, northwest, 37.90 feet
top center, 1" by 2" hub, southwest, 15.05 feet**

In 1973, the railroad spike that was set in 1969 was found and used as the corner.

On June 30, 1983, the DNR Bureau of Engineering traversed to the area of the corner and found the railroad spike set in 1969. Searched for but did not find any record ties.

**On June 30, 1983, the DNR Bureau of Engineering hired a backhoe operated by Larry Giese, of Porter to dig for evidence of this corner. A 5" by 5" by 7" field stone was found down 5 inches over a 9" by 10" by 8" field stone down 12 inches over a 6" by 6" cut granite stone with wood beside it down 20 inches at natural ground. The granite stone was found to be:
3.32 feet north and 0.66 of a foot west of the railroad spike
2614.19 feet from the north quarter corner of Section 19
2640.38 feet from the east quarter corner of Section 24**

Accept the granite stone as the location of the corner.

A DNR Survey Marker was set over the granite stone and the field stones were placed around it. The railroad spike was replaced with a nail.

Traverse information is available from the DNR Bureau of Engineering.

286hab/missui