

CERTIFICATE OF LOCATION OF GOVERNMENT CORNER

NORTH QUARTER Corner of Section 2, Township 115 N., Range 43 W., 5th P.M.

STATE OF MINNESOTA, County of YELLOW MEDICINE

At the corner location shown on the sketch:

- On _____ found a _____
DATE
- left monument as found, lowered monument, removed monument (explain)
- On 7-8-81 placed a 3/4" x 24" IRON ROD, DOWN 0.3'
DATE

SKETCH OF REFERENCE TIES

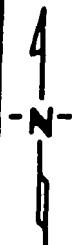

NOTE:

MONUMENT IS
ON $\frac{1}{2}$ E-W ROAD
IN LINE WITH FENCE NORTH
IN LINE WITH FENCE SOUTH

TIE TAKEN 12-11-86

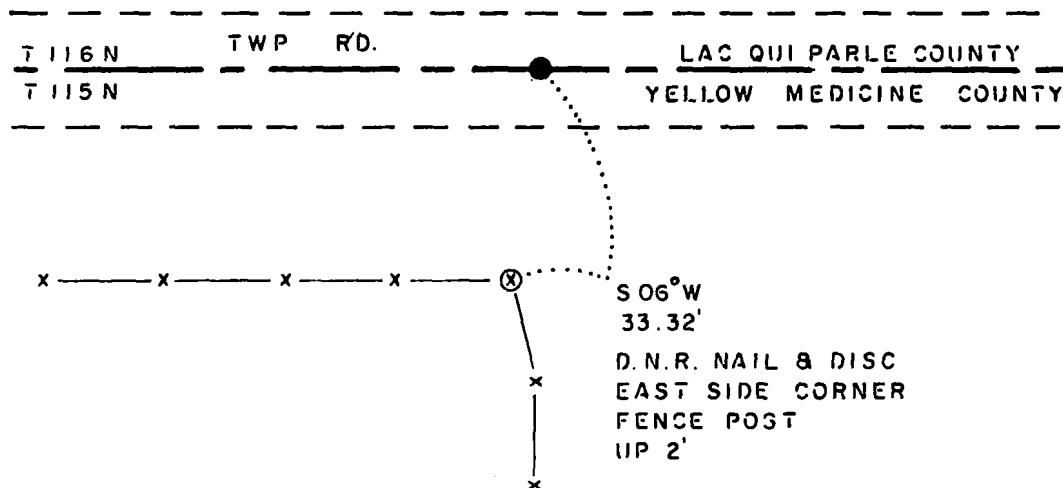

BEARING OBSERVED WITH COMPASS

Statement of evidence relative to this corner location is on back of page.

J. B. M. 3-3-87
G-879

RECORDED
GRANTED
INDEXED

I hereby certify that this document and the data contained herein was prepared by me or under my direct supervision.

Bruce W. Sheppard
SIGNATURE

3-18-87
DATE

Registration No. 17003

- Land Surveyor, Professional Engineer
- County Surveyor, County Engineer

OFFICE OF THE COUNTY RECORDER
County of Yellow Medicine

I hereby certify that this document was filed in the Co. Recorders office at 10:10 A.M. on the 20 day of March A.D., 1987

County Recorder Norman J. Opdahl

By Kay Nordahl, Deputy

DOCUMENT NO. 190306

North Quarter Corner Section 2, Township 115 North, Range 43 West

This corner was originally established by the U.S. General Land Office survey in 1858. The government notes show corner marked with a wood post and deposited coal in a mound with trench and pits as per instructions.

In March 1981, the DNR Bureau of Engineering contacted the following for corner information:

Lac Qui Parle County Offices of the Recorder and Highway Engineer
Yellow Medicine County Offices of the Recorder and Highway Engineer

The following information was obtained from the DNR Bureau of Engineering's records:

In 1963, corner was established on the center line of an east-west road in line with fences north and south. A railroad spike was set to mark this location and the following ties were:

nail and bottle cap on west side of tel. pole, southeast, 58.65 feet
nail and bottle cap on east side of corner fence post, south, 34.55 feet

On April 1, 1981, the DNR Bureau of Engineering hired a backhoe operated by Donovan Wigers of Boyd to dig for evidence of this corner. Dug a 6 foot by 8 foot by 30 inch deep hole the center being the center line of an east-west road in line with fences north and south. In digging, natural ground was found down 24 inches and no evidence of a monument was found. Searched for but did not find record ties.

Then a temporary position for corner was computed on a straight between section corners and in line with fences north and south. The temporary position was found to be:

2642.10 feet from the northeast corner of Section 2
2654.75 feet from the northeast corner of Section 3

Accept the temporary position as the location of the corner.

On December 11, 1986, revisited the corner and found the iron rod as previously set in good condition and took ties.

Traverse information is available from the DNR Bureau of Engineering.