

CERTIFICATE OF LOCATION OF GOVERNMENT CORNER

4 MEANDER Corner of Section 22, Township 114 N., Range 41 W., 5th P.M.

STATE OF MINNESOTA, County of YELLOW MEDICINE

At the corner location shown on the sketch:

On _____ found a _____
DATE

left monument as found, lowered monument, removed monument (explain)

On _____ placed a _____
DATE

SKETCH OF REFERENCE TIES

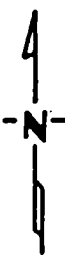

NOTE: NO MONUMENT SET
ACCESS TO CORNER
DENIED BY LANDOWNER

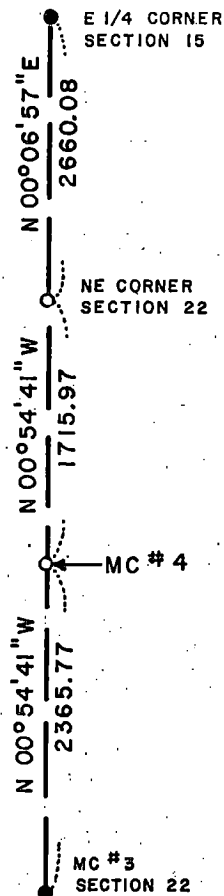

○ NO MONUMENT SET
● MONUMENT INPLACE

BEARINGS ARE ASSUMED ORIENTATION

Statement of evidence relative to this corner location is on back of page.

LRP 8-20-87
A-1105

RECORDED
GRANTOR
GRANTEE
INDEXED

I hereby certify that this document and the data contained herein was prepared by me or under my direct supervision.

Lowell B. Pannos 8-20-87
SIGNATURE DATE

Registration No. 17005
 Land Surveyor, Professional Engineer
 County Surveyor, County Engineer

OFFICE OF THE COUNTY RECORDER
County of Yellow Medicine

I hereby certify that this document was filed in the Co. Recorders office at 10:20 A.M. on the 24 day of August A.D., 19 87

County Recorder Norman J. Opdahl

By Kay Nordahl, Deputy

DOCUMENT NO. 191471

Meander Corner #4 of Section 22, Township 114 North, Range 41 West

The DNR Bureau of Engineering contacted the following offices for corner information:

Secretary of State
Yellow Medicine County Recorder
Yellow Medicine County Highway Engineer

- 1867 U.S. General Land Office notes in the Secretary of State's Office describes this corner as a set post with mound and charcoal. Government notes show corner 25.80 chains (1702.80 ft.) south of the northeast corner of Section 22.
- 1901 Surveyor's Record Book B, on page 163, from the County Recorder's Office, contains a collection of what was found at government section corners by John Norgaard, County Surveyor, in a township re-monumentation survey. This corner was found and used to proportion in other government corners. No mention is made about perpetuating this corner position, but it is shown 1712 ft. from the northeast corner of Section 22.
- 1987 April, the DNR Bureau of Engineering conducted a search for the corner but found nothing. Located the current water's edge of the lake and intersected it with the east line of Section 22. This gave a distance of 1725 ft. from the northeast corner of Section 22.

The DNR Bureau of Engineering considers this corner to be lost and re-established it using lost methods. Lost position measures 1715.97 ft. from the northeast corner of Section 22.