

23 75

Index No. _____

CERTIFICATE OF LOCATION OF GOVERNMENT CORNER

Northeast _____ Corner of Section 35, Township 115N, Range 45W, 5th P.M.

STATE OF MINNESOTA, County of Yellow Medicine

At the corner location shown on the sketch:

- On 4/04/88 found a 6"X 6" square Granite stone with two feild stones on top of it, the Granite stone is 2' below road.
 left monument as found, lowered monument, removed monument (explain)
- On 4/04/88 placed a I could not put the feild stones on top and get a pipe in so I removed them and put 1 1/4" pipe with seal on top of it. Granite Stone

SKETCH OF REFERENCE TIES

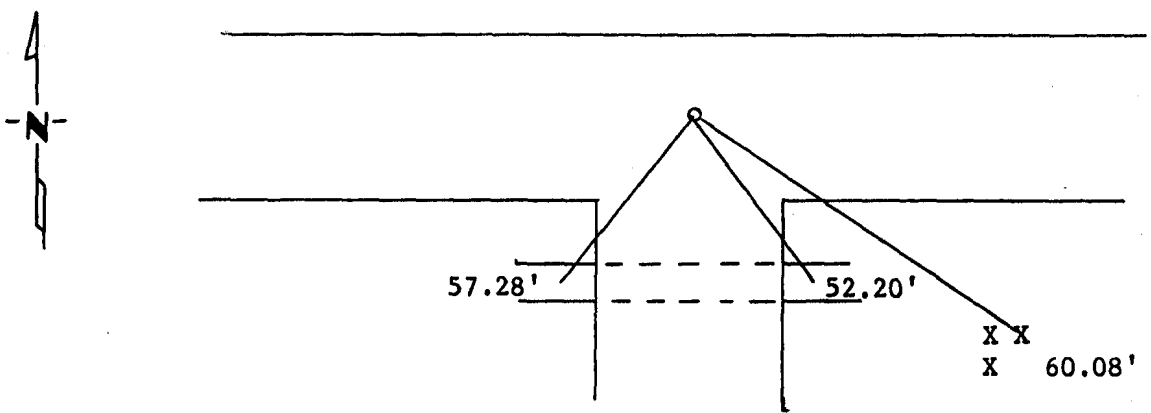

PK Nail in 18" CMP SW 57.28'
 PK Nail in 18" CMP SE 52.20'
 Nail and Seal in Fence Post SE 60.08'

Statement of evidence relative to this corner location is on back of page.

I hereby certify that this document and the data contained herein was prepared by me or under my direct supervision.

Lyle E. Mooring 2/22/1989
 SIGNATURE DATE

Registration No. 11943

- Land Surveyor, Professional Engineer
- County Surveyor, County Engineer

OFFICE OF THE COUNTY RECORDER
 County of Yellow Medicine

I hereby certify that this document was filed in the Co. Recorders office at 11:40 A.M. on the 8 day of November A.D., 1988

County Recorder Norman Opdell

By _____, Deputy

DOCUMENT NO. 196225

Statement of Evidence: