

CERTIFICATE OF LOCATION OF GOVERNMENT CORNER

NORTH QUARTER _____ Corner of Section 29, Township 114 N., Range 39 W, 5th P.M.

STATE OF MINNESOTA, County of Yellow Medicine

At the corner location shown on the sketch:

On _____ found a _____
DATE

left monument as found, lowered monument, removed monument (explain)

On June 4, 1990 placed a One inch iron pipe with seal
DATE

SKETCH OF REFERENCE TIES

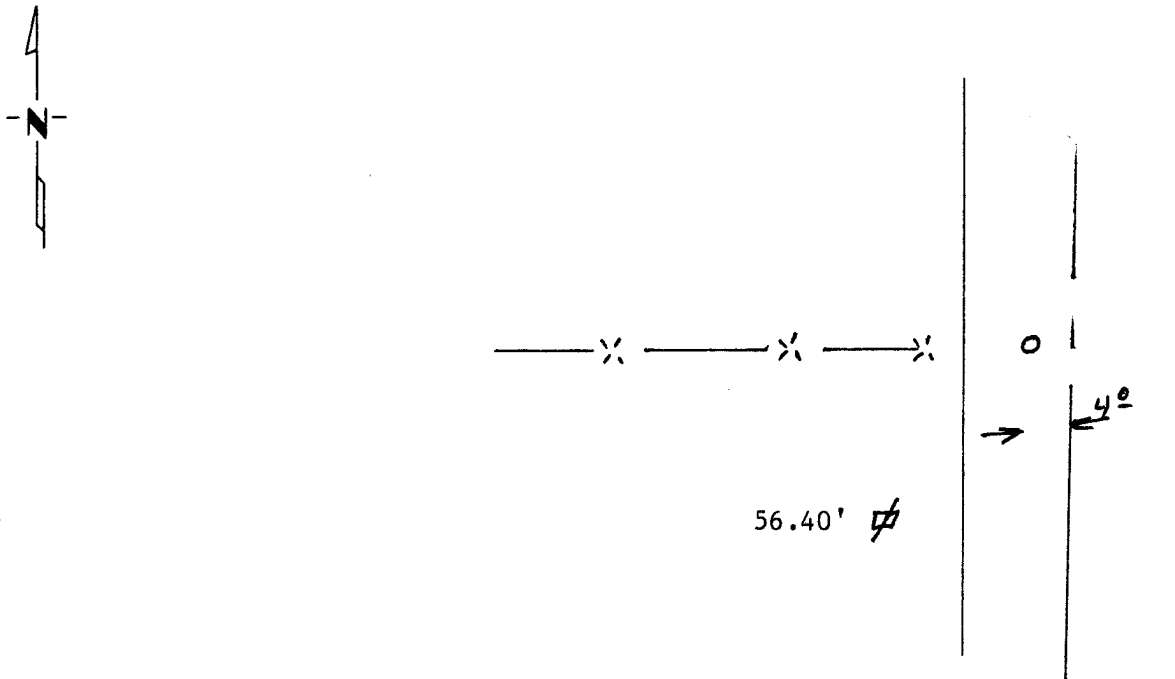

Nail and seal in Power Pole Southwest 56.40 feet.

Statement of evidence relative to this corner location is on back of page.

RECORDED	✓
GRANTOR	✓
GRANTEE	✓
INDEXED	✓

I hereby certify that this document and the data contained herein was prepared by me or under my direct supervision.

Dege E. Mooney 6-08-90
SIGNATURE DATE

Registration No. 11945

Land Surveyor, Professional Engineer

County Surveyor, County Engineer

OFFICE OF THE COUNTY RECORDER
County of Yellow Medicine

I hereby certify that this document was filed in the Co. Recorders office at 3:10 P.M. on the 13 day of February A.D., 19 91

County Recorder Norma A. Gutsch

By _____, Deputy

DOCUMENT NO. 198967

Statement of Evidence:

Original survey done in the 1860's pit and mound

I could find no record of any other surveyor.

I set the corner in line with fence to the west and section corner stone at the Northeast corner and midway between section corners. The corner is not in the middle of the road but this is a minimum maintenance road and there is a ditch along the east side.