

16-73

Index No. \_\_\_\_\_

# CERTIFICATE OF LOCATION OF GOVERNMENT CORNER

East Quarter \_\_\_\_\_ Corner of Section 30, Township 114N, Range 42W, 5th P.M.

STATE OF MINNESOTA, County of Yellow Medicine

At the corner location shown on the sketch:

On \_\_\_\_\_ found a \_\_\_\_\_  
DATE

left monument as found,  lowered monument,  removed monument (explain)

On 8/25/83 placed a Set a 5/8" rerod on line between section corners  
DATE  
and on line with East, West fences, corner fell 5.06' North of a direct split.

## SKETCH OF REFERENCE TIES

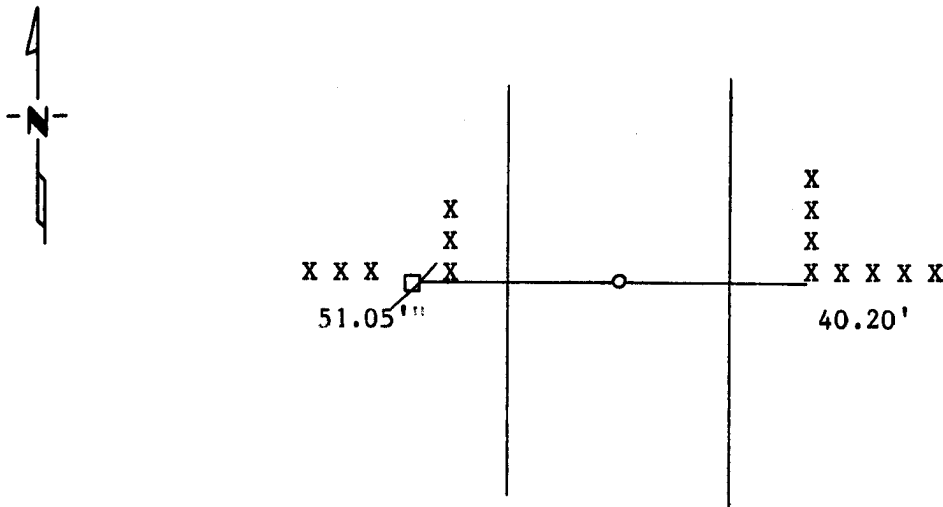

Nail and Seal in Power Pole W 51.05'  
Nail and Seal in Corner Fence Post E 40.20'

Statement of evidence relative to this corner location is on back of page.

**RECORDED**  
**GRANTOR** ✓  
**GRANTEE** ✓  
**INDEXED** ✓

I hereby certify that this document and the data contained herein was prepared by me or under my direct supervision.

Lyle E. Mow 5-17-1990  
SIGNATURE DATE

Registration No. 119430

- Land Surveyor,  Professional Engineer
- County Surveyor,  County Engineer

OFFICE OF THE COUNTY RECORDER  
County of Yellow Medicine

I hereby certify that this document was filed in the Co. Recorders office at 4:05 P. .M. on the 13 day of February A.D., 19 91

County Recorder Norma B. Spade  
By \_\_\_\_\_, Deputy

DOCUMENT NO. 198978

**Statement of Evidence:**