

CERTIFICATE OF LOCATION OF GOVERNMENT CORNER

EAST <sup>1</sup>/<sub>4</sub> Corner of Section 13, Township 115, Range 45, 5<sup>TH</sup> P.M.

STATE OF MINNESOTA, County of YELLOW MEDICINE

At the corner location shown on the sketch:

On 3/31/92 found a 2" x 2" SQUARE IRON TUBE 16" BELOW SURFACE  
PLACED 5/8" x 30" I.S. WITH RLS 6700 CAP INSIDE TUBE 3" BELOW SURFACE  
 left monument as found,  lowered monument,  removed monument (explain)

On \_\_\_\_\_ placed a \_\_\_\_\_  
DATE

SKETCH OF REFERENCE TIES

AG-LAND ENGINEERING RUTHTON, MN

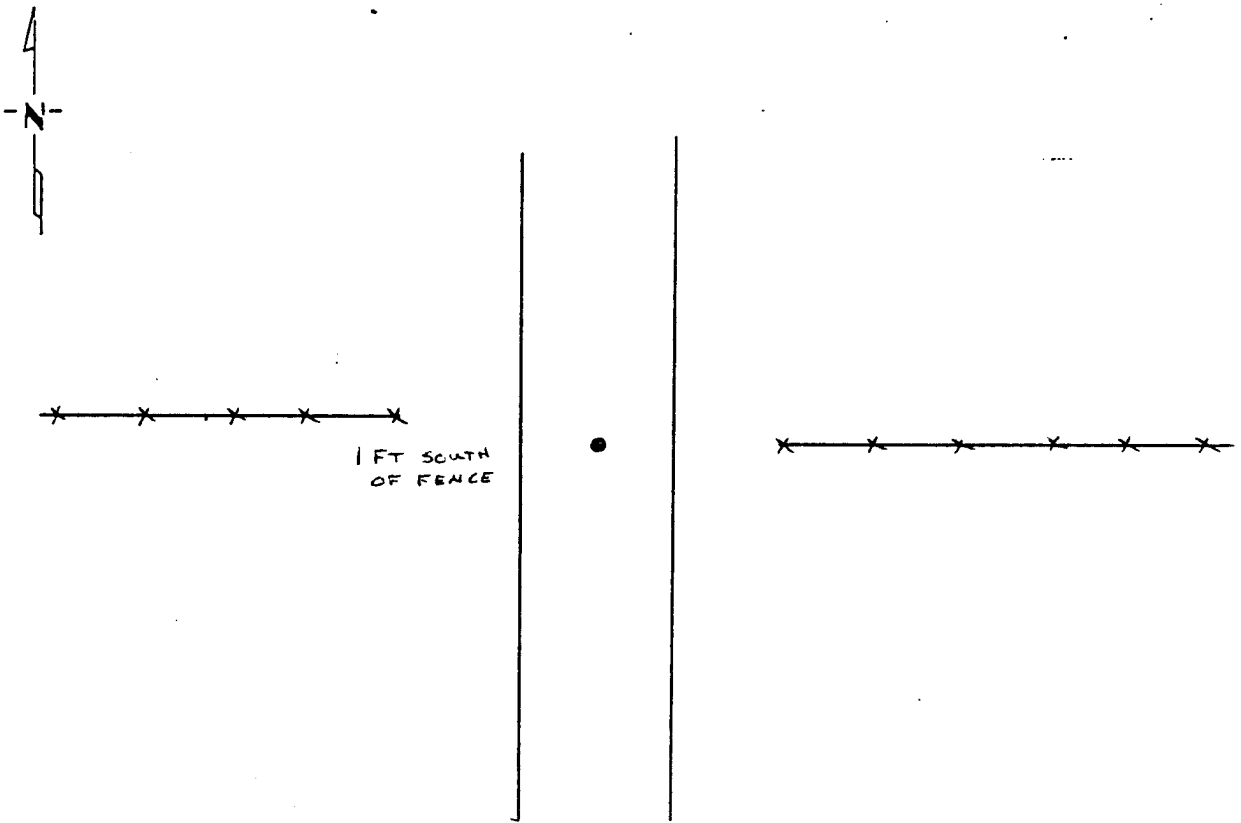

Statement of evidence relative to this corner location is on back of page.

I hereby certify that this document and the data contained herein was prepared by me or under my direct supervision.

C. Allan Bergquist 4-1-92  
SIGNATURE DATE

Registration No. 6700  
 Land Surveyor,  Professional Engineer  
 County Surveyor,  County Engineer

OFFICE OF THE COUNTY RECORDER  
County of Yellow Medicine

I hereby certify that this document was filed in the Co. Recorders office at 10:15 A.M. on the 3 day of April A.D., 19 92

County Recorder Norman J. Grotz

By \_\_\_\_\_, Deputy

DOCUMENT NO. 201587