

# CERTIFICATE OF LOCATION OF GOVERNMENT CORNER

Meander Cor. near NE Corner of Section 3, Township 114, Range 38, \_\_\_\_\_ P.M.

STATE OF MINNESOTA, County of Yellow Medicine

At the corner location shown on the sketch:

On Oct. 6, 1994 found a 2" square iron shaft (SEE BACK)  
DATE

left monument as found,  lowered monument,  removed monument (explain)

On \_\_\_\_\_ placed a \_\_\_\_\_  
DATE

### SKETCH OF REFERENCE TIES

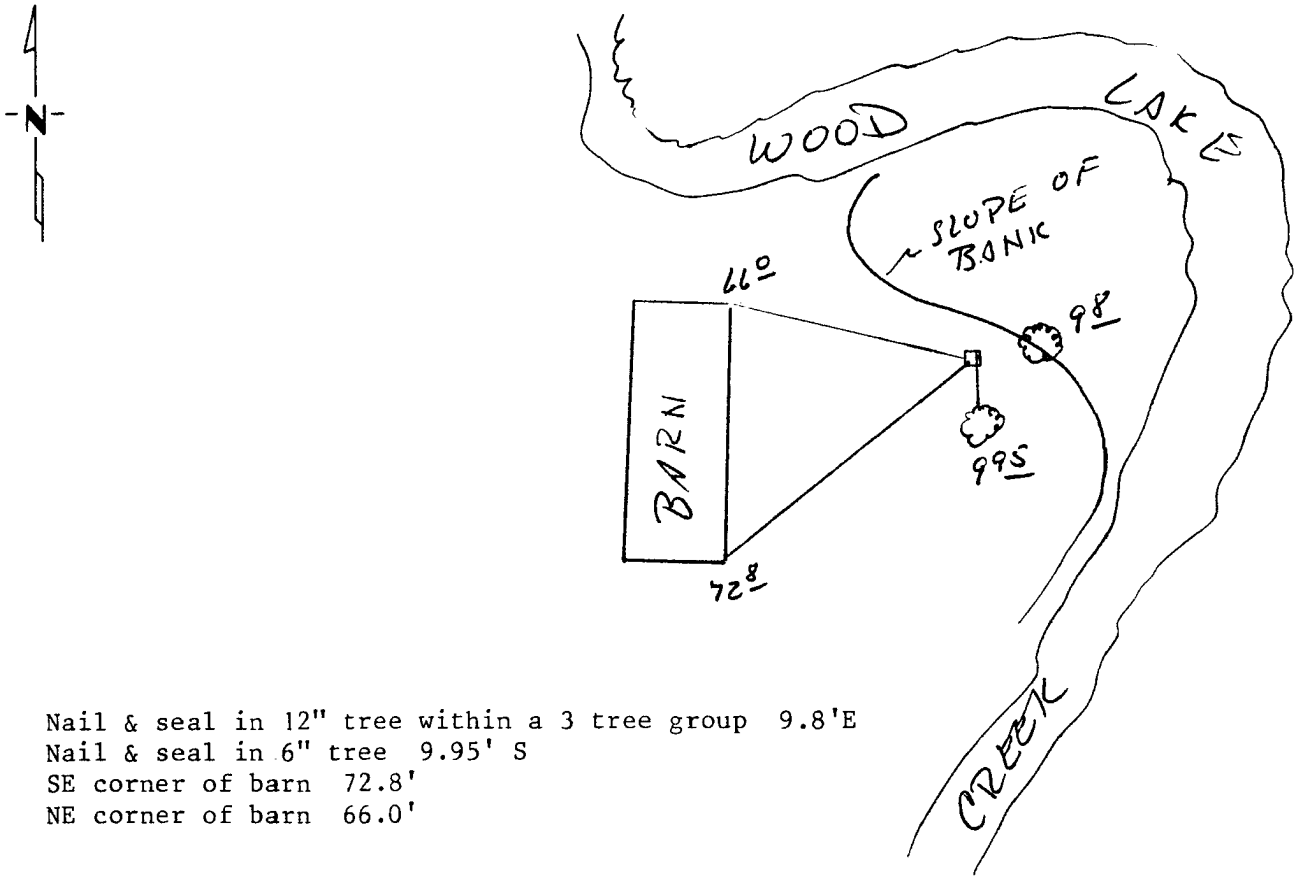

Statement of evidence relative to this corner location is on back of page.

I hereby certify that this document and the data contained herein was prepared by me or under my direct supervision.

[Signature] Feb 7-1995  
SIGNATURE DATE

Registration No. 011943

Land Surveyor,  Professional Engineer  
 County Surveyor,  County Engineer

### OFFICE OF THE COUNTY RECORDER

County of Yellow Medicine

I hereby certify that this document was filed in the Co. Recorders office at 3:35 P.M. on the 31 day of May A.D., 19 95

County Recorder [Signature]

By \_\_\_\_\_, Deputy

DOCUMENT NO. 209238

**Statement of Evidence:**

On October 6, 1994, we found a 2" square iron shaft with a 4"x4" flat top, marked "M.C." There is a 6"x4" granite stone along the south side. The corner was set by John Nordguard in 1896.

In 1911, John Nordguard set a 6"x6"x24" stone monument under the iron shaft.