

CERTIFICATE OF LOCATION OF GOVERNMENT CORNER

MILE POST #36 Corner of Section 7, Township 115 N., Range 46 W., 5th P.M.

STATE OF MINNESOTA, County of YELLOW MEDICINE

At the corner location shown on the sketch:

- On 5/9/2000 found a 6" x 6" CUT GRANITE STONE, FLUSH
DATE WITH A 1" x 12" IRON ROD ALONG ITS NORTHEAST EDGE
- left monument as found, lowered monument, removed monument (explain)
- On _____ Placed o _____
DATE

SKETCH OF REFERENCE TIES



NOTE: MONU IS
35' SOUTH OF FENCE EAST
2' SOUTH OF AN 18" x 16"
ROCK
SET STEEL FENCE POST
ALONG SOUTH SIDE OF
MONUMENT.

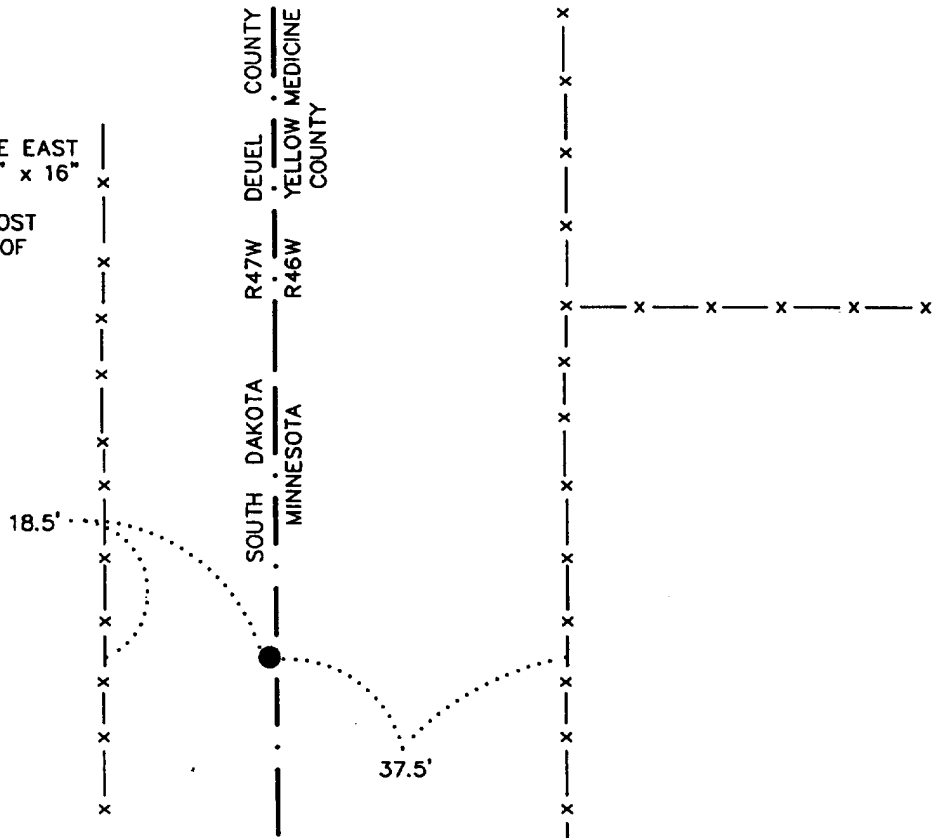

1983 YELLOW MEDICINE
COUNTY COORDINATES
(1996 ADJUSTMENT)
N= 187005.063
E= 356758.646

Statement of evidence relative to this corner location is on back of page.

6/12/2000
SNA02026

I hereby certify that this document and the data contained herein was prepared by me or under my direct supervision.

Bruce W. Stepped 10/30/00
SIGNATURE DATE

License Number 17003

- Land Surveyor, Professional Engineer
- County Surveyor, County Engineer

OFFICE OF THE COUNTY RECORDER
County of Yellow Medicine

I hereby certify that this document was filed in the Co. Recorders Office at 8:20 A.M. on the _____ day of NOV. 2 - 2000 A.D., 20__

County Recorder Kaynerdahl
By _____, Deputy
DOCUMENT NO. 224260

Mile Post Number 36 of Section 7, Township 115 North, Range 46 West

The Minnesota DNR Bureau of Engineering contacted the following for survey information:

Minnesota Secretary of State's Office

Yellow Medicine County Recorder's Office

Yellow Medicine County Highway Engineer's Office

South Dakota Historical Society's Office in Pierre

Deuel County Register of Deed's Office

1859 U. S. General Land Office notes, obtained from the South Dakota Historical Society's Office, show the corner marked with a six inch square by eight foot long wood post in a 3 ½ foot high by 5 ½ inch diameter mound with trenches 18 inches east and west. The following was marked on the wood post:

"Minnesota" on the east

"Dakota" on the west

"1859" on the south

"36M" on the north

1902 September, pages 48 and 49 of a Surveyor's Field Book, obtained from the Deuel County Register of Deed's Office, contain field notes of G.W. Carpenter's (County and Deputy State Surveyor) resurvey of all the mile posts abutting Deuel County between the states of South Dakota and Minnesota and all of the section and quarter section corners abutting and pertaining to Deuel County. The field notes state that a stone in a mound with 2 pits were found at corner. The stone was replaced with a 6 inch by 6 inch by 30 inch granite stone which was set firmly in the ground.

2000 May 10, DNR Bureau of Engineering traversed to the area of the corner and found a 6 inch by 6 inch cut granite stone flush with the ground with a 1 inch by 12 inch iron rod along its northeast edge. The cut granite stone was found to be:

18.5 feet east of a north-south fence

5283.96 feet from Mile Post Number 37

Analysis of the above information led the DNR Bureau of Engineering to conclude that the found 6 inch by 6 inch cut granite stone marks the original location of the corner.