

CERTIFICATE OF LOCATION OF GOVERNMENT CORNER

NORTH QUARTER Corner of Section 18, Township 115 N., Range 46 W., 5th P.M.

STATE OF MINNESOTA, County of YELLOW MEDICINE

At the corner location shown on the sketch:

- On _____ found a _____
DATE
- left monument as found, lowered monument, removed monument (explain)
- On 5/17/2000 Placed a 3/4" x 24" REBAR WITH ALUMINUM CAP STAMPED
DATE
"DNR SURVEY MARKER", DOWN 0.3'

SKETCH OF REFERENCE TIES

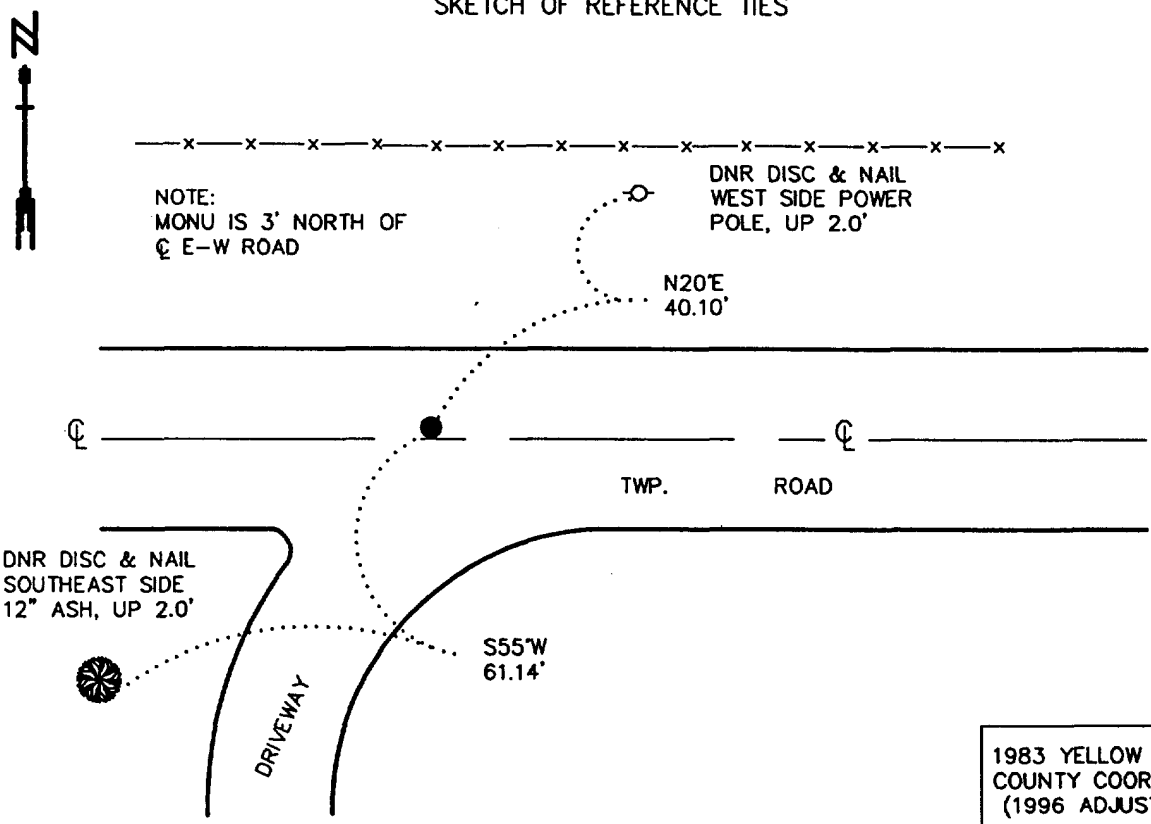

NOTE:
MONU IS 3' NORTH OF
C E-W ROAD

DNR DISC & NAIL
WEST SIDE POWER
POLE, UP 2.0'

N20°E
40.10'

TWP. ROAD

DNR DISC & NAIL
SOUTHEAST SIDE,
12" ASH, UP 2.0'

S55°W
61.14'

DRIVEWAY

1983 YELLOW MEDICINE
COUNTY COORDINATES
(1996 ADJUSTMENT)

N= 186083.368
E= 357015.372

BEARINGS OBSERVED WITH COMPASS

Statement of evidence relative to this corner location is on back of page.

6/12/2000
SNA02026

I hereby certify that this document and the data contained herein was prepared by me or under my direct supervision.

Bruce W. Steppud 10/30/00
SIGNATURE DATE

License Number 17003

Land Surveyor, Professional Engineer
 County Surveyor, County Engineer

OFFICE OF THE COUNTY RECORDER
County of Yellow Medicine

I hereby certify that this document was filed in the Co. Recorders Office at 9:15 A.M. on the _____ day of NOV. 2 - 2000 A.D., 20____

County Recorder Kay Nordahl
By _____, Deputy

DOCUMENT NO. 224271

North Quarter Corner of Section 18, Township 115 North, Range 46 West

The Minnesota DNR Bureau of Engineering contacted the following for survey information:

Minnesota Secretary of State's Office

Yellow Medicine County Recorder's Office

Yellow Medicine County Highway Engineer's Office

- 1871 U. S. General Land Office notes, obtained from the Secretary of State's Office, show the corner marked with a wood post in a raised mound as per instructions. The corner is shown:
40.00 chains (2640.00 feet) from the northeast corner of Section 18
3.88 chains (256.08 feet) from the closing corner to the northwest corner of Section 18

No resurvey information was obtained for this corner.

- 2000 May 17, DNR Bureau of Engineering traversed to the area of corner and found its location to be on an east-west Township Road. Did not excavate area of corner in search of a monument because no records of a monument being set at corner since the GLO survey was found.

Computed a position for corner as follows:

A) on line between found cut granite stones at the northeast corner of Section 18 and the closing corner to the northwest corner of Section 18

B) proportional measurement per GLO distances from found cut granite stones at the northeast corner of Section 18 and the closing corner to the northwest corner of Section 18

The computed position for corner was found to be:

3 feet north of the center line of the east-west Township Road

2639.80 feet from the northeast corner of Section 18

256.06 feet from the closing corner to the northwest corner of Section 18

Analysis of the above information led the DNR Bureau of Engineering to conclude that the computed position for corner on line and proportional distance from found cut granite stones at the northeast corner of Section 18 and the closing corner to the northwest corner of Section 18 marks the location of the corner. Set a 3/4 inch by 24 inch rebar with an aluminum cap stamped "DNR SURVEY MARKER" at the computed position for corner.