

CERTIFICATE OF LOCATION OF GOVERNMENT CORNER

Northeast Corner of Section 29, Township 114, Range 45, 5th P.M.

STATE OF MINNESOTA, County of Yellow Medicine

At the corner location shown on the sketch:

- On 6-29-2000 found a Moseng Land Surveying dug with jackhammer and found
DATE
a 1/2 inch iron pipe 6 inches long over a field stone
 left monument as found, lowered monument, removed monument (explain)
- On 6-29-2000 placed Iron rerods around it and set a 5/8" rerod with seal at
DATE
the road surface

SKETCH OF REFERENCE TIES

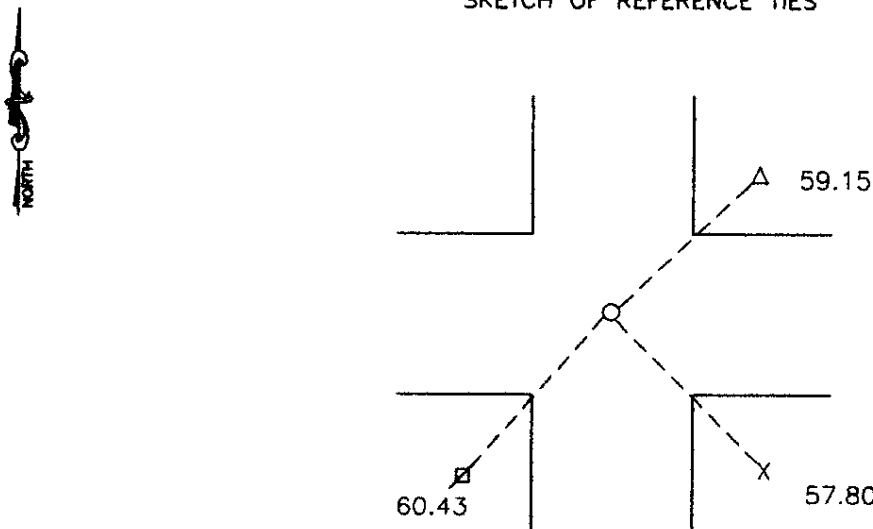

Top center of telephone pedestal 59.15 North east

Nail and seal in top of corner fence post which is cut off 57.80 South east

Nail and seal in power pole 60.43 South west

Statement of evidence relative to this corner location is on back of page.

I hereby certify that this document and the data contained herein was prepared by me or under my direct supervision.

Lyle C Moseng 11-07-00
SIGNATURE DATE

Registration No. 11943

- Land Surveyor, Professional Engineer
- County Surveyor, County Engineer

OFFICE OF THE COUNTY RECORDER
 County of

I hereby certify that this document was filed in the Co. Recorders office at 10:25 A.M on the 21st day of December A.D. 2000

County Recorder Kay Nerdahl

By Jail Rohlik, Deputy

DOCUMENT NO. 224802

N/C Lyle Moseng, 703 Lawrence St.
 Mshil. 56258

Statement of Evidence

In 1916 surveyer John Norgaard used this corner.

In 1923 a stone was set (no name listed in county records.)

On 6-29-2000 Moseng Land Surveying found a 1/2 inch iron pipe 6 inches long over a field stone. Iron rerods were set around stone and a 5/8" rerod with seal #11943 was set at road surface.