

CERTIFICATE OF LOCATION OF GOVERNMENT CORNER

North Quarter Corner of Section 36, Township 114, Range 40, 5th P.M.

STATE OF MINNESOTA, County of Yellow Medicine

At the corner location shown on the sketch:

- On _____ found a _____
- left monument as found, lowered monument, removed monument (explain)
- On 8-16-2001 placed a 5/8" iron with seal #11943 midway and on line.

SKETCH OF REFERENCE TIES

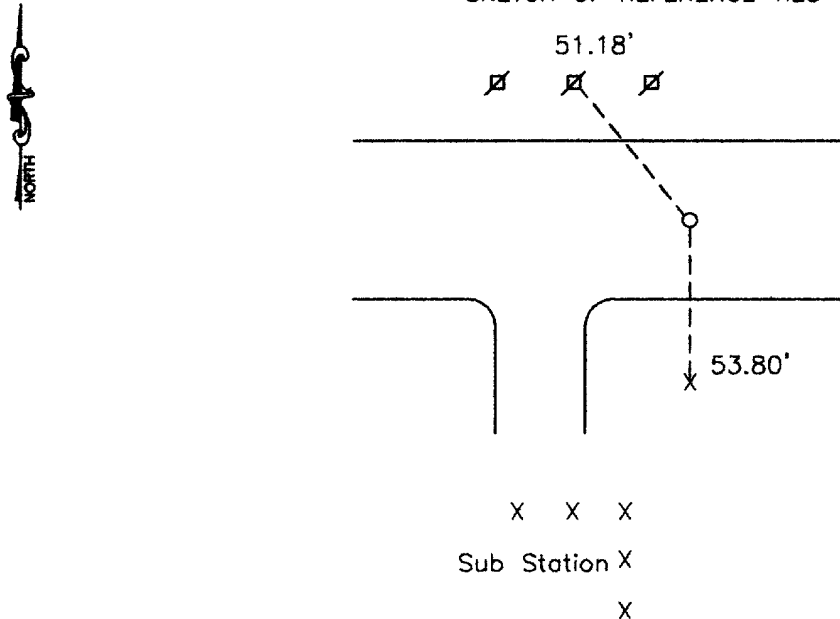

Nail and seal in power pole Northwest 51.18'
Nail and seal in top of fence post South 53.80'

Statement of evidence relative to this corner location is on back of page.

I hereby certify that this document and the data contained herein was prepared by me or under my direct supervision.

Lytle E. Moore 5-10-02
SIGNATURE DATE

Registration No. 11943

- Land Surveyor, Professional Engineer
- County Surveyor, County Engineer

OFFICE OF THE COUNTY RECORDER

County of Yellow Medicine

I hereby certify that this document was filed in the Co. Recorders office at 3:45 P.M. on the 4th day of October A.D. ~~19~~ 2002

County Recorder Kay Nerdahl

By *Debra Blood* 230060, Deputy

DOCUMENT NO. _____

Statement of Evidence

On August 16, 2001 Moseng Land Surveying set a 5/8" iron with seal #11943 on line and midway between section corners. Fell in line with fence/field line to the South.