

CERTIFICATE OF LOCATION OF GOVERNMENT CORNER

Northeast Corner of Section 21, Township 114, Range 45, 5th P.M.

STATE OF MINNESOTA, County of Yellow Medicine

At the corner location shown on the sketch:

- On 2-27-2003 found a Railroad spike 3" below road surface. Approximately
DATE
0.90 feet East of the centerline of Highway 75.
- left monument as found, lowered monument, removed monument (explain)
- On 2-27-2003 placed a 5/8" rerod with seal #11943 over railroad spike.
DATE

SKETCH OF REFERENCE TIES

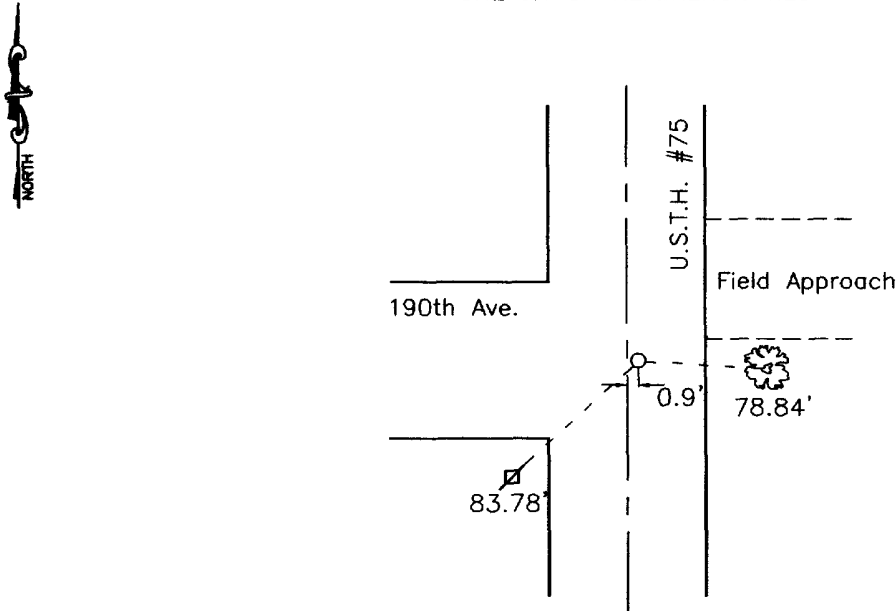

Nail and seal in power pole Southwest 83.78'
 Nail and seal in tree East 78.84'

Statement of evidence relative to this corner location is on back of page.

I hereby certify that this document and the data contained herein was prepared by me or under my direct supervision.

Lyle E. Messing 3-20-03
SIGNATURE DATE
 Registration No. 11943

- Land Surveyor, Professional Engineer
- County Surveyor, County Engineer

OFFICE OF THE COUNTY RECORDER
 County of YELLOW MEDICINE

I hereby certify that this document was filed in the Co. Recorders office at 9:55 A.M on the 9th day of March, 2004 A.D. 19/

County Recorder Kay Zempel
 By Debra Blood, Deputy

DOCUMENT NO. 234628

N/c Rec'd. From Lyle Messing, Marshall

Statement of Evidence

On February 27, 2003 Moseng Land Surveying found a railroad spike 3" below the surface of the road and approximately 0.90 feet East of the centerline of road. We set a 5/8" rerod with seal #11943 over the railroad spike.