

CERTIFICATE OF LOCATION OF GOVERNMENT CORNER

Northeast Corner of Section 8, Township 114, Range 45, 5th P.M.

STATE OF MINNESOTA, County of Yellow Medicine

At the corner location shown on the sketch:

On May 3, 2004 found a 2 1/2" P.K. nail set by the County Highway Department

left monument as found, lowered monument, removed monument (explain)

On May 3, 2004 placed a 5/8" iron w/seal #11943 in place of the P.K. nail

SKETCH OF REFERENCE TIES X

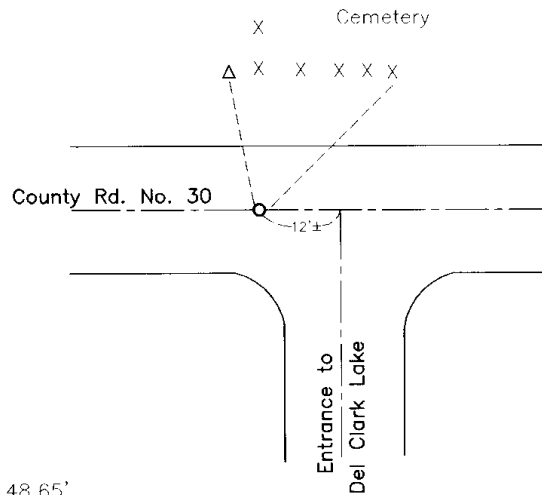

Minnesota State Plane Coordinate System Yellow Medicine County Datum

N: 159172.135
E: 396726.990

Nail & seal in Telephone Pedestal N 48.65'
Nail & seal in bottom of 4th wooden post NE 64.10'

Statement of evidence relative to this corner location is on back of page.

I hereby certify that this document and the data contained herein was prepared by me or under my direct supervision.

Lyle C. Moring 5-20-04
SIGNATURE DATE

Registration No. 11943

Land Surveyor, Professional Engineer
 County Surveyor, County Engineer

OFFICE OF THE COUNTY RECORDER

County of _____

I hereby certify that this document was filed in the Co. Recorders office at _____ M on the _____ day of _____ A.D. 20 _____

County Recorder _____

By _____, Deputy

DOCUMENT NO. _____

Statement of Evidence

In 1994 the Yellow Medicine County Highway Department found a 1" iron pipe. After upgrading the road they repalced with 2½" P.K. nail.

On May 3, 2004, Moseng Land Surveying, found 2½" P.K. nail. Replaced nail with a 5/8" iron stake with seal #11943.

Doc# 237025 Fee: \$.00 2 Pages
Office of County Recorder, Yellow Medicine County, Minnesota
I hereby certify that the within instrument was
filed on January 7, 2005 at 03:35 PM

Kay Zempel, Yellow Medicine County Recorder
BY Jane Kullik Deputy