

# CERTIFICATE OF LOCATION OF GOVERNMENT CORNER

NORTHEAST Corner of Section 36, Township 115, Range 41, 5th P.M.

STATE OF MINNESOTA, County of YELLOW MEDICINE

At the corner location shown on the sketch:

- On \_\_\_\_\_ found a \_\_\_\_\_  
DATE
- left monument as found,  lowered monument,  removed monument (explain)
- On 6-20-2005 placed a 1 1/2" IRON PIPE WITH SEAL AT ROAD SURFACE  
DATE

### SKETCH OF REFERENCE TIES

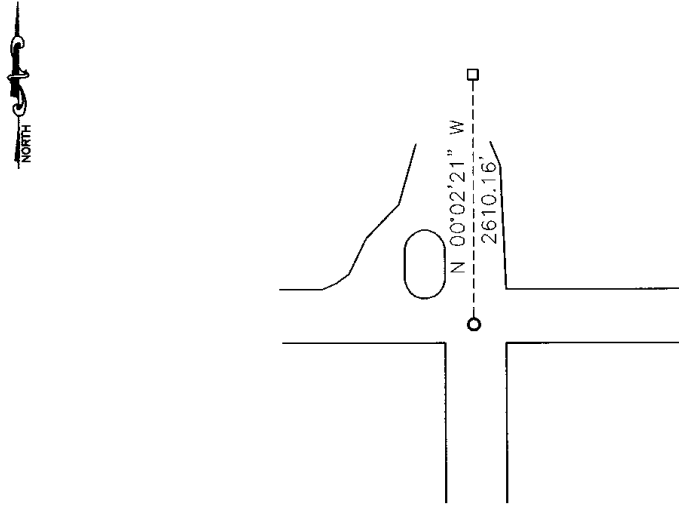

Statement of evidence relative to this corner location is on back of page.

I hereby certify that this document and the data contained herein was prepared by me or under my direct supervision.

Ryle E. Moring 12-16-05  
SIGNATURE DATE  
Registration No. 11943

- Land Surveyor,  Professional Engineer
- County Surveyor,  County Engineer

OFFICE OF THE COUNTY RECORDER  
County of \_\_\_\_\_

I hereby certify that this document was filed in the Co. Recorders office at \_\_\_\_\_ .M on the \_\_\_\_\_ day of \_\_\_\_\_ A.D. 20 \_\_\_\_\_

County Recorder \_\_\_\_\_  
By \_\_\_\_\_, Deputy  
DOCUMENT NO. \_\_\_\_\_

Statement of Evidence

John Norgaard set a 6" X 6" X 2' long granite stone at section corner between May 1899 & September 1901.

1941 - Corner was recorded as a large red stone.

On June 20, 2005 Bueltel-Moseng Land Surveying set a 1 1/2" iron pipe with seal at road surface after digging with a backhoe (Jeseritz Construction), and finding nothing.

N/c Lyle Moseng  
703 Lawrence St  
Marshall MN  
56258

Doc# 239634 Fee: \$.00 2 Pages

Office of County Recorder  
Yellow Medicine County, Minnesota  
I hereby certify that the within instrument  
was filed on December 20, 2005 at 10:25 AM

Kay Zempel, Yellow Medicine County Recorder

BY Kay Zempel Deputy