

CERTIFICATE OF LOCATION OF GOVERNMENT CORNER

NORTH QUARTER Corner of Section 29, Township 115, Range 44, 5TH P.M.

STATE OF MINNESOTA, County of YELLOW MEDICINE

At the corner location shown on the sketch:

On 03-27-2000 found a OLD WOOD STAKE
DATE

left monument as found, lowered monument, removed monument (explain)

On 03-27-2000 placed a 1" IRON PIPE WITH SEAL #11943.
DATE

SKETCH OF REFERENCE TIES

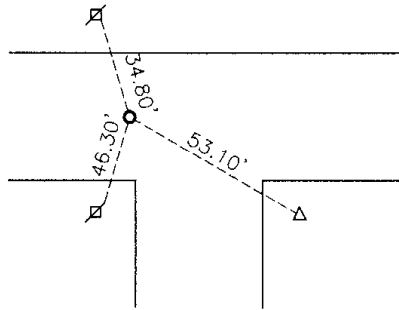

Nail and seal in power pole NNW 34.80'
Nail and seal in power pole SSW 46.30'
Top center of pedestal SE 53.10'

Statement of evidence relative to this corner location is on back of page.

I hereby certify that this document and the data contained herein was prepared by me or under my direct supervision.

Kyle E. Manning 1-16-06
SIGNATURE DATE

Registration No. 11943

Land Surveyor, Professional Engineer
 County Surveyor, County Engineer

OFFICE OF THE COUNTY RECORDER

County of _____

I hereby certify that this document was filed in the Co. Recorders office at _____ .M on the _____ day of _____ A.D. 20 _____

County Recorder _____

By _____, Deputy

DOCUMENT NO. _____

Statement of Evidence

In 1871, L. Harrington did the original subdivision of the township.

On March 27, 2000 Moseng Land Surveying dug with a back hoe (Kockelman Construction) midway and in center of the road. Evidence of a wood stake was found, nothing else was found. Also dug in center of the east-west road and the road to the south, nothing was found. Held to the stake and placed a 1" iron pipe with seal #11943 over it.

Doc# 240409 Fee: \$ 2 Pages

Office of County Recorder
Yellow Medicine County, Minnesota
I hereby certify that the within instrument
was filed on April 12, 2006 at 10:05 AM

Kay Zempel, Yellow Medicine County Recorder

BY Jail Rohlik Deputy

N/C
Bueltel-Moseng Land Surveying
P.O. Box 32
Marshall, MN 56258