

CERTIFICATE OF LOCATION OF GOVERNMENT CORNER

NORTH QUARTER Corner of Section 30, Township 114, Range 45, 5TH P.M.

STATE OF MINNESOTA, County of YELLOW MEDICINE

At the corner location shown on the sketch:

On 3-22-2000 found a 4 SPIKES AND PART OF A LATH.
DATE

left monument as found, lowered monument, removed monument (explain)

On 3-22-2000 placed a 5/8" IRON WITH SEAL #11943 AFTER DIGGING BY HAND
DATE AND FINDING NOTHING ELSE.

SKETCH OF REFERENCE TIES

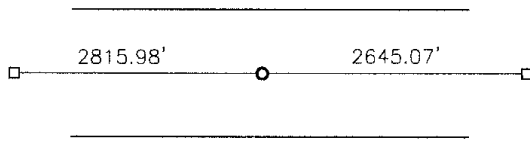

Statement of evidence relative to this corner location is on back of page.

I hereby certify that this document and the data contained herein was prepared by me or under my direct supervision.

Lyle E Mosing 1-16-06
SIGNATURE DATE

Registration No. 11943

Land Surveyor, Professional Engineer
 County Surveyor, County Engineer

OFFICE OF THE COUNTY RECORDER
County of _____

I hereby certify that this document was filed in the Co. Recorders office at _____ .M on the _____ day of _____ A.D. 20 _____

County Recorder _____

By _____, Deputy

DOCUMENT NO. _____

Statement of Evidence

In 1871, the original pit and mound corner was set by L. Harrington.

On March 28, 2000 Moseng Land Surveying found 4 spikes and part of a lath. The total mile as recorded was 5462.82', the mile measured is 5461.05'. A $\frac{5}{8}$ " iron with seal #11943 was set at the corner.

From the Northeast corner to the North Quarter corner

$\frac{2640}{5462.82'}$ $\frac{x=2639.14}{5461.05'}$ We measured 2645.07'.

Doc# 240410 Fee: \$.00 2 Pages

Office of County Recorder
Yellow Medicine County, Minnesota
I hereby certify that the within instrument
was filed on April 12, 2006 at 10:10 AM

Kay Zempel, Yellow Medicine County Recorder

BY *Dail Rohlik* Deputy

N/C
Bueltel-Moseng Land Surveying
P.O. Box 32
Marshall, MN 56258