

# CERTIFICATE OF LOCATION OF GOVERNMENT CORNER

NORTH QUARTER Corner of Section 28, Township 113, Range 39, 5TH P.M.

STATE OF MINNESOTA, County of YELLOW MEDICINE

At the corner location shown on the sketch:

- On \_\_\_\_\_ found a \_\_\_\_\_  
DATE
- left monument as found,  lowered monument,  removed monument (explain)
- On 11-10-2006 placed a 1" PIPE WITH SEAL #43844  
DATE

### SKETCH OF REFERENCE TIES

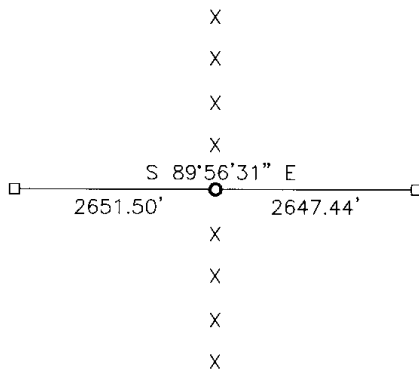

Minnesota State Plane Coordinate  
 System Yellow Medicine County Datum  
 NAD83 (1996)  
 N: 110893.127  
 E: 510134.667

Statement of evidence relative to this corner location is on back of page.

I hereby certify that this document and the data contained herein was prepared by me or under my direct supervision.

*[Signature]* 2/16/07  
 SIGNATURE DATE

Registration No. 43844

- Land Surveyor,  Professional Engineer
- County Surveyor,  County Engineer

### OFFICE OF THE COUNTY RECORDER

County of \_\_\_\_\_  
 I hereby certify that this document was filed in the Co. Recorders office at \_\_\_\_\_ M on the \_\_\_\_\_ day of \_\_\_\_\_ A.D. 20 \_\_\_\_\_

County Recorder \_\_\_\_\_

By \_\_\_\_\_, Deputy

DOCUMENT NO. \_\_\_\_\_

Statement of Evidence

In 1864, Chas E Davis and J. W. Webber, Jr. did the original subdivision of the township.

On November 10, 2006, Bueltel-Moseng Land Surveying set a 1" pipe with seal #43844 on line between section corners and in line with fences to the north and south.

Doc# 244526 Fee: \$0.00 2 Pages

Office of County Recorder  
Yellow Medicine County, Minnesota  
I hereby certify that the within instrument  
was filed on December 7, 2007 at 02:00 PM

Kay Zempel, Yellow Medicine County Recorder

BY Debra Blod Deputy

N/C Bueltel - Moseng Land Surveying  
Lyle Moseng  
P.O. Box 32  
Mahl. 56258