

Office of County Recorder
Yellow Medicine County, Minnesota
I hereby certify that the within instrument
was filed on May 20, 2009 at 10:35 AM

Kay Zempel, Yellow Medicine County Recorder

By Heidi J. Bakken Deputy

N/C Bruce W. Shepperd, LS
Minnesota Dept. of Natural Resources
500 Lafayette Road
St. Paul, MN 55155-4045

Index No. GH-21

CERTIFICATE OF LOCATION OF GOVERNMENT CORNER

NUMBER 6 MEANDER Corner of Section 11 Township 116 N Range 40 W
5th Principal Meridian, State of Minnesota, County of YELLOW MEDICINE

At the corner location shown on the sketch:

- On _____ found a _____
DATE
- left monument as found, lowered monument, removed monument (explain)
- On 10/9/08 Placed a 3/4" X 24" REBAR WITH PLASTIC CAP STAMPED
DATE
"MN DNR LS 17003". FLUSH

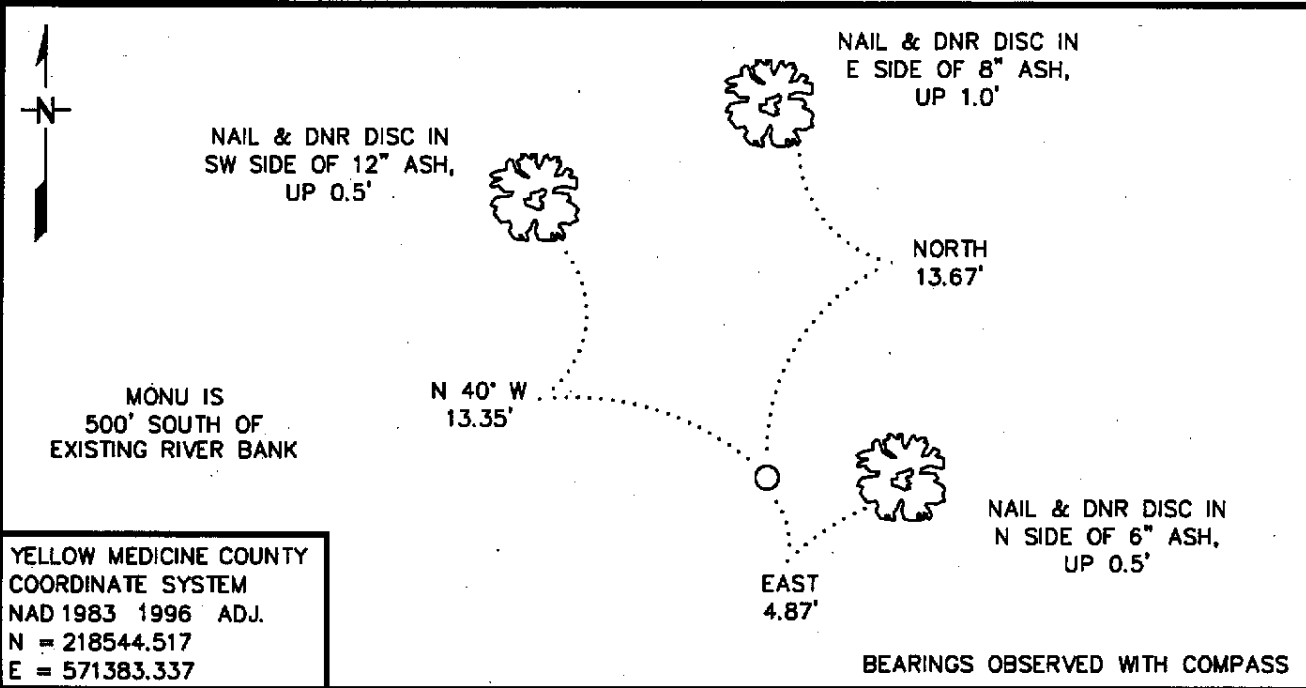

YELLOW MEDICINE COUNTY
COORDINATE SYSTEM
NAD 1983 1996 ADJ.
N = 218544.517
E = 571383.337

BEARINGS OBSERVED WITH COMPASS

Statement of evidence for this corner location is on back of this page. 5/12/09
NPB00050.00.00.01

I certify that this document was researched and prepared by me or under my direct supervision.

SIGNATURE Bruce W. Shepperd DATE 05/10/09 License Number 17003
Title: Land Surveyor Professional Engineer County Surveyor County Engineer

Meander Corner Number 6 of Section 11, Township 116 North, Range 40 West

The DNR Division of Lands and Minerals contacted the following for survey information:

Minnesota Secretary of State's Office
Chippewa County Recorder's Office
Yellow Medicine County Recorder's Office
Yellow Medicine County Highway Engineer's Office
Montevideo City Engineer's Office
MNDOT Offices in St. Paul and Willmar
Rodeberg and Berryman Consulting Engineers of Montevideo
Bonnema Surveys Inc. of Willmar
Bueltel Moseng of Marshall

1865 U.S. General Land Office notes, obtained from the Secretary of State's Office, show the corner marked with a wood post with the following bearing trees:

5" Elm, East 2.37 chains (156.42 feet)

5" Elm, North $80\frac{3}{4}^{\circ}$ West, 3.67 chains (242.22 feet)

The corner is shown:

21.20 chains (1399.20 feet) from the southeast corner of Section 11

The notes also show that a line north of this meander corner was not measured.

No resurvey information was obtained for this corner.

2007 November, the DNR Division of Lands and Minerals determined that no occupation lines exist north of the southeast corner of Section 11.

When no evidence of the corner is found it's considered lost, and according to the Manual of Instructions for the Survey of the Public Land of the United States, 1973, prepared by the Bureau of Land Management, U.S. Dept. of the Interior, in Chapter 5-45 which states: "Where a line has been terminated with measurement in one direction only, a lost corner will be restored by record bearing and distance, counting from the nearest regular corner, the latter having been duly identified or restored."

Then the lost position for the meander corner was computed on a solar bearing north of the southeast corner of Section 11 at the GLO distance of 1399.20 feet from the southeast corner of Section 11. A field search was conducted at the computed lost position for evidence of the GLO bearing trees but found no evidence of them.

Analysis of the available information led the DNR Division of Lands and Minerals to conclude that the computed lost position for corner marks its location.