

CERTIFICATE OF LOCATION OF GOVERNMENT CORNER

EAST QUARTER Corner of Section 12, Township 114, Range 40, 5TH P.M.

STATE OF MINNESOTA, County of YELLOW MEDICINE

At the corner location shown on the sketch:

On 07-03-2008 found a BROKE OFF MNDOT CAST IRON MONUMENT

left monument as found, lowered monument, removed monument (explain)

On _____ placed a _____

SKETCH OF REFERENCE TIES

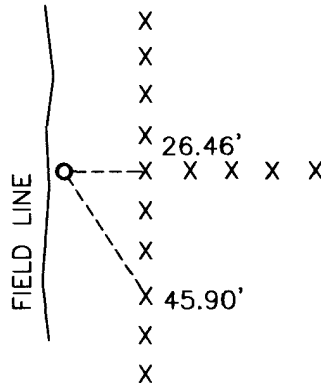

Minnesota State Plane Coordinate
System Yellow Medicine County Datum
NAD83 (1996)

N: 156208.051
E: 576925.085

Nail and seal in wood corner fence post East 26.46'
Nail and seal in wood fence post SE 45.90'

Statement of evidence relative to this corner location is on back of page.

I hereby certify that this document and the data contained herein was prepared by me or under my direct supervision.

[Signature] 3/3/09
SIGNATURE DATE

Registration No. 43844

Land Surveyor, Professional Engineer
 County Surveyor, County Engineer

OFFICE OF THE COUNTY RECORDER

County of _____

I hereby certify that this document was filed in the Co. Recorders office at _____ .M on the _____ day of _____ A.D. 20 _____

County Recorder _____

By _____, Deputy

DOCUMENT NO. _____

Statement of Evidence

In 1858, W. J. Neely did the original survey of the east township line.

On June 3, 1973, MNDot set a cast iron monument over a $\frac{3}{4}$ " X 24" iron pin.

On July 3, 2008, Bueltel-Moseng Land Surveying found a recorded broken off MNDot cast iron monument 1' below the surface an the east edge of the field.

Doc# 249391 Fee: \$0.00 2 Pages

Office of County Recorder

Yellow Medicine County, Minnesota

I hereby certify that the within instrument
was filed on November 25, 2009 at 9:55 AM

Kay Zempel, Yellow Medicine County Recorder

By Kay Zempel ~~Deputy~~

N/c - Bueltel-Moseng Land Surveying
P.O. Box 32
Muhl. 56258