

# CERTIFICATE OF LOCATION OF GOVERNMENT CORNER

NORTHEAST of Section 30, Township 113, Range 38, 5TH P.M.

STATE OF MINNESOTA, County of YELLOW MEDICINE

At the corner location shown on the sketch:

On 10-09-2009 found a STONE  
DATE

left monument as found,  lowered monument,  removed monument (explain)

On 10-09-2009 placed a 1" PIPE WITH SEAL #43844  
DATE

### SKETCH OF REFERENCE TIES

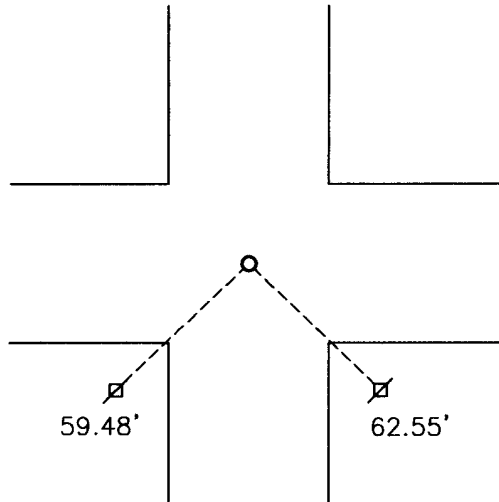

Minnesota State Plane Coordinate  
System Yellow Medicine County Datum  
NAD83 (1996)  
N: 110965.882  
E: 614188.442

Nail and survey marker in power pole SW 59.48'  
Nail and survey marker in power pole SE 62.55'

Statement of evidence relative to this corner location is on back of page.

I hereby certify that this document and the data contained herein was prepared by me or under my direct supervision.

  
SIGNATURE

2/9/2010  
DATE

Registration No. 43844

Land Surveyor,  Professional Engineer  
 County Surveyor,  County Engineer

OFFICE OF THE COUNTY RECORDER

County of \_\_\_\_\_

I hereby certify that this document was filed in the Co. Recorders office at \_\_\_\_\_ .M on the \_\_\_\_\_ day of \_\_\_\_\_ A.D. 20 \_\_\_\_\_

County Recorder \_\_\_\_\_

By \_\_\_\_\_, Deputy

DOCUMENT NO. \_\_\_\_\_

Statement of Evidence

In 1864, C. E. Davis and J. W. Webb, Jr., did the original subdivision of the township.

The Yellow Medicine Highway Department recorded ties to the corner.

On October 9, 2009, Bueltel-Moseng Land Surveying dug with a backhoe and found a 15" field stone 3'± below the surface of the road. We set a  $\frac{5}{8}$ " iron on the east side of the stone and a 1" pipe with seal #43844 over the stone.

Doc# 250210 Fee: \$0.00 2 Pages

Office of County Recorder

Yellow Medicine County, Minnesota

I hereby certify that the within instrument  
was filed on April 14, 2010 at 8:35 AM

N/C

**Bueltel-Moseng Land Surveying**

**P. O. Box 32**

**Marshall, MN 56258**

Kay Zempel, Yellow Medicine County Recorder

By Kay Zempel Deputy