

CERTIFICATE OF LOCATION OF GOVERNMENT CORNER

NORTHEAST Corner of Section 2, Township 113, Range 39, 5TH P.M.

STATE OF MINNESOTA, County of YELLOW MEDICINE

At the corner location shown on the sketch:

On 05-14-2010 found a BRIDGE SPIKE
DATE

left monument as found, lowered monument, removed monument (explain)

On 05-14-2010 placed a 5/8" IRON WITH SEAL #43844
DATE

SKETCH OF REFERENCE TIES

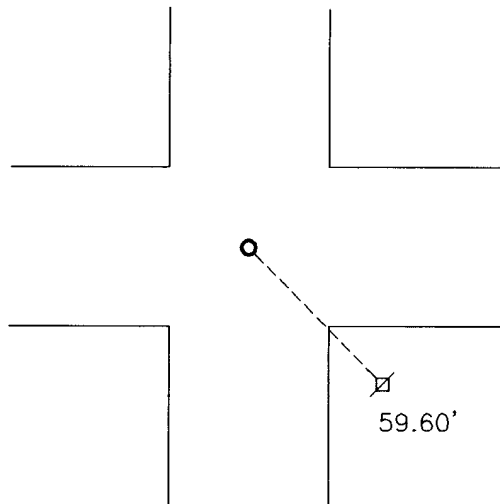

Minnesota State Plane Coordinate
System Yellow Medicine County Datum
NAD83 (1996)

N: 132175.550
E: 603305.178

Nail and survey marker in utility pole SE 59.60'

Statement of evidence relative to this corner location is on back of page.

I hereby certify that this document and the data contained herein was prepared by me or under my direct supervision.

SIGNATURE

1/6/11
DATE

Registration No. 43844

Land Surveyor, Professional Engineer
 County Surveyor, County Engineer

OFFICE OF THE COUNTY RECORDER

County of _____

I hereby certify that this document was filed in the Co. Recorders office at _____ .M on the _____ day of _____ A.D. 20 _____

County Recorder _____

By _____, Deputy

DOCUMENT NO. _____

Statement of Evidence

In 1858, W. J. Neeley did the original survey of the north line of the township.

On May 14, 2010, Bueltel-Moseng Land Surveying found a county bridge spike. We removed the spike and replaced it with a 5/8" iron with seal #43844.

Doc# 252033 Fee: \$0.00 2 Pages

Office of County Recorder
Yellow Medicine County, Minnesota
I hereby certify that the within instrument
was filed on January 13, 2011 at 8:05 AM

Kay Zempel, Yellow Medicine County Recorder

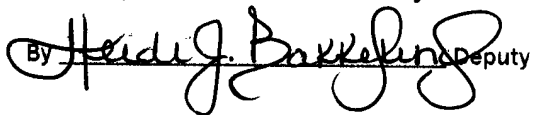
By  Deputy

n/c

Bueltel-Moseng Land Surveying
P.O. Box 32
Marshall, MN 56258