

CERTIFICATE OF LOCATION OF GOVERNMENT CORNER

NORTH QUARTER Corner of Section 35, Township 114, Range 41, 5TH P.M.

STATE OF MINNESOTA, County of YELLOW MEDICINE

At the corner location shown on the sketch:

- On _____ found a _____
DATE
- left monument as found, lowered monument, removed monument (explain)
- On 03-22-2010 placed a SURVEY SPIKE WITH SEAL #43844
DATE

SKETCH OF REFERENCE TIES

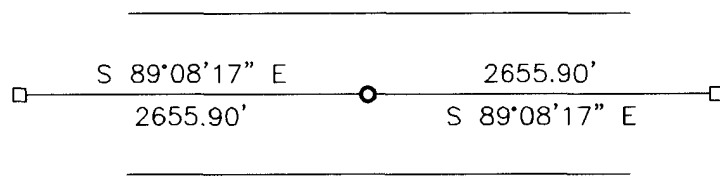

Minnesota State Plane Coordinate
System Yellow Medicine County Datum
NAD83 (1996)

N: 137667.967
E: 537068.885

Statement of evidence relative to this corner location is on back of page.

I hereby certify that this document and the data contained herein was prepared by me or under my direct supervision.

David Ben... 1/6/11
SIGNATURE DATE

Registration No. 43844

- Land Surveyor, Professional Engineer
- County Surveyor, County Engineer

OFFICE OF THE COUNTY RECORDER
County of _____

I hereby certify that this document was filed in the Co. Recorders office at _____ .M on the _____ day of _____ A.D. 20 _____

County Recorder _____
By _____, Deputy

DOCUMENT NO. _____

Statement of Evidence

In 1861, David Watson did the original subdivision of the township.

On March 22, 2010, Bueltel-Moseng Land Surveying set a survey spike with seal #43844 midway and on line between the section corners.

Doc# 252041 Fee: \$0.00 2 Pages

Office of County Recorder

Yellow Medicine County, Minnesota

I hereby certify that the within instrument was filed on January 13, 2011 at 8:45 AM

Kay Zempel, Yellow Medicine County Recorder

By  Deputy

N/L

Bueltel-Moseng Land Surveying
P.O. Box 32
Marshall, MN 56258