

CERTIFICATE OF LOCATION OF GOVERNMENT CORNER

SOUTH QUARTER Corner of Section 34, Township 114, Range 42, 5TH P.M.

STATE OF MINNESOTA, County of YELLOW MEDICINE

At the corner location shown on the sketch:

On 08-02-2010 found a 1" SQUARE IRON
DATE

left monument as found, lowered monument, removed monument (explain)

On 08-02-2010 placed a CAST IRON MONUMENT
DATE

SKETCH OF REFERENCE TIES

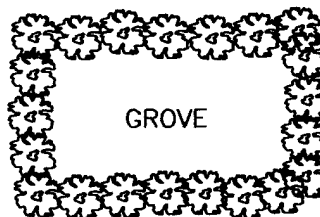
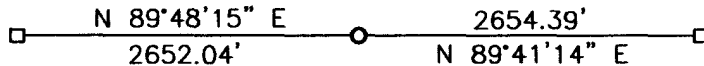

Minnesota State Plane Coordinate
System Yellow Medicine County Datum
NAD83 (1996)

N: 132474.494
E: 499949.198

Statement of evidence relative to this corner location is on back of page.

I hereby certify that this document and the data contained herein was prepared by me or under my direct supervision.

SIGNATURE 1/10/11
DATE

Registration No. 43844

Land Surveyor, Professional Engineer
 County Surveyor, County Engineer

OFFICE OF THE COUNTY RECORDER
County of _____

I hereby certify that this document was filed in the Co. Recorders office at _____ .M on the _____ day of _____ A.D. 20 _____

County Recorder _____

By _____, Deputy

DOCUMENT NO. _____

Statement of Evidence

In 1858, W. J. Neely did the original survey of the south line of the township.

On November 8, 1900, John Norgaard established the corner, but he did not set a monument.

On September 24 and 25, 1914, the Lyon County Surveyor set a iron pin at the corner.

On August 2, 2010, Bueltel-Moseng Land Surveying found a 1" square iron at the corner 2'± below the road surface. We set a cast iron monument over the iron.

Doc# 252045 Fee: \$0.00 2 Pages

Office of County Recorder

Yellow Medicine County, Minnesota

I hereby certify that the within instrument
was filed on January 13, 2011 at 9:05 AM

Kay Zempel, Yellow Medicine County Recorder

By  Deputy

N/C

Bueltel-Moseng Land Surveying
P.O. Box 32
Marshall, MN 56258