

CERTIFICATE OF LOCATION OF GOVERNMENT CORNER

NORTHEAST Corner of Section 35, Township 114, Range 42, 5TH P.M.

STATE OF MINNESOTA, County of YELLOW MEDICINE

At the corner location shown on the sketch:

On 11-29-2010 found a COUNTY SPIKE
DATE

left monument as found, lowered monument, removed monument (explain)

On 11-29-2010 placed a 5/8" IRON WITH SEAL #43844
DATE

SKETCH OF REFERENCE TIES

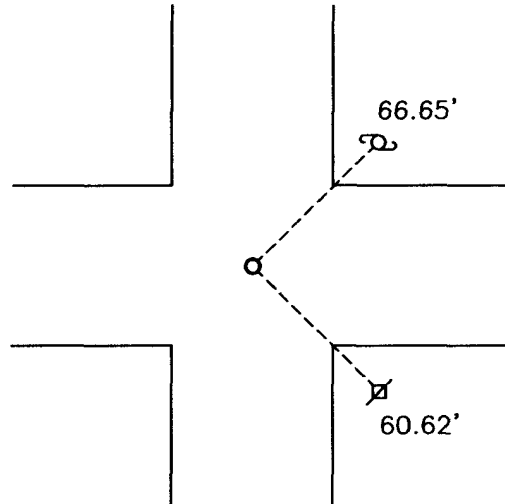

Minnesota State Plane Coordinate
System Yellow Medicine County Datum
NAD83 (1996)

N: 137791.452
E: 507901.118

Top center of water valve NE 66.65'
Nail and seal in utility pole SE 60.62'

Statement of evidence relative to this corner location is on back of page.

I hereby certify that this document and the data contained herein was prepared by me or under my direct supervision.

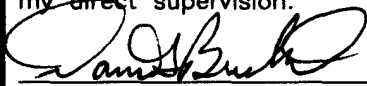
SIGNATURE

12/14/11
DATE

Registration No. 43844

Land Surveyor, Professional Engineer
 County Surveyor, County Engineer

OFFICE OF THE COUNTY RECORDER

County of _____

I hereby certify that this document was filed in the Co. Recorders office at _____ .M on the _____ day of _____ A.D. 20 _____

County Recorder _____

By _____, Deputy

DOCUMENT NO. _____

Statement of Evidence

In 1867, David Watson did the first subdivision of the township.

In 1911, John Norgaard set a stone at the corner.

The Yellow Medicine Highway Department found a yellow capped RLS at the corner.

On November 29, 2010, Bueltel-Moseng Land Surveying found a spike set by the county at the corner. We replaced the spike with a 5/8" iron with seal #43844.

Doc# 254469 Fee: \$0.00 2 Pages

Property & Public Services
Property Records Division
Yellow Medicine County, Minnesota
I hereby certify that the within instrument
was filed on January 23, 2012 at 10:55 AM

Janel Timm, Yellow Medicine County Recorder

By Debra Beard Deputy

N/C
Bueltel-Moseng Land Surveying
PO Box 32
Marshall, MN 56258