

CERTIFICATE OF LOCATION OF GOVERNMENT CORNER

EAST QUARTER Corner of Section 32, Township 115, Range 46, 5TH P.M.

STATE OF MINNESOTA, County of YELLOW MEDICINE

At the corner location shown on the sketch:

On _____ found a _____
DATE

left monument as found, lowered monument, removed monument (explain)

On 7/18/14 placed a survey spike with seal #43844
DATE

SKETCH OF REFERENCE TIES

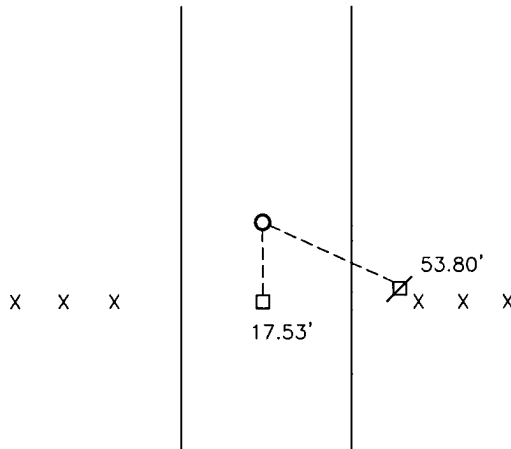

Minnesota State Plane Coordinate
System Yellow Medicine County Datum
NAD83 (1996)

N: 167423.166
E: 364830.654

Nail and survey marker in utility pole SE 53.80'
5/8" iron w/seal #19092 South 17.53'

Statement of evidence relative to this corner location is on back of page.

I hereby certify that this document and the data contained herein was prepared by me or under my direct supervision.

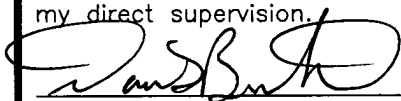
SIGNATURE

1/21/15
DATE

Registration No. 43844

Land Surveyor, Professional Engineer
 County Surveyor, County Engineer

OFFICE OF THE COUNTY RECORDER

County of _____

I hereby certify that this document was filed in the Co. Recorders office at _____ .M on the _____ day of _____ A.D. 20 _____

County Recorder _____

By _____, Deputy

DOCUMENT NO. _____

Statement of Evidence

In 1871, L. Harrington did the original subdivision of the township.

On October 28, 1903, John Norgaard, County Surveyor, found government mound at the corner.

On July 18, 2014, Bueltel-Moseng Land Surveying set a survey spike with seal #43844 midway and on line between section corners. It is 20'± north of fence to the east and west and in centerline of road.

Doc# 261556 Fee: \$0.00 2 Pages

Property & Public Services
Property Records Division
Yellow Medicine County, Minnesota

I hereby certify that the within instrument
was filed on February 23, 2015 at 11:25 AM

Janel Timm, Yellow Medicine County Recorder

By Kelly Kueger Deputy