

# CERTIFICATE OF LOCATION OF GOVERNMENT CORNER

NORTHEAST Corner of Section 26, Township 114, Range 39, 5TH P.M.

STATE OF MINNESOTA, County of YELLOW MEDICINE

At the corner location shown on the sketch:

On \_\_\_\_\_ found a \_\_\_\_\_  
DATE

left monument as found,  lowered monument,  removed monument (explain)

On 4/8/15 placed a 5/8" iron with seal #43844  
DATE

SKETCH OF REFERENCE TIES

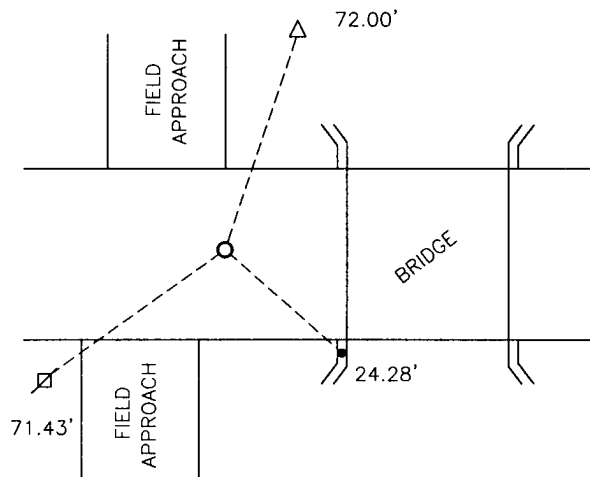

Minnesota State Plane Coordinate  
System Yellow Medicine County Datum  
NAD83 (1996)

N: 142759.980  
E: 603376.581

Nail and seal #11943 in utility pole SW 71.43'  
Nail and survey marker in pedestal guard post NE 72.00'  
Vertical control monument in southwest wing of bridge SE 24.28'

Statement of evidence relative to this corner location is on back of page.

I hereby certify that this document and the data contained herein was prepared by me or under my direct supervision

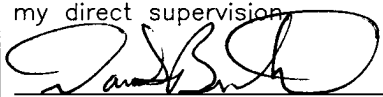
  
SIGNATURE 3/2/16  
DATE

Registration No. 43844

Land Surveyor,  Professional Engineer  
 County Surveyor,  County Engineer

OFFICE OF THE COUNTY RECORDER

County of \_\_\_\_\_

I hereby certify that this document was filed in the Co. Recorders office at \_\_\_\_\_ .M on the \_\_\_\_\_ day of \_\_\_\_\_ A.D. 20 \_\_\_\_\_

County Recorder \_\_\_\_\_

By \_\_\_\_\_, Deputy

DOCUMENT NO. \_\_\_\_\_

## Statement of Evidence

In September, 1864, Chas E. Davis and J.W. Webb Jr. did the original subdivision of the township.

In 1932, John Norgaard, County Surveyor recorded distances to the corner, while doing a survey in Section 23-114-39.

In 1957, Yellow Medicine County Highway Department found a granite monument at the corner.

On September 9, 1992, Moseng Land Surveying dug with a backhoe and did not find the recorded granite monument. Found a spike with flagging and held to as the corner.

On April 8, 2015, Bueltel-Moseng Land Surveying set a 5/8" iron with seal #43844 by projecting line from the northwest corner of Section 26-114-39, through the north quarter of Section 26-114-39, and using the length of the total mile, recorded by Lyle Moseng during the 1992 survey.

**Doc# 263816 Fee: \$0.00 2 Pages**

Property & Public Services  
Property Records Division  
Yellow Medicine County, Minnesota  
I hereby certify that the within instrument  
was filed on March 28, 2016 at 11:45 AM

Janel Timm, Yellow Medicine County Recorder

By Debra Blood Deputy