

# CERTIFICATE OF LOCATION OF GOVERNMENT CORNER

SOUTHEAST Corner of Section 31, Township 113, Range 39, 5TH P.M.

STATE OF MINNESOTA, County of YELLOW MEDICINE

At the corner location shown on the sketch:

On \_\_\_\_\_ found a \_\_\_\_\_  
DATE

left monument as found,  lowered monument,  removed monument (explain)

On 4/21/16 placed a survey spike with seal #50343  
DATE

SKETCH OF REFERENCE TIES

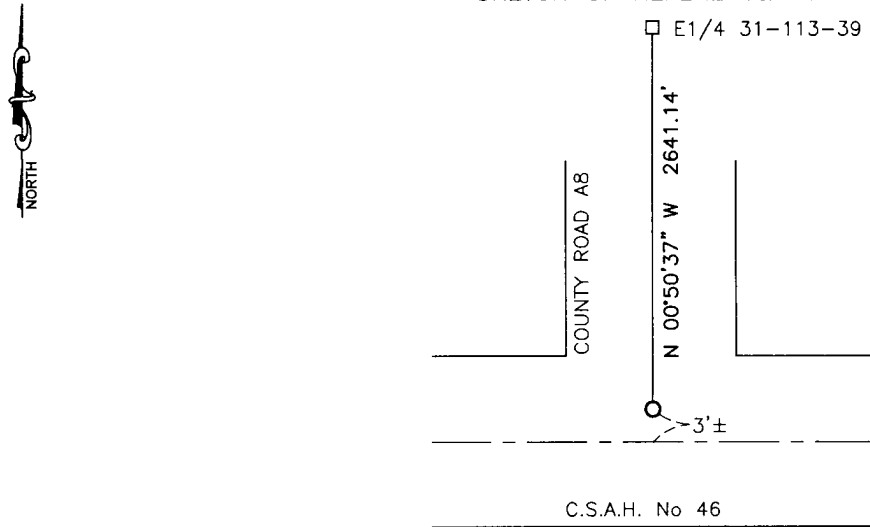

Minnesota State Plane Coordinate  
System Yellow Medicine County Datum  
NAD83 (1996)

N: 100471.447  
E: 582398.069

Statement of evidence relative to this corner location is on back of page.

I hereby certify that this document and the data contained herein was prepared by me or under my direct supervision.

[Signature] \_\_\_\_\_ 1/26/17  
SIGNATURE DATE

Registration No. 50343

- Land Surveyor,  Professional Engineer
- County Surveyor,  County Engineer

**Doc# 265766 Fee: \$0.00 2 Pages**

Property & Public Services  
Property Records Division  
Yellow Medicine County, Minnesota  
I hereby certify that the within instrument  
was filed on February 16, 2017 at 11:15 AM

Janel Timm, Yellow Medicine County Recorder

By [Signature] Deputy

## Statement of Evidence

In October, 1858, W.J. Neeley did the original survey of the south line of the township.

In October, 1913, John Norgaard, County Surveyor, found a jasper stone monument at the corner..

On October 2000, Roy Marihart found a monument at the corner.

On April 21, 2016, Bueltel-Moseng Land Surveying set a survey spike with seal #50343 by using Yellow Medicine County Highway Department coordinates. It fits the survey from 2000. It is in centerline of the road to the north and at the point of intersection of road to the east-west.