

CERTIFICATE OF LOCATION OF GOVERNMENT CORNER

NORTHEAST Corner of Section 16, Township 114, Range 41, 5TH P.M.

STATE OF MINNESOTA, County of YELLOW MEDICINE

At the corner location shown on the sketch:

- On _____ found a _____
DATE
- left monument as found, lowered monument, removed monument (explain)
- On 2/22/17 placed a 5/8" iron with seal #50343
DATE

SKETCH OF REFERENCE TIES

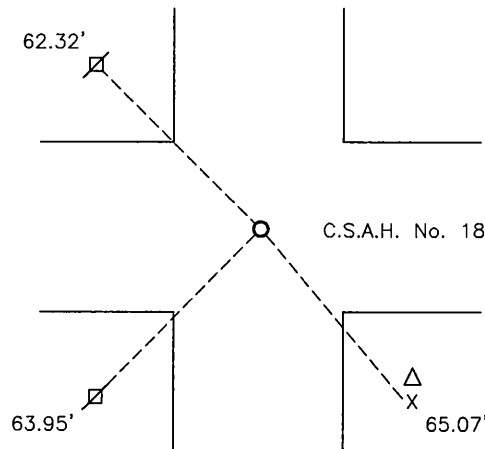

Minnesota State Plane Coordinate
System Yellow Medicine County Datum
NAD83 (1996)

N: 153684.953
E: 529139.535

Nail and bottle cap in utility pole NW 62.32'
Nail and bottle cap in utility pole SW 63.95'
Nail and bottle cap in pedestal post SE 65.07'

Statement of evidence relative to this corner location is on back of page.

I hereby certify that this document and the data contained herein was prepared by me or under my direct supervision.

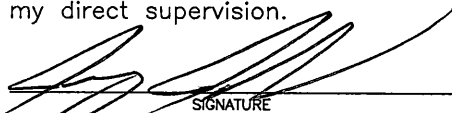
SIGNATURE _____ DATE 1/25/18

Registration No. 50343

- Land Surveyor, Professional Engineer
- County Surveyor, County Engineer

Doc# 268102 Fee: \$0.00 2 Pages

Property & Public Services
Property Records Division
Yellow Medicine County, Minnesota
I hereby certify that the within instrument
was filed on March 28, 2018 at 10:55 AM

Janel Timm, Yellow Medicine County Recorder

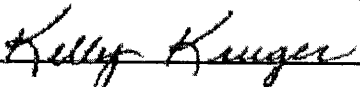
By  Deputy

Statement of Evidence

In 1867, David Watson did the original subdivision of the township.

On May 16, 1891, Jonah Peterman, County Surveyor, recorded a stone at the corner.

(No date), the Yellow Medicine County Highway Department found an iron at the corner.

On February 22, 2017, Bueltel-Moseng Land Surveying set a 5/8" iron with seal #50343 over found iron by using GPS coordinates from the highway department.